

5

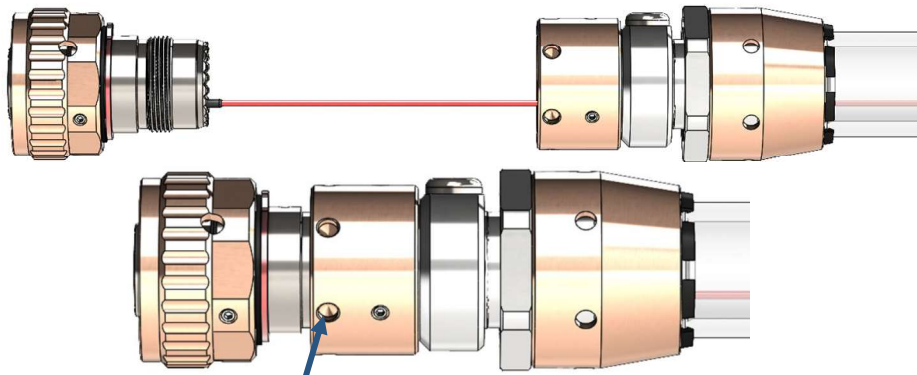

RECOMMENDED TORQUE

$\approx 10 \pm 0.5$ ft-lbs



Contact Us: Glenair, Inc.
1211 Air Way
Glendale, CA 91201

phone: (818)247-6000
email: sales@glenair.com
web: www.glenair.com

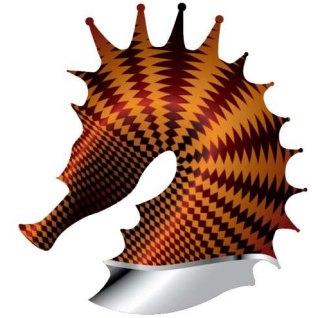

SeaKing

Assembly Instruction Card

Pressure Balanced Oil-Filled (PBOF) Cable Connector
Plug (CCP) Assembly

Refer to
709-099: SeaKing Contact Patterns
709-123: SeaKing PBOF Backshell
Dimensions and Information

Scan QR code for detailed, online
installation instructions and video.



6

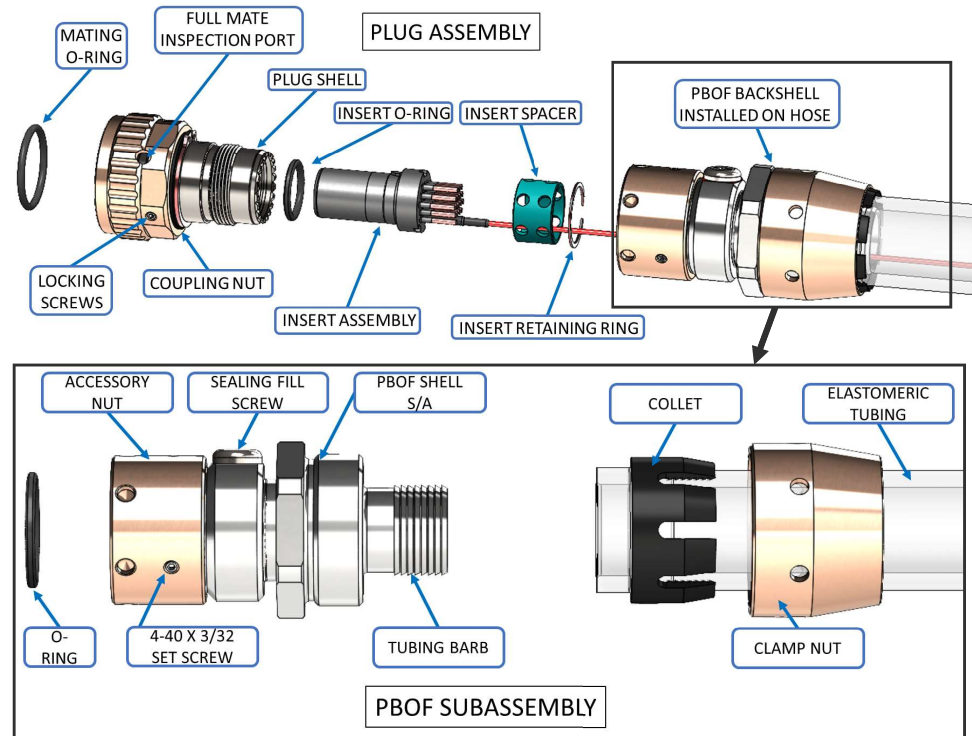
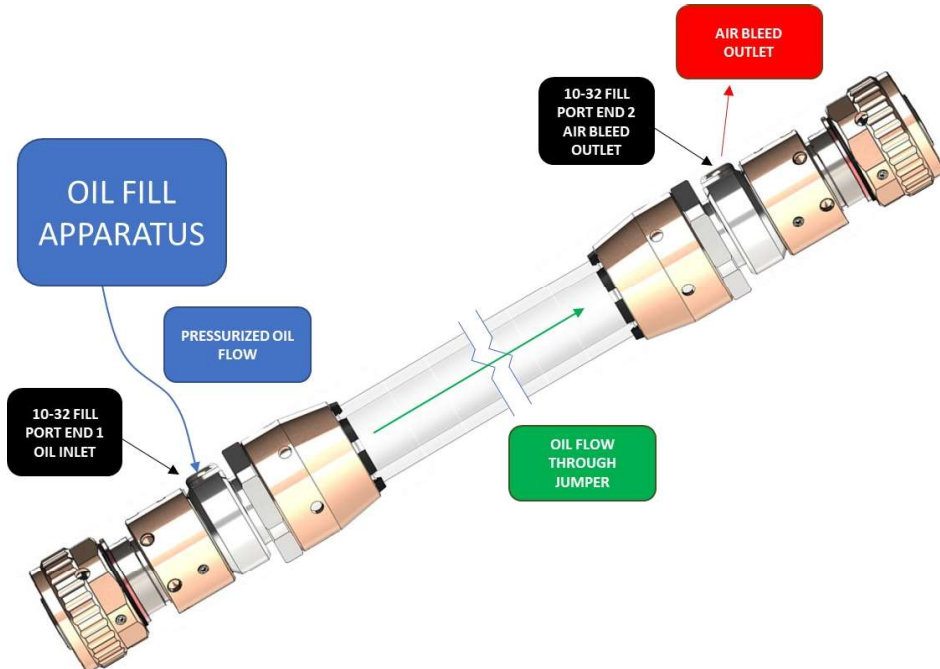

1

INSPECT AND CLEAN ALL SURFACES AND LUBRICATE ALL O-RINGS AND BOOTS PRIOR TO INSTALLATION. DO NOT LUBRICATE ELASTOMERIC HOSE OR HOSE BARB.

- Caution
- Inspection
- Verification
- PPE Required

WARNING: DO NOT SCRATCH O-RING SEALING SURFACES

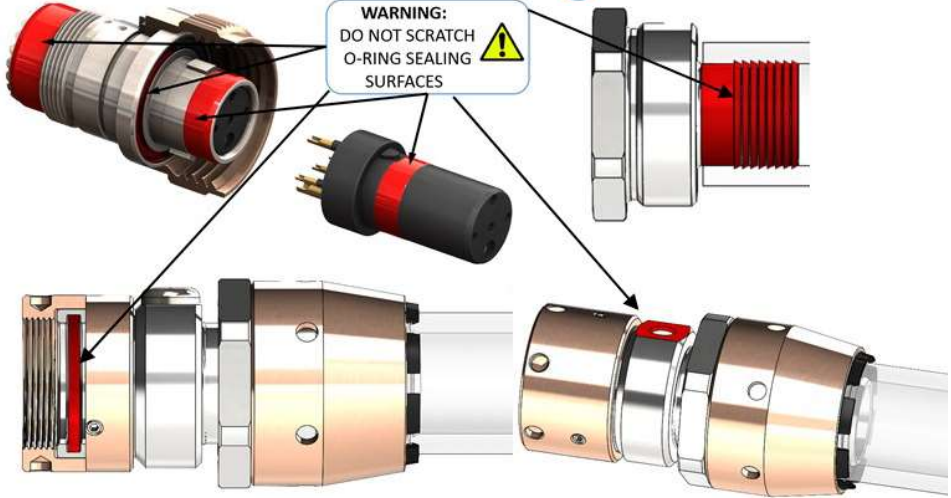

3

GLENAIR 709-078-K

RECOMMENDED TORQUE

10 ± 0.5 ft-lbs

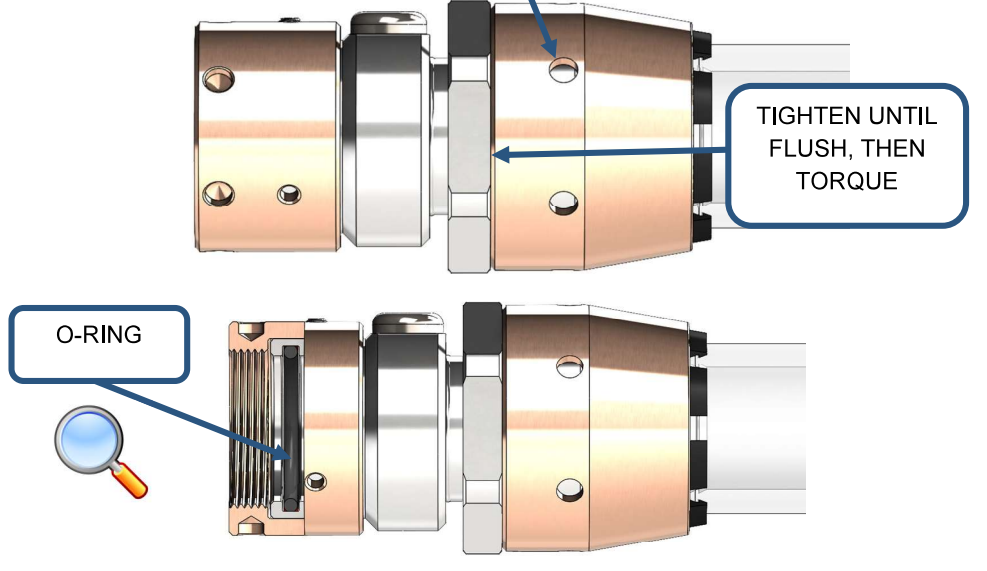

2

SHELL SIZE	RECOMMENDED HOSE
E	990-70136-4
G	990-70136-5
K	990-70136-6
L	990-70136-7
M	990-70136-7
O	990-70136-8
P	990-70136-8
Q	990-70136-9
R	990-70136-10

DO NOT LUBRICATE ELASTOMERIC HOSE OR HOSE BARB.

4

BEFORE SOLDERING WIRES

LUBRICATE WIRE, CONTACTS, AND REAR BOSSES WITH DC-4

WIRE AWG	LENGTH OF INSULATION TO STRIP
22	.18 ± .01
20	.20 ± .01
16	.22 ± .01
12	.36 ± .01
8	.55 ± .01

ENSURE SHIM (980-70031) IS NOT INSTALLED