

SuperNine® Glass seal hermetic

MIL-DTL-38999 Series III Type

233-265 Wall & weld mnt receptacle with removable crimp contacts



SUPERNINE GLASS-TO-METAL SEAL HERMETIC CONNECTORS

MIL-DTL-38999 Series III Type SuperNine hermetic receptacles withstand the pressure differentials between internal and external environments without compromising their integrity. Removable crimp contacts provide quick and easy connection to the connector. Hermetic sealing of 1×10^{-7} atm cc/s ensures protection against moisture and contaminants, making them ideal for aerospace and defense applications to guarantee reliability in extreme environments, ensuring optimal performance in critical applications. Available in 2 shell styles with accessory threads or integral banding porch options. Rated for temperatures from -55°C to $+125^{\circ}\text{C}$, they meet stringent military specifications, providing exceptional resistance to shock (up to 100g), vibration (up to 20g), and corrosion (salt spray per ASTM B117).

PERFORMANCE SPECIFICATIONS

- Hermeticity: $<1 \times 10^{-7}$ sccHe/sec @ one ATM differential. Not for use in liquid atmosphere.
- I.R.: 5 gigaohms min @ 500 VDC
- See D.W.V. Voltage Rating Table

MATERIAL/FINISH:

- Shell, jam nut: see Part No. Details table
- Contacts, pin: alloy 52/gold plated
- Insulator, hermetic: vitreous glass
- Socket contact: copper alloy/gold plated
- Insulator hermetic: fused vitreous glass
- Insulators: high grade rigid dielectric
- Seals: fluorosilicone

CRIMP CONTACTS:

(supplied loose with connector)

- #12 850-003-12-359
- #16 850-003-16-358
- #20 850-003-20-357
- #22D 850-003-22-354

Part Number Development								
Sample Part Number	233-265			-H2	Z1	17-26	P	N
Series / Basic Part No.	Series 23 SuperNine Hermetic							
Connector Style	H2 = Wall Mount with Accessory Threads BH2 = Wall Mount with Integral Banding Porch H8 = Weld Mount with Accessory Threads BH8 = Weld Mount with Banding Porch							
Finish*	Z1 = CRES, Passivated ZL = CRES, Nickel Finish							
Shell Size/Insert Arrangement*	Per MIL-DTL-38999/MIL-STD-1560 See page A-8 for Insert Arrangements							
Contact Style	P = Pin S = Socket							
Polarization	A, B, C, D, E, N = Normal							

Modification codes may be added directly to the end of any valid part number

Polarization Table														
Shell Sizes: 9					Shell Sizes: 11, 13, 15				Shell Sizes: 17, 19, 21, 23, 25					
Pos	A°	B°	C°	D°	Pos	A°	B°	C°	D°	Pos	A°	B°	C°	D°
N	105	140	215	265	N	95	141	208	236	N	80	142	196	293
A	102	132	248	320	A	113	156	182	292	A	135	170	200	310
B	80	118	230	312	B	90	145	195	252	B	49	169	200	244
C	35	140	205	275	C	53	156	220	255	C	66	140	200	257
D	64	155	234	304	D	119	146	176	298	D	62	145	180	280
E	91	131	197	240	E	51	141	184	242	E	79	153	197	272

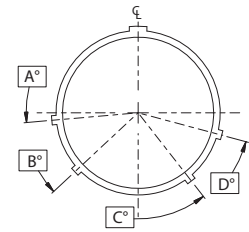

FACE VIEW - RECEPTACLE

DWV Voltage Levels At Sea Level			
Service Rating	Voltage AC RMS 60hz	Service Rating	Voltage AC RMS 60hz
M	1300 VAC	II	2300 VAC
I	1800 VAC	N	1000 VAC

Table I: Insert Arrangements

Shell Size	Layout	No. of Pins			
		22D	20	16	12
8	-35	6			
8	-98		3		
10	-5		5		
10	-98		6		
10	-99		7		
10	-35	13			
10	-2			2	
12	-4			4	
12	-8		8		
12	-98		10		
12	-35	22			
14	-5			5	
14	-15		14	1	
14	-18		18		
14	-19		19		
14	-35	37			
14	-97		8	4	
16	-6				6

Table I: Insert Arrangements

Shell Size	Layout	No. of Pins			
		22D	20	16	12
16	-8			8	
16	-26		26		
16	-35	55			
16	-99		21	2	
18	-11			11	
18	-28		26	2	
18	-30		29	1	
18	-32		32		
18	-35	66			
18	-45	67			
20	-11				11
20	-16			16	
20	-24		24		
20	-25		25		
20	-27		27		
20	-29		19	4	4
20	-35	79			
20	-39		37	2	

Table I: Insert Arrangements

Shell Size	Layout	No. of Pins			
		22D	20	16	12
20	-41			41	
22	-21				21
22	-32			32	
22	-34			34	
22	-35	100			
22	-36			36	
22	-53			53	
22	-55			55	
22	-97				16
22	-99				11
24	-4		48	8	
24	-19				19
24	-24				12
24	-24				12
24	-29				29
24	-35	128			
24	-43		23	20	
24	-61		61		

MIL-DTL-38999 Series III Type

233-265 Wall & weld mnt receptacle with removable crimp contacts

233-265-H2 AND BH2 BOX MOUNT RECEPTACLE

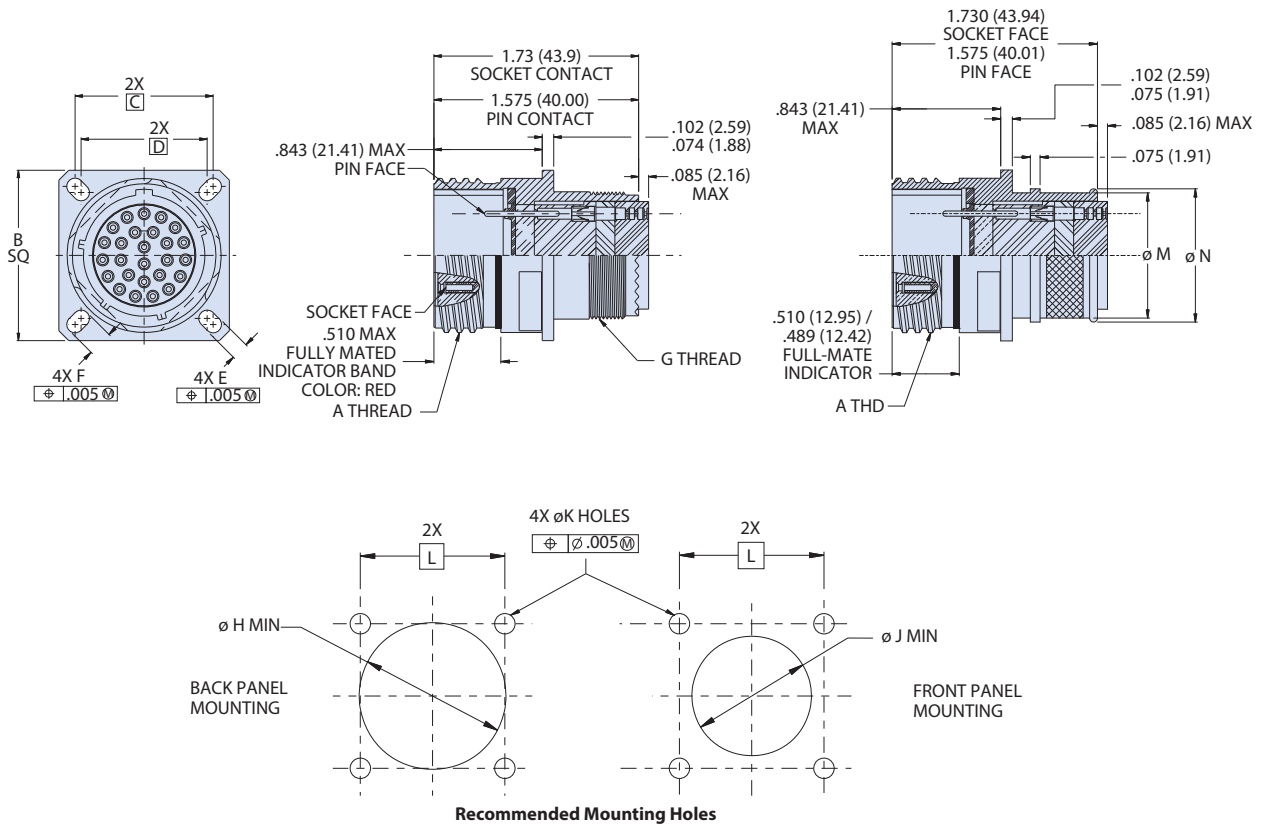

Recommended Mounting Holes

Dimensions														
Shell Size Code	Shell Size	A Thread	B Sq	C Bsc	D Bsc	E	F	G Thread	ØH Min	ØJ Min	ØK Holes	L Bsc	Øm	Øn
A	9	.6250-.1P-.3L-TS-2A	.949 (24.10) .925 (23.50)	.719 (18.26)	.594 (15.09)	.136 (3.45) .120 (3.05)	.224 (5.69) .208 (5.28)	M12 X 1.0-6g .100R	.656 (16.66)	.516 (13.11)	.133 (3.38) .123 (3.12)	.719 (18.26)	.475 (12.07)	.538 (13.67)
B	11	.7500-.1P-.3L-TS-2A	1.043 (26.49) 1.019 (25.88)	.812 (20.62)	.719 (18.26)		.202 (5.13)	M15 X 1.0-6g .100R	.796 (20.22)	.625 (15.88)		.812 (20.62)	.600 (15.24)	.662 (16.81)
C	13	.8750-.1P-.3L-TS-2A	1.138 (28.91) 1.114 (28.30)	.906 (23.01)	.812 (20.62)		.186 (4.72)	M18 X 1.0-6g .100R	.922 (23.42)	.750 (19.05)		.906 (23.01)	.700 (17.78)	.762 (19.35)
D	15	1.0000-.1P-.3L-TS-2A	1.232 (31.29) 1.208 (30.68)	.969 (24.61)	.906 (23.01)		.181 (4.60) .165 (4.19)	M22 X 1.0-6g .100R	1.047 (26.59)	.906 (23.01)		.969 (24.61)	.835 (21.21)	.898 (22.81)
E	17	1.1875-.1P-.3L-TS-2A	1.323 (33.60) 1.299 (32.99)	1.062 (26.97)	.969 (24.61)		.202 (5.13) .186 (4.72)	M25 X 1.0-6g .100R	1.219 (30.96)	1.016 (25.81)		1.062 (26.97)	.960 (24.38)	1.022 (25.96)
F	19	1.2500-.1P-.3L-TS-2A	1.449 (36.80) 1.425 (36.20)	1.156 (29.36)	1.062 (26.97)			M28 X 1.0-6g .100R	1.297 (32.94)	1.141 (28.98)		1.156 (29.36)	1.062 (26.97)	1.125 (28.58)
G	21	1.3750-.1P-.3L-TS-2A	1.575 (40.00) 1.551 (39.40)	1.250 (31.75)	1.156 (29.36)			M31 X 1.0-6g .100R	1.422 (36.12)	1.266 (32.16)		1.250 (31.75)	1.188 (30.18)	1.250 (31.75)
H	23	1.5000-.1P-.3L-TS-2A	1.701 (43.21) 1.677 (42.60)	1.375 (34.92)	1.250 (31.75)	.162 (4.11) .250 (6.35)	M34 X 1.0-6g .100R	1.547 (39.29)	1.375 (34.92)	.159 (4.04) .149 (3.78)	1.375 (34.92)	1.275 (32.39)	1.338 (33.99)	
J	25	1.6250-.1P-.3L-TS-2A	1.823 (46.30) 1.799 (45.69)	1.500 (38.10)	1.375 (34.92)	.146 (3.71)	.234 (5.94)	M37 X 1.0-6g .100R	1.672 (42.47)	1.484 (37.69)	.155 (3.94) .145 (3.68)	1.500 (38.10)	1.475 (37.47)	1.538 (39.07)

MIL-DTL-38999 Series III Type

233-265 Wall & weld mnt receptacle with removable crimp contacts

SUPERNINE GLASS-TO-METAL SEAL HERMETIC CONNECTORS

233-265-H8 AND BH8 WELD MOUNT RECEPTACLE

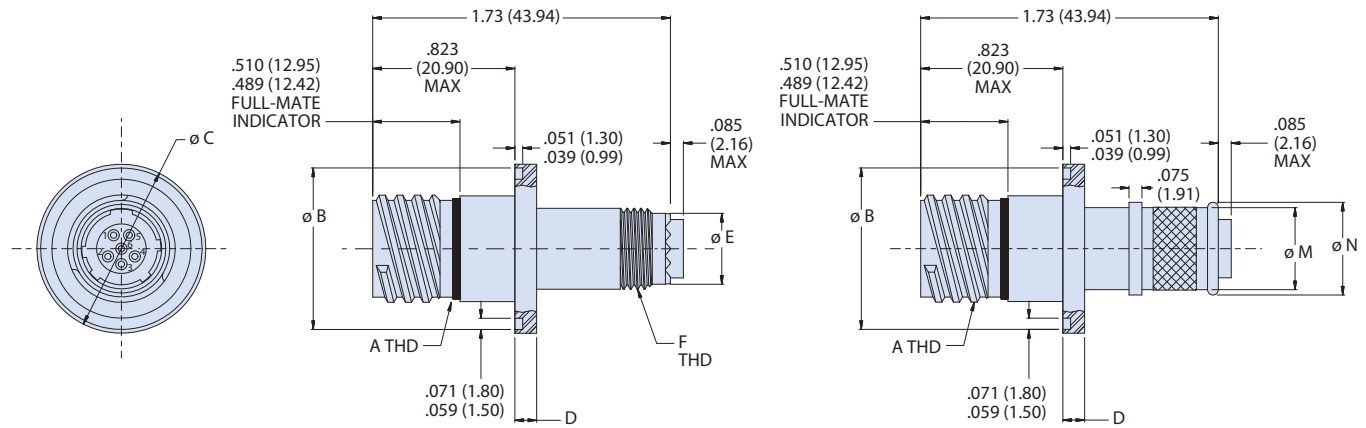

Panel Cutout Dimensions				
SHELL SIZE CODE	SHELL SIZE	Ø G	ØH MIN	DEPTH J ±.005
A	9	.990 (25.15)/.985 (25.02)	.525 (13.34)	.126 (3.20)
B	11	1.112 (28.24)/1.107 (28.12)	.635 (16.14)	.126 (3.20)
C	13	1.238 (31.45)/1.233 (31.32)	.760 (19.30)	.126 (3.20)
D	15	1.364 (34.65)/1.359 (34.52)	.925 (23.50)	.126 (3.20)
E	17	1.451 (36.86)/1.446 (36.73)	1.035 (26.29)	.126 (3.20)
F	19	1.597 (40.56)/1.592 (40.44)	1.155 (29.34)	.126 (3.20)
G	21	1.738 (44.15)/1.733 (44.02)	1.275 (32.39)	.126 (3.20)
H	23	1.894 (48.11)/1.899 (48.23)	1.395 (35.43)	.157 (3.99)
J	25	1.990 (50.55)/1.985 (50.42)	1.525 (38.74)	.157 (3.99)

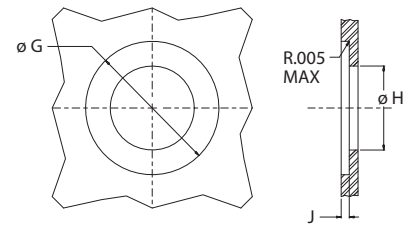

Dimensions								
Shell Size	A Thread	ØB ±.006	ØC ±.006	D	ØE ±.003	F Thd Iso Metric	ØM	ØN
9	.6250-.1P-.3L-TS-2A	.935 (23.75)	.978 (24.84)	.131 (3.33)/.121 (3.07)	.413 (10.49)	M12 X 1.0-6G	.475 (12.07)	.538 (13.67)
11	.7500-.1P-.3L-TS-2A	1.057 (26.85)	1.100 (27.94)	.131 (3.33)/.121 (3.07)	.531 (13.49)	M15 X 1.0-6G	.600 (15.24)	.662 (16.81)
13	.8750-.1P-.3L-TS-2A	1.183 (30.05)	1.226 (31.14)	.131 (3.33)/.121 (3.07)	.650 (16.51)	M18 X 1.0-6G	.700 (17.78)	.762 (19.35)
15	1.0000-.1P-.3L-TS-2A	1.309 (33.25)	1.352 (34.34)	.131 (3.33)/.121 (3.07)	.807 (20.50)	M22 X 1.0-6G	.835 (21.21)	.898 (22.81)
17	1.1875-.1P-.3L-TS-2A	1.396 (35.46)	1.438 (36.53)	.131 (3.33)/.121 (3.07)	.925 (23.50)	M25 X 1.0-6G	.390 (9.91)	1.022 (25.96)
19	1.2500-.1P-.3L-TS-2A	1.541 (39.14)	1.585 (40.26)	.131 (3.33)/.121 (3.07)	1.043 (26.49)	M28 X 1.0-6G	1.062 (26.97)	1.125 (28.58)
21	1.3750-.1P-.3L-TS-2A	1.683 (42.75)	1.726 (43.84)	.131 (3.33)/.121 (3.07)	1.161 (29.49)	M31 X 1.0-6G	1.188 (30.18)	1.250 (31.75)
23	1.5000-.1P-.3L-TS-2A	1.848 (46.94)	1.892 (48.06)	.162 (4.11)/.152 (3.86)	1.279 (32.49)	M34 X 1.0-6G	1.275 (32.39)	1.338 (33.99)
25	1.6250-.1P-.3L-TS-2A	1.935 (49.15)	1.978 (50.24)	.162 (4.11)/.152 (3.86)	1.397 (35.48)	M37 X 1.0-6G	1.475 (37.47)	1.538 (39.07)