

**795-002P**  
**Cable Receptacle, Pin Contacts**

- Size #8 Contacts
- All-Aluminum Body
- Two to Nine Ports
- 18 GHz BMB Coax
- Environmental
- Scoop-Proof

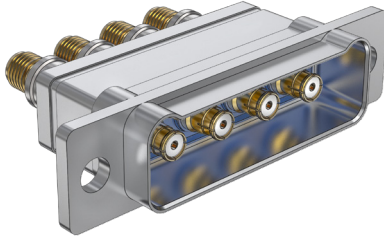

Shown with 50 ohm G-Link<sup>RF</sup> coax contacts (sold separately)

**CONSTRUCTION**

- Shell: aluminum
- Grommet, interfacial seal: fluorosilicone
- Jackscrew, jackpost: SST, passivated
- Retainer clips: copper alloy, unplated

**SPECIFICATIONS**

- Operating temperature: -55 °C to +125 °C
- Shock: EIA-364-27 Condition D
- Vibration: EIA-364-28 Condition V Letter E
- Shell-to-shell resistance: 2.5 milliohms max. with ground spring option

**COAX CONTACTS**

Not included with 795-001 connector. Sold separately.

G-Link<sup>RF</sup>

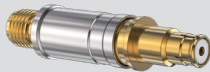

- Part Number **852-157**
  - Integral release sleeve
  - Attach SMA plug directly to contact
- for Flexible Coax Cable**



- See contacts reference page at the beginning of this section for compatible size #8 socket contacts

**Two to nine ports. Size 8 contacts.** 795-002 receptacles have one piece 6061-T6 machined aluminum housings. Fluorosilicone face seal and rear grommet provide environmental protection. Size 8 pin contact cavities have beryllium copper retention clips. Use with BMB coax contacts (P/N 852-071, sold separately) or G-LinkRF BMB/SMA coax contacts (852-157, sold separately).

**PART NUMBER**

		<b>795-002P</b>	<b>8-1RF4</b>	<b>M</b>	<b>E</b>	<b>L</b>
<b>Base P/N</b>	<b>795-002P</b>					
<b>Arrangement No.</b>	See Table 1					
	<b>8-1RF2</b>	2 contacts		<b>8-1RF3</b>	3 contacts	
	<b>8-1RF4</b>	4 contacts		<b>8-1RF5</b>	5 contacts	
	<b>8-2RF5</b>	5 contacts, two row				
	<b>8-2RF7</b>	7 contacts, two row				
<b>8-2RF9</b>	9 contacts, two row					
<b>Finish</b>	<b>M</b>	Electroless Nickel		<b>MT</b>	Nickel-PTFE	
	<b>NF</b>	Olive Drab Cadmium		<b>TZ</b>	Tin-Zinc	
	<b>ZR</b>	Black Zinc-Nickel				
<b>EMI Spring</b>	<b>E</b>	EMI Spring				
	<b>N</b>	No Spring				
<b>Hardware Option</b>	See Table 2					
	<b>L</b>	Jackscrews, Hex Head #8-32, non-removable				
	<b>K</b>	Extended Jackscrews Slot Head #8-32, non-removable				
	<b>N</b>	No Hardware .198 (5.0) diameter thru-holes				
	<b>P</b>	Jackposts #8-32, with nut and lock washer				
	<b>S</b>	Low-Profile Screwlock #8-32, captivated				
<b>T</b>	Extended Screwlock #8-32, captivated					

**TABLE 1 ARRANGEMENT NUMBER**

Optimized for Size #8 BMB Contacts

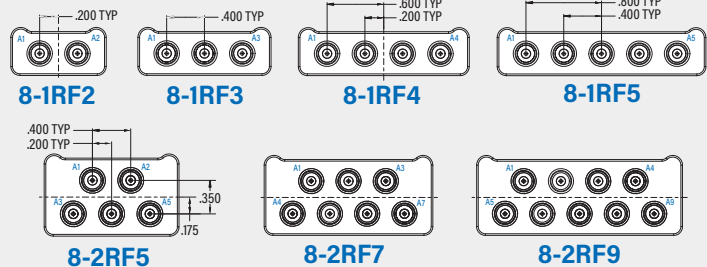

Cable Diameter:  
 .240" Max  
 .304" Max w/ G-Link

Max Frequency:  
 18 GHz

**TABLE 2 HARDWARE OPTION**

<b>L</b>	<b>K</b>	<b>P</b>	<b>N</b>	<b>S</b>	<b>T</b>
<b>Low Profile Allen Head Captivated Jackscrew, #8-32</b>	<b>Extended Profile Knurled Slot Head Captivated Jackscrew, #8-32</b>	<b>Jackpost With Nut And Split Washer, #8-32</b>	<b>No Hardware, Thru Hole</b>	<b>Low Profile Captivated Allen Head Screwlock, #8-32</b>	<b>Extended Captivated Knurled Slot Head Screwlock, #8-32</b>

SERIES 795 MULTI-PORT RF CONNECTORS

**795-002P**  
 Cable Receptacle, Pin Contacts

**795-002P SINGLE ROW**

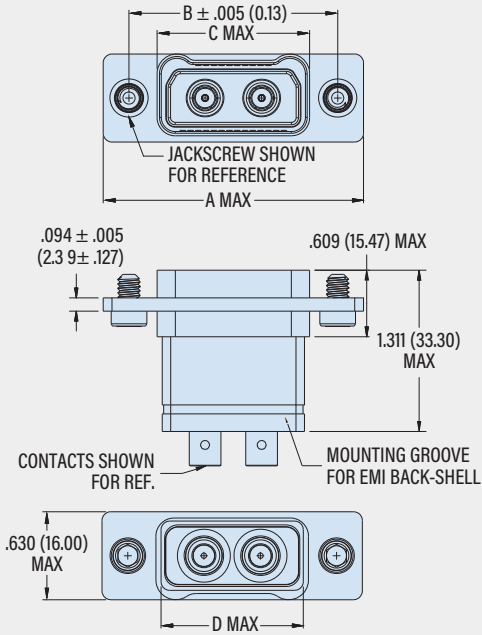

Arrangement Number	B				C Max.	D Max.		
	A Max	$\pm .005 (0.13)$						
	in	mm	in	mm	in	mm		
8-1RF2	1.900	48.26	1.525	38.74	1.090	27.69	1.015	25.78
8-1RF3	2.300	58.42	1.925	48.89	1.490	37.85	1.415	35.94
8-1RF4	2.700	68.58	2.325	59.06	1.890	48.01	1.815	46.10
8-1RF5	3.100	78.74	2.725	69.22	2.290	58.17	2.215	56.26

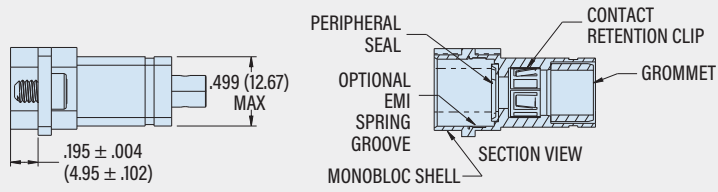

**795-002P DUAL ROW**

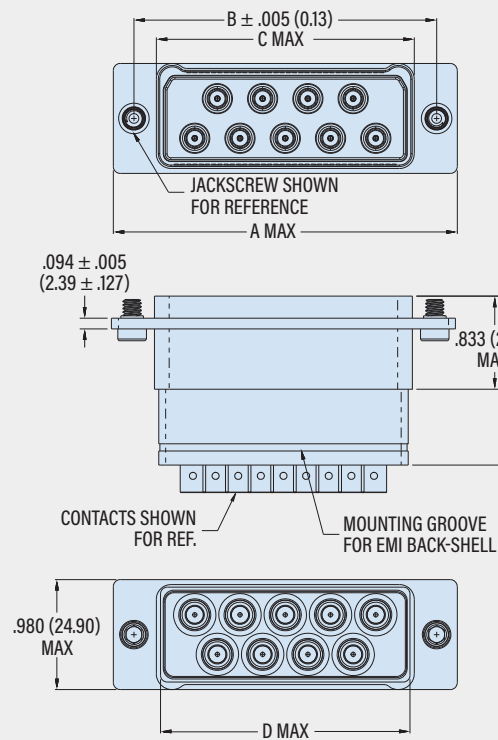

Arrangement Number	B				C Max.	D Max.		
	A Max	$\pm .005 (0.13)$						
	in	mm	in	mm	in	mm		
8-2RF5	2.300	58.42	1.925	48.90	1.490	37.85	1.415	35.94
8-2RF7	2.700	68.58	2.325	59.06	1.890	48.01	1.815	46.10
8-2RF9	3.100	78.74	2.725	69.22	2.290	58.17	2.215	56.26

