

## 979-011 Wire Sealing Grommet

POWERLOAD BACKSHELLS AND ACCESSORIES

### FEATURES

- Material: high temperature silicone rubber
- Grommets are used with PowerLoad connectors 972-101, 972-102, and 972-103, with compression backshells
- Grommets to be bagged and tagged with Glenair and part number, as a minimum

### HOW TO ORDER

|                           |   |            |            |
|---------------------------|---|------------|------------|
| <b>Sample Part Number</b> | <b>979-011</b>                              | <b>-16</b> | <b>-1B</b> |
| <b>Part Series</b>        | Wire Sealing Grommet                        |            |            |
| <b>Insert Arrangement</b> | See Shell Size / Contact Arrangements Table |            |            |
| <b>Wire Diameter Code</b> | See Table I                                 |            |            |

TABLE I: WIRE DIAMETER

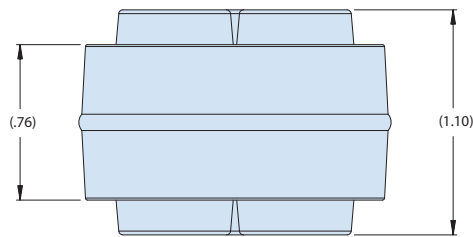

| Wire Gauge | Finished O.D.             |                           |                           |                           |
|------------|---------------------------|---------------------------|---------------------------|---------------------------|
|            | A                         | B                         | C                         | D                         |
| 8 AWG      | Ø .241/.277 (6.12/7.04)   | Ø .213/.251 (5.41/6.38)   | Ø .180/.210 (4.57/5.33)   | N/A                       |
| 4 AWG      | Ø .362/.391 (9.19/9.93)   | Ø .340/.370 (8.64/9.40)   | Ø .312/.350 (7.92/8.89)   | Ø .276/.320 (7.01/8.13)   |
| 2 AWG      | Ø .443/.477 (11.25/12.12) | Ø .405/.442 (10.29/11.23) | Ø .379/.421 (9.63/10.69)  | Ø .344/.378 (8.74/9.60)   |
| 1/0        | Ø .536/.572 (13.61/14.53) | Ø .491/.535 (12.47/13.59) | Ø .450/.501 (11.43/12.73) | Ø .420/.450 (10.67/11.43) |
| 2/0        | Ø .610/.661 (15.49/16.79) | Ø .555/.608 (14.10/15.44) | Ø .524/.576 (13.31/14.63) | Ø .475/.523 (12.07/13.28) |
| 4/0        | Ø .720/.753 (18.29/19.13) | Ø .690/.732 (17.53/18.59) | Ø .641/.691 (16.28/17.55) | Ø .590/.640 (14.99/16.26) |

SHELL SIZE / CONTACT ARRANGEMENTS (FACE OF PIN INSERT)

|  |  |  |                        |  |                                 |
|--|--|--|------------------------|--|---------------------------------|
|  |  |  |                        |  |                                 |
| <b>16-A1</b><br>1X #8                    | <b>16-1</b><br>1X #4                     | <b>20-A1</b><br>1X #2                    | <b>20-1</b><br>1X #1/0 | <b>22-1</b><br>1X #2/0 [consult factory] | <b>22-2</b><br>2X #8            |
|  |  |  |                        |  |                                 |
| <b>22-3</b><br>3X #8                     | <b>24-1</b><br>1X #4/0 [consult factory] | <b>24-2</b><br>2X #4                     | <b>24-4</b><br>4X #8   | <b>28-2</b><br>2X #2                     | <b>28-3</b><br>3X #2            |
|  |  |  |                        |  |                                 |
| <b>28-4</b><br>4X #4                     | <b>28-6</b><br>6X #8                     | <b>32-2</b><br>2X #1/0                   | <b>32-3</b><br>3X #1/0 | <b>32-4</b><br>4X #2                     | <b>32-5</b><br>3X #1/0 & 2X #16 |
|  |  |  |                        |  |                                 |
| <b>36-2</b><br>2X #2/0 [consult factory] | <b>36-4</b><br>4X #1/0                   | <b>40-3</b><br>3X #2/0 [consult factory] | Contact Size Key       |  |                                 |