

SERIES 805 TRIPLE-START ACME THREAD Mighty Mouse Connectors and Cables



Glass-Sealed Hermetic Receptacles with Coax PC Tail Contacts



Series 805 Hermetic Receptacles feature hybrid layouts with coax pin or socket face coax contacts for attachment to flexible or rigid board. Full glass dielectric material. Connectors are 100% tested to meet 1×10^{-7} ccHe/sec at 1 atm helium leak rate. Stainless steel connector shells provide excellent corrosion protection. Available in square flange, solder mount, weld mount, and jam-nut shell styles. Viton® O-rings offer improved resistance to high temperature and harsh chemicals. Contacts are non-removable. Connector is backpotted and parylene compatible.

NOTES

- Material/Finish
 - Shell, jam nut: CRES, passivated or plated see part number development
 - Contacts hermetic: nickel alloy/gold plated
 - Contacts, socket: copper/gold plated
 - Insulator, hermetic: full glass
 - Insulator, coax: rigid dielectric
 - Seals, o-rings: fluorosilicone blend
- Performance Test Criteria:
 - Hermeticity: 1×10^{-7} sccHe/sec at 1 ATM differential
 - I.R.: 5000 megohms min @500VDC
- Connector will mate with all quick-coupling plug connectors having the same shell size, contact arrangement, and opposite contact gender (coax socket.)
- Frequency range:
 - size 16: up to 700 MHz
 - size 12: up to 3 GHz
- See PCB footprints referenced in section B, page 8
- See page M-11 for recommended panel cut-outs

How To Order

Sample Part Number	805-130	-07	Z1	18-5	C	A	-50
Series	805-130 = Hermetic Receptacle						
Shell Style (See Table I)	-02 = Square Flange Mount -03 = Solder Mount Receptacle -07 = Jam Nut Rear Panel Mount						
Shell Material and Finish	Z1 = Stainless Steel / Passivated (RoHS) ZL = Stainless Steel / Nickel Plated						
Shell Size - Insert Arrangement	See Contact Arrangements pages M-8 thru M-32 contact size 16 and 12 only						
Contact Type	C = Coax Pin Face D = Coax Socket Face						
Keyway Position (See Table II)	A = Pos. A B = Pos. B C = Pos. C D = Pos. D E = Pos. E F = Pos. F						
Nominal Impedance	50 = 50 OHM (#12 & 16) 75 = 75 OHM (#12 only)						

Table I: Shell Style

-07 Jam-Nut, Rear Panel Mount	-02 Square Flange	-03 Solder Mount

DWV Rating

Contact Sizes	Test Voltage
23	750 VAC
20 HD	1000 VAC
16, 12, 8	1800 VAC
16 CO-AX**	800 VAC
12 CO-AX**	1000 VAC
**Inner contact to outer contact	

Table II: Keyway Positions

Key Position	Key Rotation	
	A°	B°
A	150°	210°
B	75°	210°
C	95°	230°
D	140°	275°
E	75°	275°
F	95°	210°

GLASS SEAL HERMETIC CONNECTORS

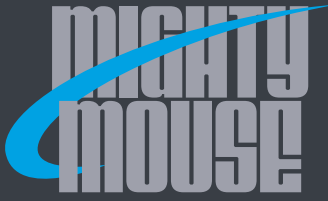

Glass-Sealed Hermetic Receptacles
with PC Tail Coax Contacts

JAM NUT, REAR PANEL MOUNT RECEPTACLE - SHELL STYLE 07

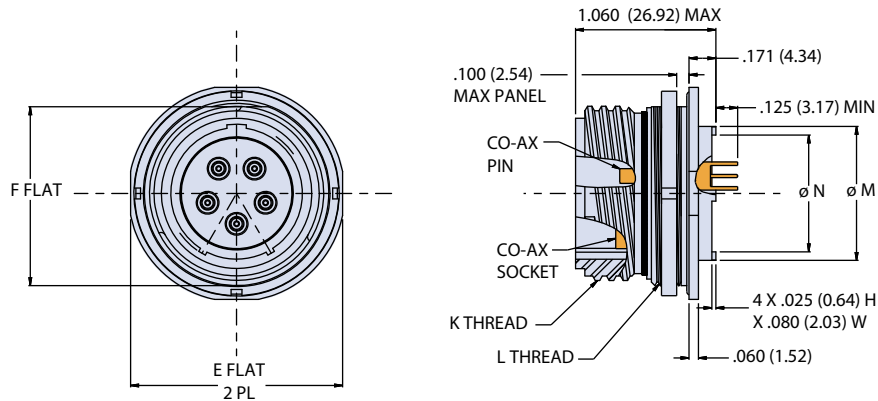

SQUARE FLANGE, FRONT OR REAR PANEL MOUNT, THRU-HOLE RECEPTACLE - SHELL STYLE 02

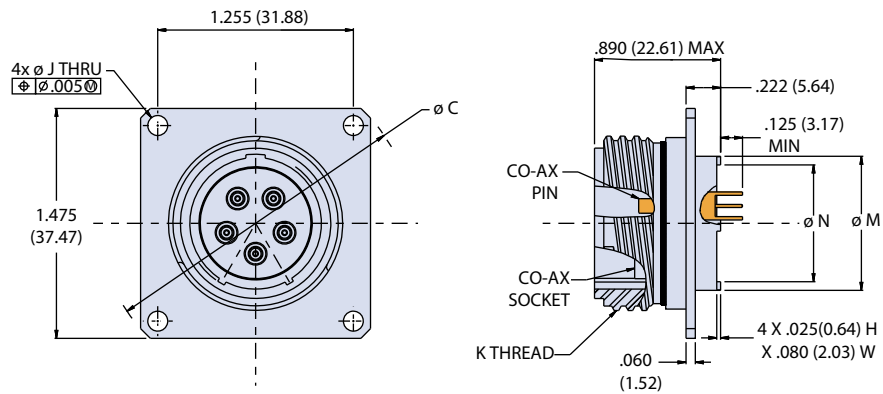

SOLDER MOUNT RECEPTACLE - SHELL STYLE 03

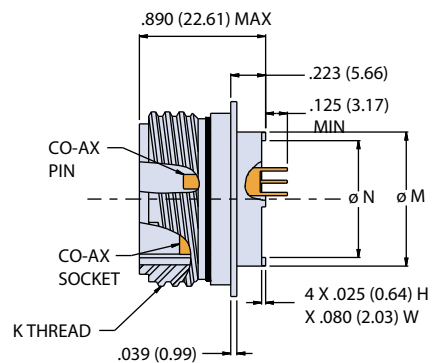

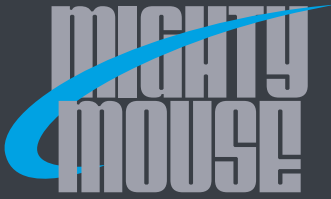

SERIES 805 TRIPLE-START ACME THREAD Mighty Mouse Connectors and Cables



Glass-Sealed Hermetic Receptacles with Co-ax PC Tail Contacts

Dimensions												
Shell Size	A SQ	B BSC	Ø C	Ø D	E FLAT	F FLAT	J HOLES	K THREAD	L THREAD	Ø M	Ø N	Ø P
8	.850 (21.59)	.660 (16.76)	1.150 (29.21)	.760 (19.30)	.730 (18.54)	.535 (13.59)	.096 (2.44) .091 (2.31)	.5000-.1P-.3L-TS	.5625-28 UN-2A	.330 (8.38)	.230 (5.84)	.625 (15.88)
9	.913 (23.19)	.723 (18.36)	1.230 (31.24)	.880 (22.35)	.850 (21.59)	.661 (16.79)		.5625-.1P-.3L-TS	.6875-28 UN-2A	.432 (10.97)	.322 (8.18)	.688 (17.48)
10	.975 (24.76)	.785 (19.94)	1.330 (33.78)	.880 (22.35)	.850 (21.59)	.661 (16.79)		.6250-.1P-.3L-TS	.6875-28 UN-2A	.493 (12.52)	.386 (9.80)	.750 (19.05)
11	1.039 (26.39)	.848 (21.54)	1.410 (35.81)	.955 (24.26)	.925 (23.50)	.721 (18.31)		.6875-.1P-.3L-TS	.7500-28 UN-2A	.553 (14.05)	.442 (11.23)	.812 (20.62)
12	1.099 (27.91)	.909 (23.09)	1.500 (38.10)	1.060 (26.92)	1.035 (26.29)	.784 (19.91)		.7500-.1P-.3L-TS	.8125-28 UN-2A	.620 (15.75)	.513 (13.03)	.875 (22.23)
13	1.163 (29.54)	.973 (24.71)	1.590 (40.39)	1.120 (28.45)	1.090 (27.69)	.843 (21.41)		.8125-.1P-.3L-TS	.8750-28 UN-2A	.661 (16.79)	.554 (14.07)	.938 (23.83)
15	1.288 (32.72)	1.058 (26.87)	1.750 (44.45)	1.203 (30.56)	1.173 (29.79)	.970 (24.64)		.9375-.1P-.3L-TS	1.0000-28 UN-2A	.703 (17.86)	.594 (15.09)	1.062 (26.97)
18	1.475 (37.47)	1.255 (31.88)	2.000 (50.80)	1.389 (35.28)	1.359 (34.52)	1.147 (29.13)	.130 (3.30) .126 (3.20)	1.1250-.1P-.3L-TS	1.1875-28 UN-2A	.863 (21.92)	.750 (19.05)	1.250 (31.75)
19	1.537 (39.04)	1.327 (33.71)	2.094 (53.19)	1.450 (36.83)	1.420 (36.07)	1.221 (31.01)		1.1875-.1P-.3L-TS	1.2500-28 UN-2A	.912 (23.16)	.805 (20.45)	1.312 (33.32)
21	1.663 (42.24)	1.452 (36.88)	2.270 (57.66)	1.580 (40.13)	1.550 (39.37)	1.350 (34.29)		1.3125-.1P-.3L-TS	1.3750-28 UN-2A	1.017 (25.83)	.910 (23.11)	1.438 (36.53)
23	1.787 (45.39)	1.576 (40.03)	2.440 (61.98)	1.705 (43.31)	1.675 (42.55)	1.470 (37.34)		1.4375-.1P-.3L-TS	1.5000-28 UN-2A	1.162 (29.51)	1.050 (26.67)	1.562 (39.67)

PCB FOOTPRINTS

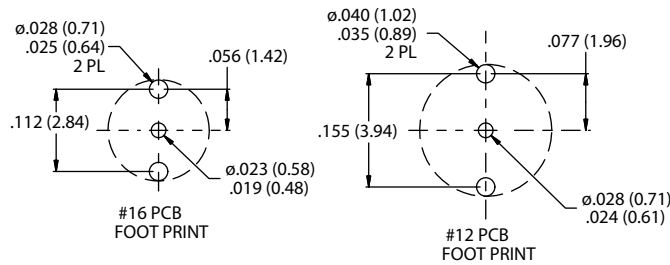

GLASS SEAL HERMETIC CONNECTORS