

# HERMETIC CONNECTORS MIL-DTL-38999 Series III Type

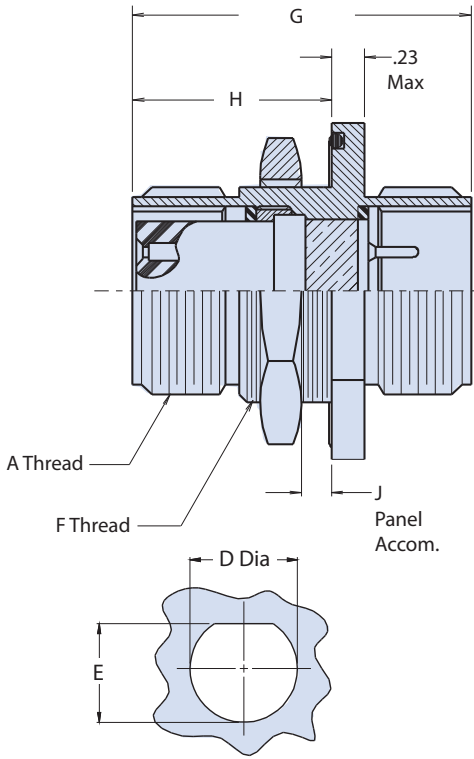

## 233-103-H7 Jam-Nut Mount Bulkhead Feed-Thru



Recommended Panel Cut-Out

HOW TO ORDER	
<b>Sample Part Number</b>	<b>233-103 -H7 Z1 14 -35 P N -02</b>
<b>Basic Part Number</b>	<b>233-103</b> = Jam-Nut Mount Bulkhead Feed-Thru
<b>Shell Style</b>	<b>-H7</b> = Jam-Nut Mount Bulkhead Feed-Thru
<b>Material / Finish</b>	<b>ZL</b> = CRES, Nickel <b>Z1</b> = CRES, Passivated
<b>Shell Size</b>	<b>09, 11, 13, 15, 17, 19, 21, 23, 25</b>
<b>Insert Arrangement</b>	Per MIL-STD-1560
<b>Contact Termination</b>	<b>P</b> = Pin on Plug End, Socket Opposite <b>PP</b> = Pin-Pin <b>S</b> = Socket on Plug End, Pin Opposite <b>SS</b> = Socket-Socket
<b>Alternate Key Position</b>	<b>A, B, C, D, E, (N = Normal)</b>
<b>Panel Accomodation</b>	<b>01</b> = .062 (Min) .125 (Max) <b>02</b> = .062 (Min) .250 (Max) <b>03</b> = .062 (Min) .500 (Max) Consult factory for additional options.

HERMETIC LEAK RATE MOD CODES	
Designator	Required Leak Rate
<b>-585A</b>	1 x 10 <sup>-10</sup> cc Helium per second
<b>-585B</b>	1 x 10 <sup>-9</sup> cc Helium per second
<b>-585C</b>	1 x 10 <sup>-8</sup> cc Helium per second

PANEL ACCOMODATION			
Sym	G Dim, OAL Max	H Dim, Max	J Dim, Panel
<b>-01</b>	1.670 (42.42)	.980 (24.89)	.125 (3.18) .062 (1.57)
<b>-02</b>	1.780 (45.21)	1.090 (27.69)	.250 (6.35) .062 (1.57)
<b>-03</b>	2.030 (51.56)	1.340 (34.04)	.500 (12.7) .062 (1.57)

TABLE II: CONNECTOR DIMENSIONS						
SHELL SIZE	A THREAD 0.1 P-0.3L-TS-2	B DIA	C	D DIA	E DIM	F THREAD METRIC
<b>9</b>	.6250	1.189 (30.20)	1.063 (27.00)	.703 (17.86) .693 (17.60)	.661 (16.79) .655 (16.64)	M17 x 1.0-6g
<b>11</b>	.7500	1.375 (34.93)	1.252 (31.80)	.835 (21.21) .825 (20.96)	.771 (19.58) .761 (19.33)	M20 x 1.0-6g
<b>13</b>	.8750	1.500 (38.10)	1.374 (34.90)	1.020 (25.91) 1.010 (25.65)	.955 (24.26) .945 (24.00)	M25 x 1.0-6g
<b>15</b>	1.0000	1.626 (41.30)	1.500 (38.10)	1.145 (29.03) 1.135 (28.83)	1.085 (27.56) 1.075 (27.30)	M28 x 1.0-6g
<b>17</b>	1.1875	1.752 (44.50)	1.626 (41.30)	1.270 (32.26) 1.260 (32.00)	1.210 (30.73) 1.200 (30.48)	M32 x 1.0-6g
<b>19</b>	1.2500	1.937 (49.20)	1.811 (46.00)	1.395 (35.43) 1.385 (35.18)	1.335 (33.91) 1.325 (33.65)	M35 x 1.0-6g
<b>21</b>	1.3750	2.063 (52.40)	1.937 (49.20)	1.520 (38.61) 1.510 (38.35)	1.460 (37.08) 1.450 (36.83)	M38 x 1.0-6g
<b>23</b>	1.5000	2.189 (55.60)	2.063 (52.40)	1.645 (41.78) 1.635 (41.53)	1.585 (40.26) 1.575 (40.00)	M41 x 1.0-6g
<b>25</b>	1.6250	2.311 (58.70)	2.189 (55.60)	1.770 (44.96) 1.760 (44.70)	1.710 (43.34) 1.700 (43.18)	M44 x 1.0-6g

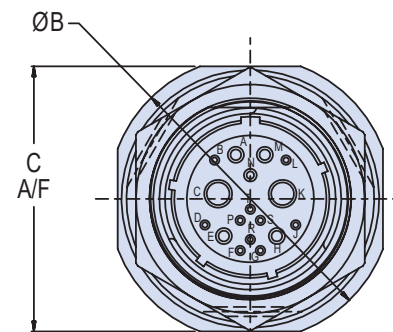

Insert Arrangement per MIL-DTL-38999 Series III MIL-STD-1560

### NOTES

- Power to a given contact on one end will result in power to contact directly opposite, regardless of identification letter.
- Hermeticity = less than 1 x 10<sup>-7</sup> cc/sec at one atmosphere. Not for use in liquid atmosphere.
- Material/finish:
  - Shell, nut – CRES/passivated or CRES/nickel per QQ-N-290.

- Contacts – Gold Plated. Pin: alloy 52; Skt.: copper alloy
- Insulator, hermetic – fused vitreous glass/N.A.
- Insulator, socket – rigid dielectric.
- Seals – fluorosilicone rubber/N.A.
- Metric dimensions (mm) are indicated in parentheses.