

# 189-015 Environmental Banding Backshell for MIL-PRF-28876 fiber optic connectors

NAVSEA / Underwater Fiber Optics



HOW TO ORDER						
Sample Part Number	<b>189-015</b>	<b>NF</b>	<b>13</b>	<b>05</b>	<b>-3</b>	<b>B</b>
Basic Number	Environmental Banding Backshell for M28876 fiber optic connectors					
Material/Finish	See Material and Finish table					
Shell Size	<b>11, 13, 15, 23</b> (See Shell Size and Dimensions table)					
Dash No	See Cable Entry and Shrink Sleeve Dash Number Table					
Increments	Length in 1/2 inch increments. 1.5" minimum. (e.g. <b>-3</b> = 1 1/2")					
Banding	Band 600-052 Supplied (Omit If Not Required)					

### MATERIAL AND PLATING

- Clamp Components: Ryton R 4XT-Black, Ultem 1000-Natural
- Anti-Rotation Device: Torlon 42031-Natural
- O-Ring: Fluorosilicone

### NOTES

- Glenair 600 Series Backshell assembly tools are recommended for assembly and installation.
- Spacer Ring and O-Ring are packaged loose and must be installed with Connector at time of assembly. The spacer is utilized to retain the terminus Insert.
- For Shield termination see Glenair drawing 600-050 & 600-052.
- MIL-I-32053/4 & /5 Shrink sleeve included, packaged loose. Heat shrink /4 sleeve over rear of adapter before /5 shrink sleeve.
- For assembly instructions, see GAP-064

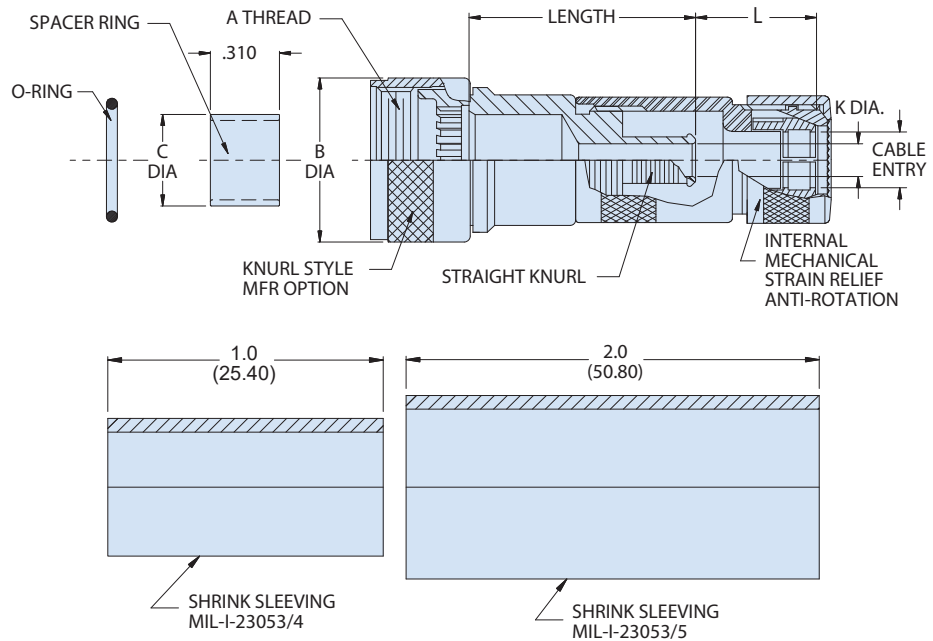

MATERIAL AND FINISH		
Code	Material	Finish Description
<b>B</b>	Aluminum Alloy	Cadmium, Olive Drab
<b>J</b>		Gold Iridite over Cad Plate over Nickel
<b>M</b>		Electroless Nickel
<b>NF</b>		Cad / Olive Drab over Nickel
<b>T</b>		Cad Plate / Bright Dip over Nickel

CABLE ENTRY AND SHRINK SLEEVE DASH NUMBER								
Dash No.	Clamp Size	Cable Dia Max	K Dia ±.005 (0.1)	L Max	MIL-I-23053 Shrink Sleeve	MIL-I-23053 Shrink Sleeve	Cable Entry Dia	
							Minimum	Maximum
<b>05</b>	<b>12</b>	.280 (7.1)	.312 (7.9)	1.11 (28.2)	/4-203-0	/5-107-0	.233 (5.2)	.375 (9.5)
<b>07</b>	<b>16</b>	.395 (10.0)	.438 (11.1)	1.21 (30.7)	/4-204-0	/5-108-0	.358 (8.3)	.500 (12.7)
<b>09</b>	<b>20</b>	.510 (13.0)	.562 (14.3)	1.21 (30.7)	/4-204-0	/5-109-0	.482 (11.5)	.625 (15.9)
<b>11</b>	<b>24</b>	.621 (15.8)	.688 (17.5)	1.21 (30.7)	/4-205-0	/5-106-0	.545 (13.1)	.750 (19.1)
<b>13</b>	<b>28</b>	.736 (18.7)	.812 (20.6)	1.36 (34.5)	/4-205-0	/5-110-0	.670 (16.3)	.875 (22.2)

SHELL SIZE AND DIMENSIONS					
Shell Size	Designator (Ref)	A Thread Class 2B	B Max	C Max	Max Dash Number
<b>11</b>	<b>A</b>	3/4 -20 UNEF	1.028 (26.1)	.410 (10.4)	05
<b>13</b>	<b>B</b>	7/8 -20 UNEF	1.141 (29.0)	.532 (13.5)	05
<b>15</b>	<b>C</b>	1 -20 UNEF	1.263 (32.1)	.710 (18.0)	07
<b>23</b>	<b>F</b>	1-7/16 -18 UNEF	1.703 (43.3)	1.116 (28.3)	13