

MIL-PRF-28876 In-Line Receptacle
 180-040 (05, 15) • M28876 /5

NAVSEA / Underwater Fiber Optics



Receptacle with straight backshell

MATERIAL AND FINISH

- Insert: Al alloy/anodize
- Strain relief hardware: Al alloy/chem film
- Seals: fluorosilicone
- Misc. Hardware: stainless steel/passivate

NOTES

- Termini (not supplied with connector):
 - 181-039 = Terminus, pin, M29504/14 style
 - 181-040 = Terminus, skt, M29504/15 style
 - 181-051 = Terminus, dummy, M29504/03 style
- Backnut retained using thread-locking compound
- Dust covers (not supplied with connectors):
 - 660-072 = plug cover, M28876/10 style
 - 660-073 = recp cover, M28876/15 style
- Dust cover lanyard attachment shall be a fastener type.
- Operating temperature range: -55°C to +125°C.
- See Glenair drawing 187-166 for stainless steel option.

HOW TO ORDER GLENAIR COMMERCIAL 180-040 IN-LINE RECEPTACLES									
Sample Part Number	180-040	NF	05	-15	-08	-1	-1	P	N
Basic Number	Glenair Commercial Equivalent MIL-PRF-28876 Type Fiber Optic In-Line Receptacle Connectors								
Material/Finish	See Material and Finish table								
Connector Type	05, 15. See Connector Type table								
Shell Size	See Shell Size/Insert Arrangements table								
Insert Arrangement	See Shell Size/Insert Arrangements table								
Backshell Designator	-1, -2, -3, See Backshell Designator table (Omit for 05 non-backshell configuration)								
Keying Position	-1 thru -6. See Keying Position table								
Terminus Style	P = Pin S = Socket								
Rear Backnut Option (for 05 non-backshell config.)	Omit = supplied with standard backnut B = supplied with banding backnut (See Banding Backnut table) N = supplied less backnut (to accommodate alternative accessory)								

HOW TO ORDER MIL-DTL28876 IN-LINE RECEPTACLES								
Sample Part Number	M28876/1	C	1	1	P	1	N	T
Basic Number	Military QPL M28876/11 through /14 Fiber Optic In-Line Receptacle Connectors							
Shell Size	See Shell Size/Insert Arrangements table							
Insert Arrangement	See Shell Size/Insert Arrangements table							
Backshell Designator	-1, -2, -3, See Backshell Designator table (Omit for /11 non-backshell configuration)							
Terminus Style	P = Pin S = Socket							
Keying Position	See Keying Position table							
Rear Backnut Option (for /1 non-backshell config.)	N = Not Supplied with Backnut Omit = Supplied with Backnut							
Materials and Finish	T = Tin-Zinc, Bronze-Gold Over Aluminum Alloy Omit = Hard Anodize, Black with PTFE Over Aluminum Alloy							

CONNECTOR TYPE			
Connector Type	Backshell Type	MIL-Spec	Commercial
In-Line Receptacle	None	N/A	180-040 05
	Straight	M28876/5	180-040-15

MIL-PRF-28876 In-Line Receptacle 180-040 (05, 15) • M28876 /5

MATERIAL AND FINISH (COMMERCIAL 180-040 SERIES)		
Code	Material	Finish Description
GB4	Aluminum Alloy	Hard Anodize, Black with PTFE
ME		Electroless Nickel
MT		Nickel-PTFE, Grey
NF		Cadmium, Olive Drab
TZ		Tin-Zinc, Bronze-Gold
ZR		Zinc-Nickel, Black

BACKSHELL DESIGNATOR				
Backshell Designator	Max Allowable Cable Diameter by Shell Size			
	A (11)	B (13)	C (15)	F (23)
1	.250 (6.4)	.285 (7.2)	.500 (12.7)	.866 (22.0)
2	.346 (8.8)	.346 (8.8)	.250 (6.4)	1.000 (25.4)
3	—	.453 (11.5)	.375 (9.5)	.600 (15.2)

Shell size 13, backshell designator 3 connector supplied less boot.

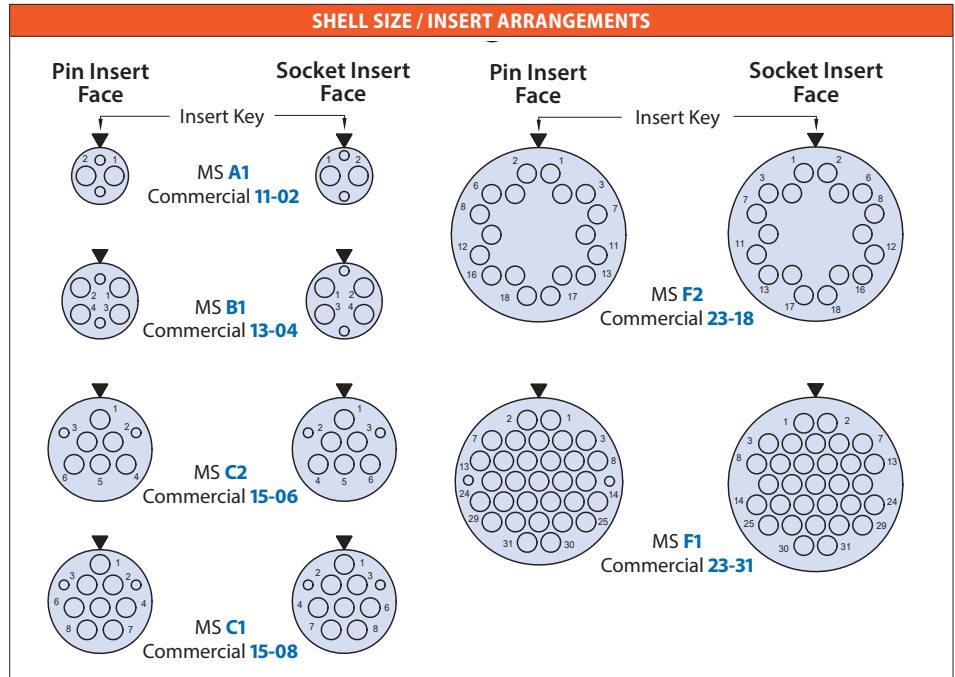

KEYING POSITION					
Shell Size	Key Position	A°	B°	C°	D°
11 and 13	0*	-	-	-	-
	1	95	141	208	236
	2	113	156	182	292
	3	90	145	195	252
	4	53	156	220	255
	5	119	146	176	298
	6	51	141	184	242
15 and 23	0*	-	-	-	-
	1	80	142	196	293
	2	135	170	200	310
	3	49	169	200	244
	4	66	140	200	257
	5	62	145	180	280
	6	79	153	197	272

*0 indicates universal keying arrangement and is available on Series 180-040 plug connector only.

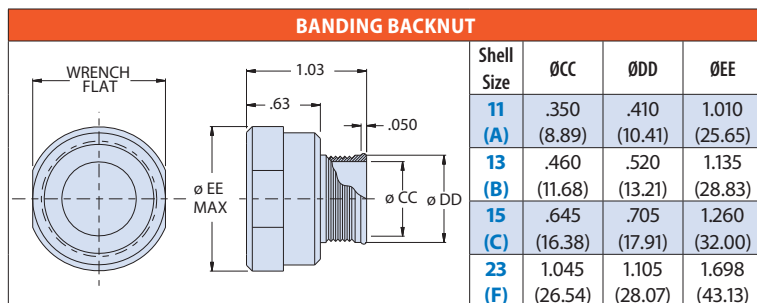

MIL-PRF-28876 In-Line Receptacle
 180-040 (05, 15) • M28876 /5

NAVSEA / Underwater Fiber Optics

IN-LINE RECEPTACLE DIMENSIONS

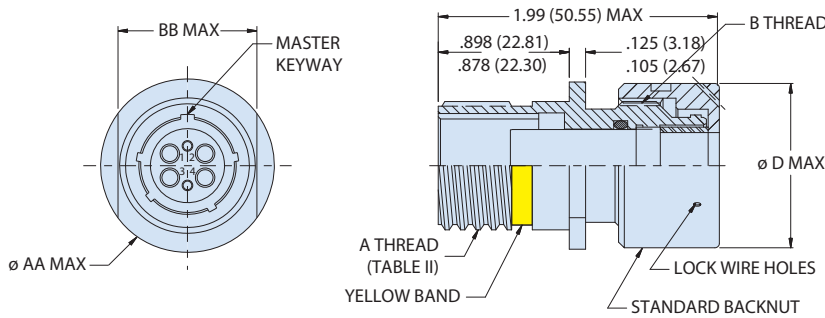

180-040 (05)
 IN-LINE RECEPTACLE WITH STRAIGHT BACKSHELL

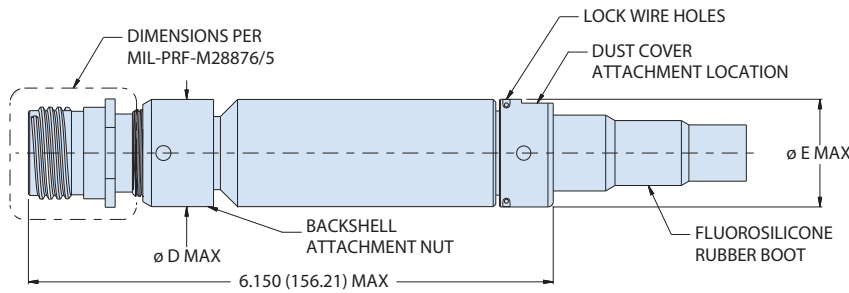

M28876/5 • 180-040 (15)
 IN-LINE RECEPTACLE WITH STRAIGHT BACKSHELL

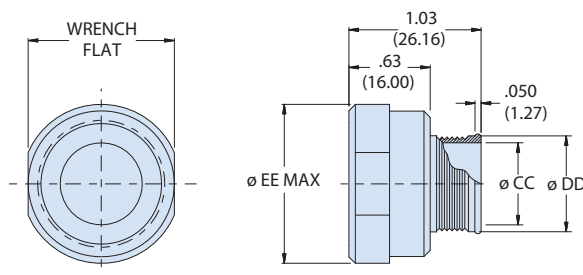

OPTIONAL BANDING BACKNUT
 FOR USE WITH CONFIGURATIONS WITHOUT BACKSHELL (-03, -04, & -06)

Shell Size	A Thread	B Thread Class 2B	ØD Max	ØE Max	Ø AA Max	BB Flat
11 (A)	.7500 .1P-2L-DS	.7500 -20 UNEF	.960 (24.4)	.960 (24.4)	.963 (24.46)	.768 (19.51)
13 (B)	.8750 .1P-2L-DS	.8750 -20 UNEF	1.085 (27.6)	1.085 (27.6)	1.088 (27.64)	.893 (22.68)
15 (C)	1.0625 .1P-2L-DS	1.0000 -20 UNEF	1.255 (31.9)	1.257 (31.9)	1.275 (32.39)	1.080 (27.43)
23 (F)	1.5000 .1P-2L-DS	1.4375 -18 UNEF	1.695 (43.1)	1.763 (44.8)	1.719 (43.66)	1.518 (38.56)