

Series 48 Nut Plates

Selection Guide

Series 48 Nut Plates



Series 48 Nut Plates are used to mount square flange connectors to panels and bulkheads. Nut plates eliminate loose lockwashers and nuts for faster installation time and prevention of dropped hardware in hard-to-reach areas. Available in three styles: ¼ perimeter, ¾ perimeter and full perimeter. The popular "C" shaped ¾ perimeter plate can be slipped over the wire bundle just before installation. Two finishes are available: chem film (chromate conversion coating) or epoxy primer. Passivated stainless steel clinch nuts, T6061 aluminum alloy plate.

- T6061 Aluminum Alloy
- Self-Locking SST Clinch Nuts
- Chem Film or Epoxy Primer Finishes

Three Styles

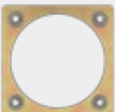

Full Perimeter

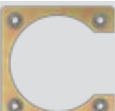

¾ Perimeter



¼ Perimeter

MIL-DTL-38999
Series I, III, IV

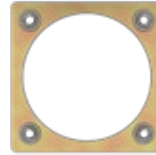

M85049/94
M85049/95
M85049/96

Page 48-2

AS50151
MIL-DTL-26482
MIL-DTL-83723
Series III
MIL-DTL-26500
MIL-DTL-38999
Series II

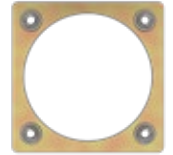

M85049/94
M85049/95
M85049/96

Page 48-3

AS81703
Series 3

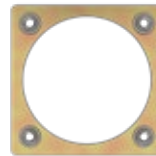

M85049/94
M85049/95
M85049/96

Page 48-4

MS3472
(Wide Flange
MIL-DTL-26482)

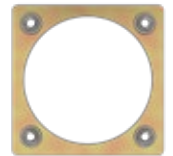

M85049/95

Page 48-5

MIL-DTL-28840
MIL-PRF-28876

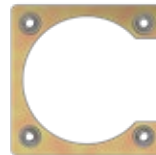

480-005
Page 48-5

Series 806
MII-Aero

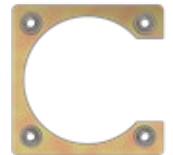

480-003
Page 48-6

Series 970
PowerTrip

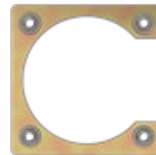

480-006
Page 48-7

Series 80
Mighty Mouse

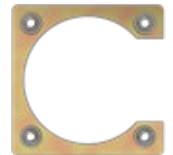

809-199
809-303
Page 48-8