

Series 48 Nut Plates

809-199, 809-303 Nut Plates for Series 80 Mighty Mouse Connectors

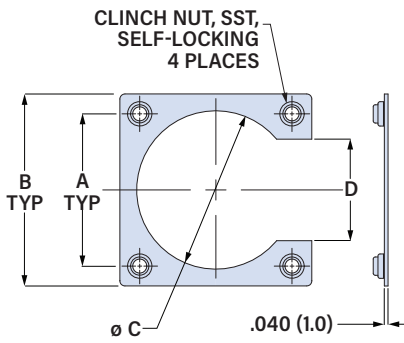

Nut Plate with Chem Film



Nut plates eliminate loose lockwashers and nuts for faster installation time and prevention of dropped hardware in hard-to-reach areas. Two finishes are available: chem film or epoxy primer. Passivated stainless steel clinch nuts, 6061 aluminum alloy plate.

PART NUMBER

		809-199	-9	EAP
Base P/N	809-199 809-303	Nut Plate with UNC Threads Nut Plate with Metric Threads		
Dash Number	See Table			
Finish	Omit for Chem Film EAP Epoxy Primer			

Dash Number	Shell Size				A		B		ø C		D		Thread Size	
	Series 800	Series 801	Series 802	Series 805	± .005 (0.1) in mm	± .010 (0.3) in mm	± .010 (0.3) in mm	± .010 (0.3) in mm	± .010 (0.3) in mm	± .010 (0.3) in mm	UNC	Metric		
-1			5		.500	12.7	.780	19.8	.400	10.2	.220	5.6	4-40	M3-0.5
-2			6		.625	15.9	.905	23.0	.600	15.2	.345	8.8	4-40	M3-0.5
-3				8	.660	16.8	.880	22.4	.700	17.8	.440	11.2	2-56	M2-0.5
-4			7		.688	17.5	.968	24.6	.680	17.3	.408	10.4	4-40	M3-0.5
-5	9, 10				.720	18.3	1.000	25.4	.728	18.5	.440	11.2	4-40	M3-0.5
-6				9	.720	18.3	.940	23.9	.728	18.5	.440	11.2	2-56	M2-0.5
-7			8		.750	19.1	1.030	26.2	.770	19.6	.470	11.9	4-40	M3-0.5
-8				10	.785	19.9	1.005	25.5	.805	20.4	.565	14.4	2-56	M2-0.5
-9	12	13	9		.812	20.6	1.092	27.7	.860	21.8	.532	13.5	4-40	M3-0.5
-10				11	.848	21.5	1.068	27.1	.868	22.0	.628	16.0	2-56	M2-0.5
-11			10		.875	22.2	1.155	29.3	.946	24.0	.595	15.1	4-40	M3-0.5
-13				12	.909	23.1	1.129	28.7	.909	23.1	.629	16.0	2-56	M2-0.5
-14			12		.938	23.8	1.218	30.9	1.018	25.9	.658	16.7	4-40	M3-0.5
-16		16			.981	24.9	1.261	32.0	1.061	26.9	.701	17.8	4-40	M3-0.5
-17		17		15	1.060	26.9	1.340	34.0	1.140	29.0	.780	19.8	4-40	M3-0.5
-18			14		1.125	28.6	1.405	35.7	1.205	30.6	.845	21.5	4-40	M3-0.5
-19		19	15		1.188	30.2	1.468	37.3	1.268	32.2	.908	23.1	4-40	M3-0.5
-20				18	1.255	31.9	1.535	39.0	1.335	33.9	.975	24.8	4-40	M3-0.5
-21		21		19	1.327	33.7	1.607	40.8	1.407	35.7	1.047	26.6	4-40	M3-0.5
-22				23	1.570	39.9	1.850	47.0	1.650	41.9	1.290	32.8	4-40	M3-0.5