

Series 44 Banding Backshells

for AS50151 Crimp, M26482 Series II, M83723 Series III, AS95234

440A*069 Banding Backshell, Shrink Boot, Self-Locking

Self-Locking



Adapter Code A

AS50151 crimp, AS95234, MIL-DTL-26482 Ser. II, MIL-DTL-83723 Ser. III

PROFILE SELECTION GUIDE

<p>S Straight</p>	<p>C 90°</p> <p>Low Profile Split</p>
<p>D 90°</p> <p>Split</p>	<p>F 45°</p> <p>Split</p>
<p>H 45°</p> <p>Cut and Weld</p>	<p>J 90°</p> <p>Cut and Weld</p>
<p>M 45°</p> <p>Full Radius</p>	<p>N 90°</p> <p>Full Radius</p>

Self-Locking. Band-Master ATS® shield termination. 440A*069 banding adapter fits AS50151 crimp (MS3450), AS95234, MIL-DTL-26482 Series II, MIL-DTL-83723 Series III connectors. Anti-decoupling mechanism provides audible detented coupling and prevents backoff under high vibration. Terminate cable braid shield to adapter with optional band strap. Optional shrink boot adds strain relief and environmental protection. Aluminum version has thermoplastic detent spring, stainless steel version has stainless steel detent spring.

PART NUMBER

440AS069 ZI 18 06- 4 K P T

Base P/N	Base Part No.	Profile	Shell Size
	440AS069	S Str.	08-36
	440AC069	C 90°	08-24
	440AD069	D 90°	08-24
	440AF069	F 45°	08-24
	440AH069	H 45°	08-36
	440AJ069	J 90°	08-36
	440AM069	M 45°	08-24
440AN069	N 90°	08-24	
Material/Finish	M	Alum/ Electroless Nickel	
	MT	Alum/ Nickel-PTFE	
	NF	Alum/ Olive Drab Cadmium	
	ZR	Alum/ Black Zinc-Nickel	
	TZ	Alum/ Tin-Zinc	
	ZI	SST/ Passivated (Profiles H, J, M, N, S only)	
Shell Size	08 10 12 14 16 18 20 22 24 28 32 36		
Entry Size	Shell		Shell
	Size	Inside Dia.	Size
	01	.125 (3.2)	07
	02	.188 (4.8)	08
	03	.250 (6.4)	09
	04	.312 (7.9)	10
	05	.375 (9.5)	11
	06	.438 (11.1)	12
	07	.500 (12.7)	13
	08	.562 (14.3)	14
	09	.625 (15.9)	15
	10	.688 (17.5)	16
	11	.750 (19.1)	-
	12	.812 (20.6)	-
* If selected entry size exceeds shell size range, a Style 2 transition adapter will be included. See Maximum Entry Size for details. Profile entry size cannot exceed shell size range listed in table.			
Length	3	1.5 inches	Applies to Profile S only.
	4	2.0 inches	If Entry Size is greater than "Maximum Entry Size" (see table), then 2 inch minimum applies.
	5	2.5 inches	
	6	3.0 inches	
Band	Omit if not required		
	K	Pre-Coiled Band Included With Backshell	
Polysulfide	Omit if not required. Applies to Plating Codes NF, ZR, TZ only.		
	P	Nickel Plated Shield Termination Area with Polysulfide Barrier	
Shrink Boot	Omit if not required		
	T	Shrink Boot Included With Backshell	
T1	Adhesive-lined Shrink Boot Included With Backshell		

Series 44 Banding Backshells

for AS50151 Crimp, M26482 Series II, M83723 Series III, AS95234

440A*069 Banding Backshell, Shrink Boot, Self-Locking

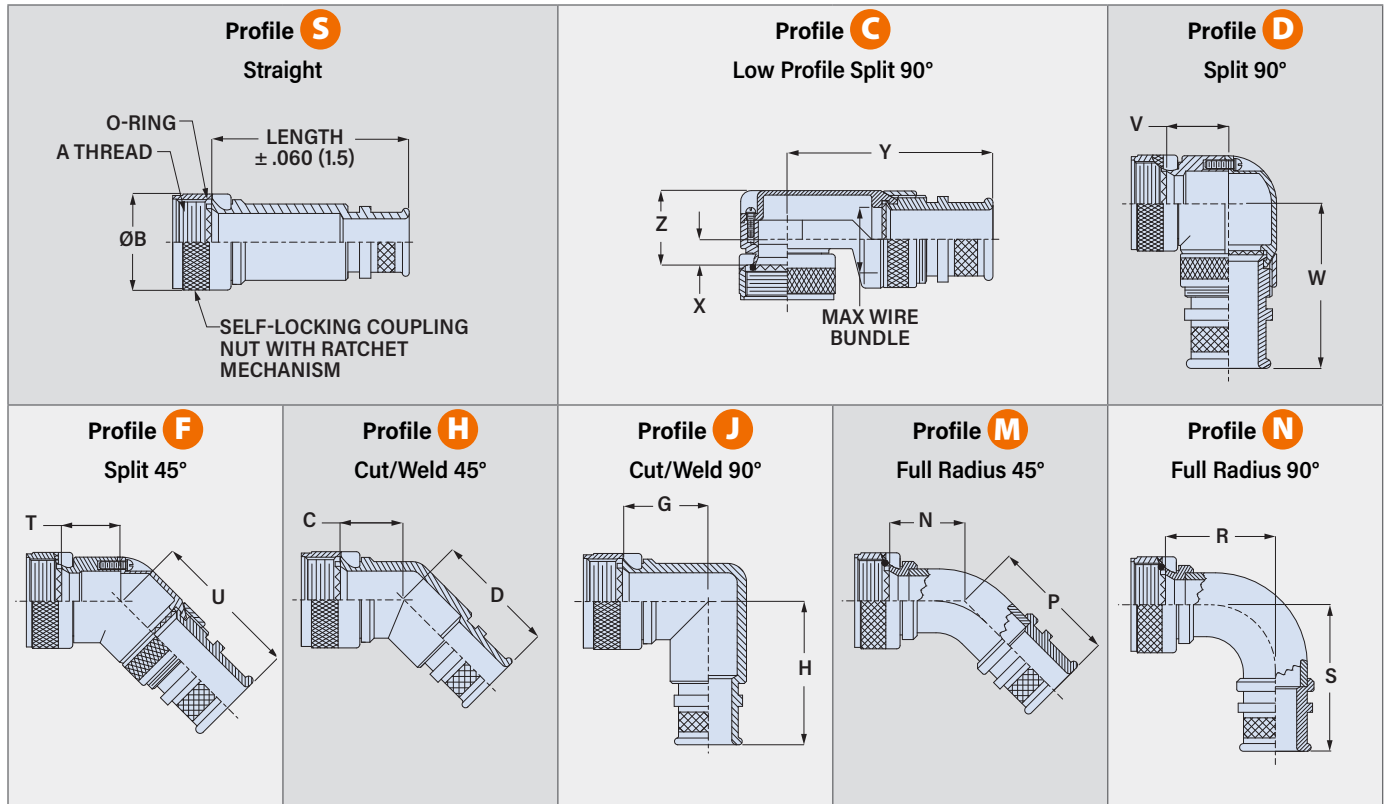

Shell Size	A Thread Class 2B	øB Max		C Max.		D Max.		G Max.		H Max.		N Max.		P Max.		R Max.		S Max.	
		in	mm	in	mm	in	mm	in	mm	in	mm	in	mm	in	mm	in	mm	in	mm
08	0.500-20 UNF	.69	17.5	.806	20.5	1.038	26.4	.906	23.0	1.146	29.1	.968	24.6	1.017	25.8	1.281	32.5	1.335	33.9
10	0.625-24 UNEF	.82	20.8	.832	21.1	1.064	27.0	.966	24.5	1.210	30.7	1.031	26.2	1.071	27.2	1.406	35.7	1.460	37.1
12	0.750-20 UNEF	.94	23.8	.856	21.7	1.088	27.6	1.026	26.0	1.268	32.2	1.094	27.8	1.121	28.5	1.531	38.9	1.585	40.3
14	0.875-20 UNEF	1.06	26.9	.882	22.4	1.114	28.3	1.076	27.3	1.330	33.8	1.156	29.4	1.175	29.8	1.656	42.1	1.710	43.4
16	1.000-20 UNEF	1.17	29.7	.908	23.1	1.150	29.2	1.136	28.8	1.392	35.4	1.218	30.9	1.224	31.1	1.781	45.2	1.835	46.6
18	1.0625-18 UNEF	1.46	37.1	.927	23.5	1.190	30.2	1.176	29.9	1.438	36.5	1.250	31.8	1.274	32.4	1.906	48.4	1.960	49.8
20	1.1875-18 UNEF	1.60	40.6	.953	24.2	1.250	31.8	1.236	31.4	1.500	38.1	1.312	33.3	1.328	33.7	2.031	51.6	2.085	53.0
22	1.3125-18 UNEF	1.70	43.2	.979	24.9	1.320	33.5	1.296	32.9	1.562	39.7	1.344	34.1	1.382	35.1	2.156	54.8	2.210	56.1
24	1.4375-18 UNEF	1.84	46.7	1.004	25.5	1.380	35.1	1.356	34.4	1.625	41.3	1.406	35.7	1.431	36.3	2.281	57.9	2.335	59.3
28	1.750-18 UNS	2.01	51.1	1.197	30.4	1.500	38.1	1.422	36.1	1.654	42.0								
32	2.000-18 UNS	2.26	57.4	1.280	32.5	1.620	41.1	1.545	39.2	1.777	45.1								
36	2.250-16 UN	2.53	64.3	1.294	32.8	1.750	44.4	1.652	41.9	1.844	46.8								

Shell Size	T Max.		U Max.		V Max.		W Max.		X Max.		Y Max.		Z Max.		Profile C Max. Wire Bundle	
	in	mm	in	mm	in	mm	in	mm	in	mm	in	mm	in	mm	in	mm
08	.596	15.1	1.635	41.5	.836	21.2	1.575	40.0	.496	12.6	1.915	48.6	.837	21.3	.250	6.4
10	.656	16.7	1.695	43.1	.906	23.0	1.635	41.5	.426	10.8	2.075	52.7	.887	22.5	.375	9.5
12	.716	18.2	1.765	44.8	.966	24.5	1.705	43.3	.426	10.8	2.075	52.7	.887	22.5	.375	9.5
14	.776	19.7	1.795	45.6	1.026	26.1	1.735	44.1	.436	11.1	2.145	54.5	.987	25.1	.500	12.7
16	.836	21.2	1.895	48.1	1.086	27.6	1.835	46.6	.576	14.6	2.195	55.8	1.137	28.9	.625	15.9
18	.906	23.0	1.955	49.7	1.156	29.4	1.895	48.1	.796	20.2	2.225	56.5	1.337	34.0	.625	15.9
20	.976	24.8	2.015	51.2	1.216	30.9	1.955	49.7	.796	20.2	2.225	56.5	1.337	34.0	.625	15.9
22	1.036	26.3	2.075	52.7	1.276	32.4	2.015	51.2	.696	17.7	2.375	60.3	1.337	34.0	.750	19.1
24	1.096	27.8	2.135	54.2	1.336	33.9	2.075	52.7	.696	17.7	2.375	60.3	1.337	34.0	.750	19.1

Series 44 Banding Backshells

for AS50151 Crimp, M26482 Series II, M83723 Series III, AS95234

440A*069 Banding Backshell, Shrink Boot, Self-Locking

ENTRY SIZE

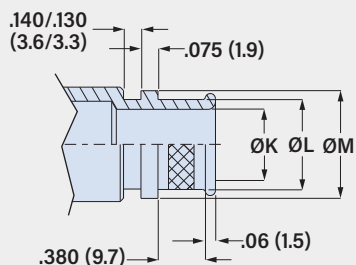

Entry Size	Shell Sizes	øK		øL		øM		Entry Size	Shell Sizes	øK		øL		øM	
		± .015(0.4) in	± .015(0.4) mm	± .015(0.4) in	± .015(0.4) mm	± .015(0.4) in	± .015(0.4) mm			± .015(0.4) in	± .015(0.4) mm	± .015(0.4) in	± .015(0.4) mm		
01	08-36	.125	3.2	.250	6.4	.312	7.9	07	20-36	.875	22.2	1.000	25.4	1.062	27.0
31	08-36	.188	4.8	.312	7.9	.375	9.5	37	22-36	.938	23.8	1.062	27.0	1.125	28.6
02	08-36	.250	6.4	.375	9.5	.438	11.1	08	22-36	1.000	25.4	1.125	28.6	1.188	30.2
32	10-36	.312	7.9	.438	11.1	.500	12.7	38	24-36	1.062	27.0	1.188	30.2	1.250	31.8
03	10-36	.375	9.5	.500	12.7	.562	14.3	09	24-36	1.125	28.6	1.250	31.8	1.312	33.3
33	12-36	.438	11.1	.562	14.3	.625	15.9	10	28-36	1.250	31.8	1.375	34.9	1.438	36.5
04	12-36	.500	12.7	.625	15.9	.687	17.4	11	32-36	1.375	34.9	1.500	38.1	1.562	39.7
34	14-36	.562	14.3	.688	17.5	.750	19.1	12	32-36	1.500	38.1	1.625	41.3	1.688	42.9
05	16-36	.625	15.9	.750	19.1	.812	20.6	13	32-36	1.625	41.3	1.750	44.5	1.812	46.0
35	16-36	.688	17.5	.812	20.6	.875	22.2	14	36	1.750	44.5	1.875	47.6	1.938	49.2
06	18-36	.750	19.1	.875	22.2	.938	23.8	15	-	1.875	47.6	2.000	50.8	2.062	52.4
36	18-36	.812	20.6	.938	23.8	1.000	25.4	16	-	2.000	50.8	2.125	54.0	2.188	55.6

MAXIMUM ENTRY SIZE

If the selected entry size exceeds the maximum size in this table, the backshell will have a front adapter. This is called a **Style 2** backshell.

⚠ Profile **G** backshells are not available with entry sizes larger than shown in table.

Shell Size	Max. Entry Size	Shell Size	Max. Entry Size
08	02	20	07
10	03	22	08
12	04	24	09
14	34	28	10
16	35	32	13
18	06	36	14

Style 2 Straight Backshell

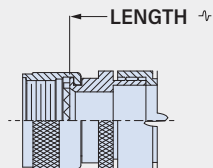

For Style 2 straight backshells, the minimum length code increases from 3 (1 1/2 inches) to 4 (2 inches).

Style 2 45° and 90° Backshells

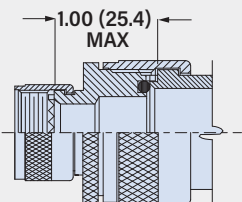

For Style 2 45° and 90° backshells, the length increases by one inch.

SHRINK BOOT

Optional heatshrink boot provides cable strain relief and environmental protection. Type 1 high-performance semi-rigid elastomer resists fuels and oils and withstands temperature extremes. Available with W1 hot melt adhesive pre-coat. Operating temperature range -75 to +150 °C (no adhesive), -55 to +125 °C (with W1 adhesive).

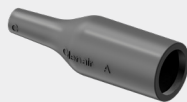

Entry Sizes	Adhesive Lined Shrink Boot P/N	
	Shrink Boot P/N	Shrink Boot P/N
01-31	770-003S111	770-003S111W1
02-32	770-003S112	770-003S112W1
03	770-001S103	770-001S103W1
33-35	770-001S104	770-001S104W1
06-37	770-001S105	770-001S105W1
08-38	770-001S106	770-001S106W1
09-12	770-001S107	770-001S107W1
13-14	770-001S108	770-001S108W1
15-16	770-001S109	770-001S109W1

BAND

Optional SST band strap provides fast, cost-effective and highly reliable termination of braided metallic shielding. The Band-Master ATS® Advanced Cable Shield Termination System is the overwhelming favorite throughout the military aerospace and defense industries, providing excellent static loading and corrosion resistance in electrical wire interconnect systems.



Band 601-041



Banding Tool 601-100

POLYSULFIDE

Optional selective electroless nickel plating on shield termination area and polysulfide dielectric barrier prevents galvanic mismatch between nickel-coated braid shield and backshell.

⚠ Plating codes NF, ZR and TZ only

