

Determine Wire Strip Length for Machined Contacts



1. MEASURE DEPTH OF CRIMP BARREL, SEE FIGURE 1

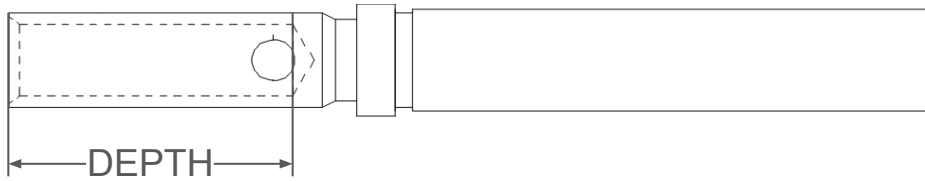

Figure 1. Contact socket



Figure 2. Drop gauge can measure depth

2. MEASURE OUTER DIAMETER OF WIRE, SEE FIGURE 3

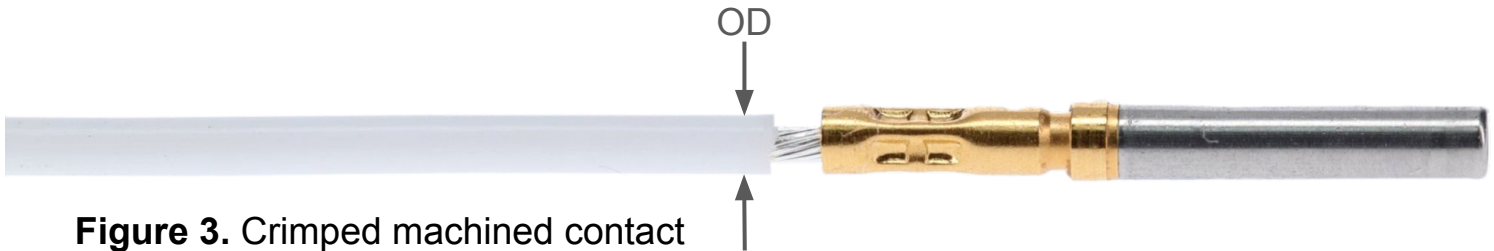

Figure 3. Crimped machined contact

**3. NOMINAL WIRE STRIP LENGTH:
DEPTH OF CRIMP BARREL + OD WIRE**

$$\text{STRIP LENGTH} = \text{NOMINAL STRIP LENGTH} \pm \text{OD}$$



Figure 4. Wire strip length

**0 < INSULATION GAP < 2X OD
AND
WIRE MUST BE INTACT AND VISIBLE FROM INSPECTION WINDOW**

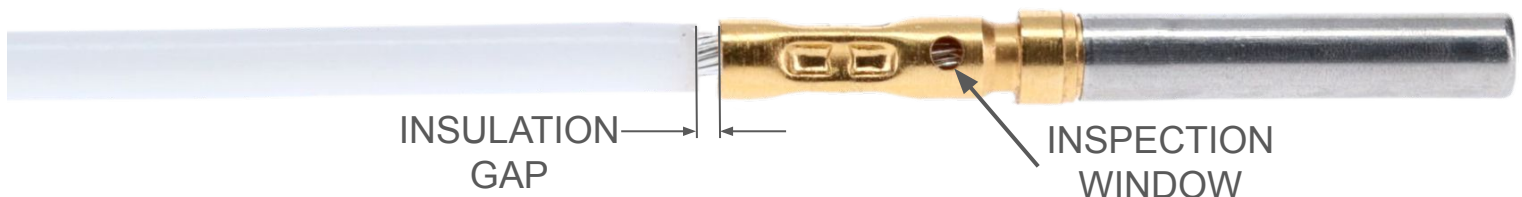

Figure 5. Acceptable wire strip length