

# Well-Master™ 260 High Temperature Micro-D GHTM Back-To-Back Cable Assemblies

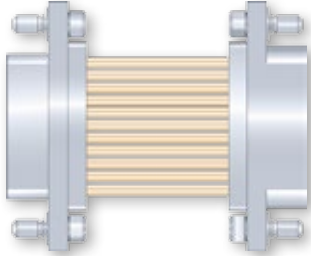

Micro-D  
Well-Master™  
260

## GHTM Back-To-Back Cable Assemblies



GHTM Well-Master™ 260 back-to-back Micro-D cable assemblies withstand +260°C continuous operating temperature. These .050" pitch Micro-D connectors are terminated to #24 or #26 AWG insulated wire. Nickel-coated copper wire conforms to M22759/87, PTFE/ polyimide insulation. Contacts are crimped to wire, factory-installed and potted with epoxy. Pin contacts are gold-plated high performance twistpin type and are recessed into insulator to prevent damage. Special nickel alloy contact material resists softening in high heat. Machined passivated stainless steel shell. Glass-filled high temperature LCP thermoplastic insulators. Meets performance requirements of MIL-DTL-83513. Available with 9 to 37 contacts. 3 A., 600 Vac, -55°C to +260°C.

### HOW TO ORDER

#### Sample Part Number

GHTM	-31	GS	-6	T	7	-18	B
Series	No. of Contacts	Contact Type	Wire Gage (AWG)	Wire Type	Wire Color	Wire Length (Inches)	Mounting Hardware
<b>GHTM</b> Glenair High Temperature Micro	<b>-9</b> <b>-15</b> <b>-21</b> <b>-25</b> <b>-31</b> <b>-37</b>	<b>GP</b> Pin Connector Both Ends  <b>GS</b> Socket Connector Both Ends  <b>CS</b> Pin Connector to Socket Connector	<b>-4</b> #24  <b>-6</b> #26	<b>T</b> PTFE/ Polyimide Insulated Nickel Coated Copper	<b>1</b> White  <b>7</b> 10 Color Repeat	Wire Length In Inches	<b>B</b> Thru-Hole  <b>M</b> Hex Head Jackscrew  <b>S</b> slot head jackscrew  <b>P</b> Jackpost

### GHTM MOUNTING HARDWARE

<b>B</b> Thru-Hole Mounting .096/.088 Dia. (2.43/2.23)	<b>M and S</b> #2-56 Jackscrews Slot head (S) Hex Head (M)	<b>P</b> Integral Jackpost #2-56
<b>Pin</b>	<b>Pin</b>	<b>Pin</b>
<b>Socket</b>	<b>Socket</b>	<b>Socket</b>

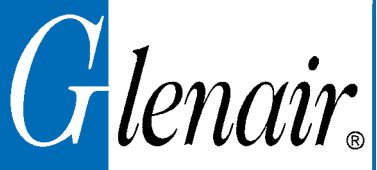

# Well-Master™ 260 High Temperature Micro-D GHTM Back-To-Back Cable Assemblies

## GHTM BACK-TO-BACK DIMENSIONS: THRU-HOLE AND JACKSCREW VERSIONS

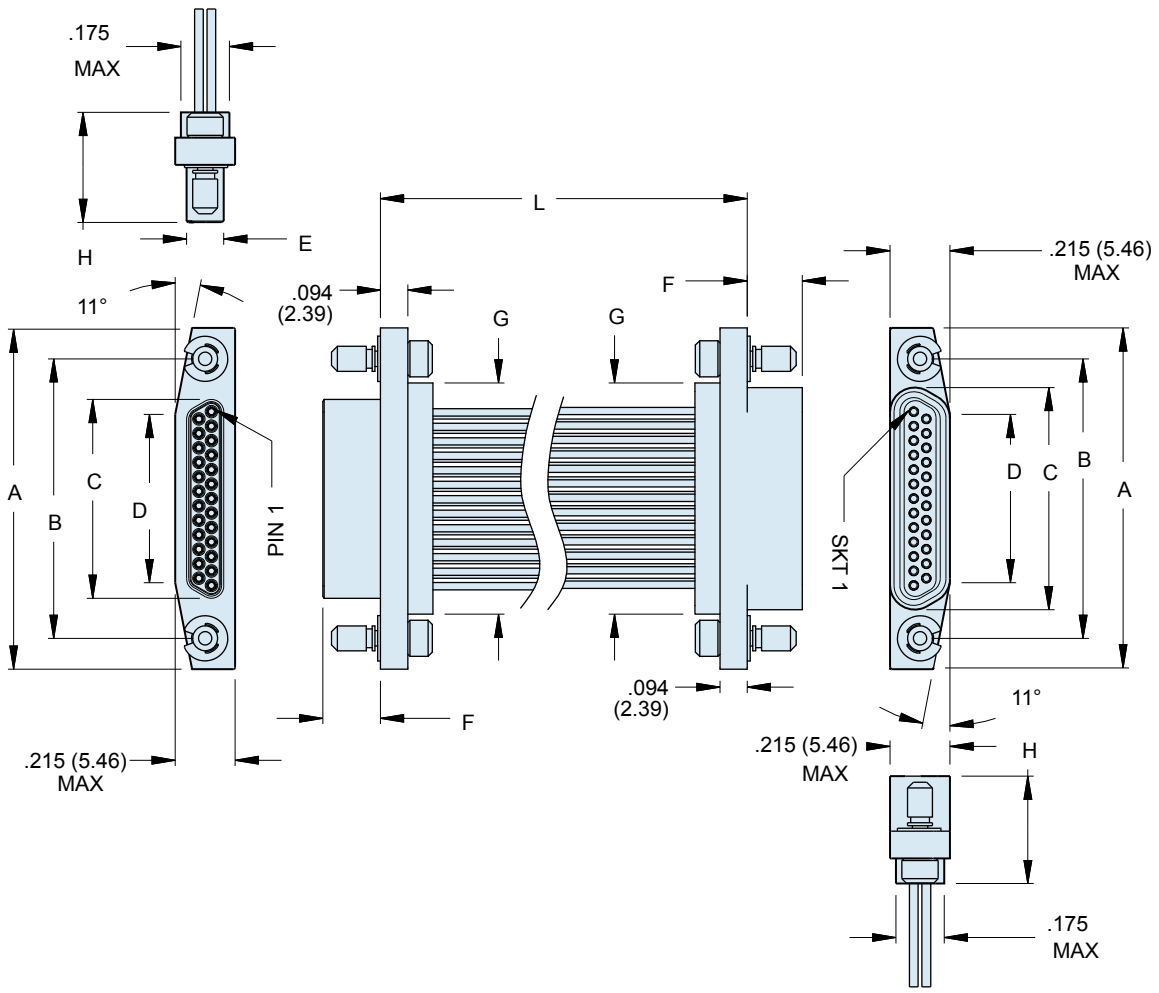

Layout	A Max.		B		C Max.		D		E Max.		F		G Max.		H Max.	
	In.	mm.	In. ± .003	mm. ± 0.08	In.	mm.	In.	mm.	In.	mm.	In. ± .003	mm. ± 0.08	In.	mm.	In.	mm.
9P	.785	19.94	.565	14.35	.290	7.37	.181	4.60	.131	3.33	.199	5.05	.405	10.29	.390	9.91
9S	.785	19.94	.565	14.35	.371	9.42	.181	4.60	.215	5.46	.191	4.85	.405	10.29	.377	9.58
15P	.935	23.75	.715	18.16	.440	11.18	.331	8.41	.131	3.33	.199	5.05	.555	14.10	.390	9.91
15S	.935	23.75	.715	18.16	.521	13.23	.331	8.41	.215	5.46	.191	4.85	.555	14.10	.377	9.58
21P	1.085	27.43	.865	21.97	.590	14.99	.481	12.22	.131	3.33	.199	5.05	.705	17.91	.390	9.91
21S	1.085	27.43	.865	21.97	.671	17.04	.481	12.22	.215	5.46	.191	4.85	.705	17.91	.377	9.58
25P	1.185	30.01	.965	24.51	.690	17.53	.581	14.76	.131	3.33	.199	5.05	.805	20.45	.390	9.91
25S	1.185	30.01	.965	24.51	.771	19.58	.581	14.76	.215	5.46	.191	4.85	.805	20.45	.377	9.58
31P	1.335	33.91	1.115	28.32	.840	21.34	.731	18.57	.131	3.33	.199	5.05	.955	24.26	.390	9.91
31S	1.335	33.91	1.115	28.32	.921	23.39	.731	18.57	.215	5.46	.191	4.85	.955	24.26	.377	9.58
37P	1.485	37.72	1.265	32.13	.990	25.15	.881	22.38	.131	3.33	.199	5.05	1.105	28.07	.390	9.91
37S	1.485	37.72	1.265	32.13	1.071	27.20	.881	22.38	.215	5.46	.191	4.85	1.105	28.07	.377	9.58

# Well-Master™ 260 High Temperature Micro-D GHTM Back-To-Back Cable Assemblies



Micro-D™  
Well-Master™  
260

## GHTM BACK-TO-BACK DIMENSIONS: INTEGRAL JACKPOST VERSIONS

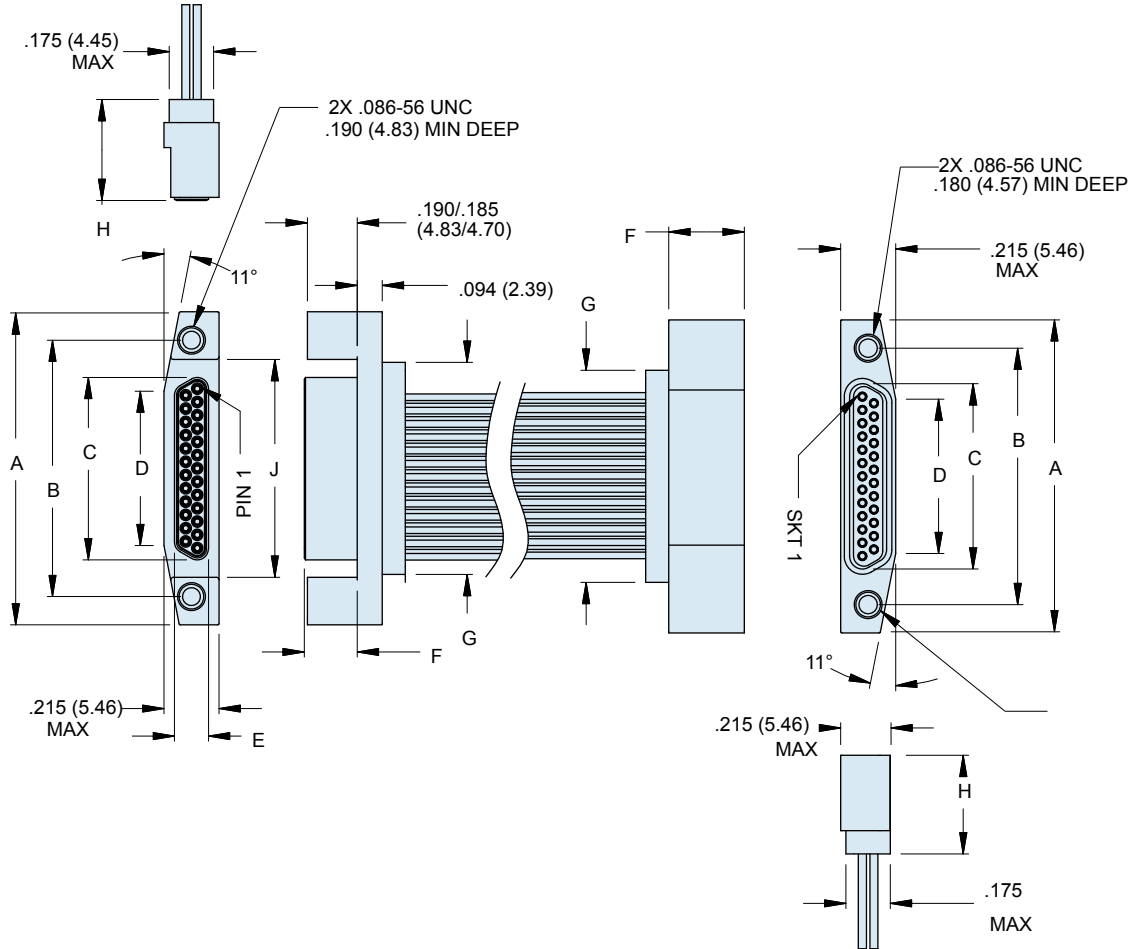

Layout	A Max.		B		C Max.		D		E Max.		F		G Max.		H Max.		J	
	In.	mm.	In. $\pm .003$	mm. $\pm 0.08$	In.	mm.	In.	mm.	In.	mm.	In. $\pm .003$	mm. $\pm 0.08$	In.	mm.	In.	mm.	In.	mm.
9P	.785	19.94	.565	14.35	.290	7.37	.181	4.60	.131	3.33	.199	5.05	.405	10.29	.390	9.91	.420	10.67
9S	.785	19.94	.565	14.35	.301	7.65	.181	4.60	.215	5.46	.274	6.96	.405	10.29	.377	9.58	N/A	N/A
15P	.935	23.75	.715	18.16	.440	11.18	.331	8.41	.131	3.33	.199	5.05	.555	14.10	.390	9.91	.570	14.48
15S	.935	23.75	.715	18.16	.451	11.46	.331	8.41	.215	5.46	.274	6.96	.555	14.10	.377	9.58	N/A	N/A
21P	1.085	27.43	.865	21.97	.590	14.99	.481	12.22	.131	3.33	.199	5.05	.705	17.91	.390	9.91	.720	18.29
21S	1.085	27.43	.865	21.97	.601	15.27	.481	12.22	.215	5.46	.274	6.96	.705	17.91	.377	9.58	N/A	N/A
25P	1.185	30.01	.965	24.51	.690	17.53	.581	14.76	.131	3.33	.199	5.05	.805	20.45	.390	9.91	.820	20.83
25S	1.185	30.01	.965	24.51	.701	17.81	.581	14.76	.215	5.46	.274	6.96	.805	20.45	.377	9.58	N/A	N/A
31P	1.335	33.91	1.115	28.32	.840	21.34	.731	18.57	.131	3.33	.199	5.05	.955	24.26	.390	9.91	.970	24.64
31S	1.335	33.91	1.115	28.32	.851	21.62	.731	18.57	.215	5.46	.274	6.96	.955	24.26	.377	9.58	N/A	N/A
37P	1.485	37.72	1.265	32.13	.990	25.15	.881	22.38	.131	3.33	.199	5.05	1.105	28.07	.390	9.91	1.120	28.45
37S	1.485	37.72	1.265	32.13	1.001	25.43	.881	22.38	.215	5.46	.274	6.96	1.105	28.07	.377	9.58	N/A	N/A