

Micro-D Backshells Potting Shell 507-035



Potting Shells provide easy encapsulation of Micro-D solder cup terminations. These potting shells provide .25 inches (6.3 mm.) of depth.

| MATERIALS | |
|-----------|----------------------------|
| Shell | Aluminum Alloy 6061 -T6 |
| Clips | 17-7PH Stainless Steel |
| Hardware | 300 Series Stainless Steel |

HOW TO ORDER 507-035 POTTING SHELLS

| Series | Shell Finish | Connector Size | Hardware Option |
|--------------------|-------------------------------------|-----------------------|---|
| 507-035 | E – Chem Film | 09 51 | Omit for Fillister Head Jackscrew H – Hex Head Jackscrew E – Extended Jackscrew F – Jackpost, Female |
| | J – Cadmium, Yellow Chromate | 15 51-2 | |
| | M – Electroless Nickel | 21 67 | |
| | NF – Cadmium, Olive Drab | 25 69 | |
| | Z2 – Gold | 31 100 | |
| | | 37 | |
| Sample Part Number | | | |
| 507-035 | – M | 25 | H |

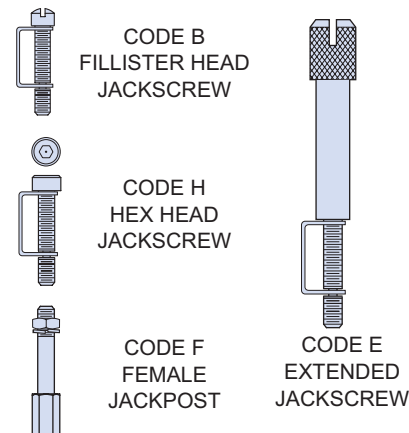
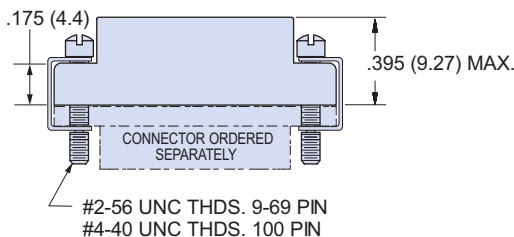
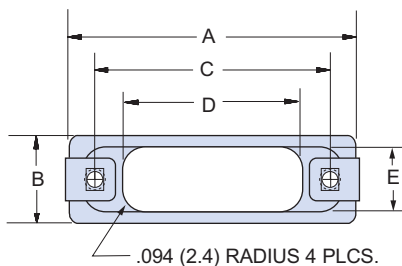

| Size | A Max. | | B Max. | | C | | D | | E | | L |
|------|--------|-------|--------|-------|-------|-------|---------------|--------------|---------------|--------------|---|
| | In. | mm. | In. | mm. | In. | mm. | In. ± .030 | mm. ± 0.8 | In. ± .030 | mm. ± 0.8 | |
| 09 | .850 | 21.59 | .370 | 9.40 | .565 | 14.35 | .31 | 7.9 | .26 | 6.6 | |
| 15 | 1.000 | 25.40 | .370 | 9.40 | .715 | 18.16 | .48 | 12.2 | .26 | 6.6 | |
| 21 | 1.150 | 29.21 | .370 | 9.40 | .865 | 21.97 | .65 | 16.5 | .26 | 6.6 | |
| 25 | 1.250 | 31.75 | .370 | 9.40 | .965 | 24.51 | .75 | 19.1 | .26 | 6.6 | |
| 31 | 1.400 | 35.56 | .370 | 9.40 | 1.115 | 28.32 | .88 | 22.4 | .26 | 6.6 | |
| 37 | 1.550 | 39.37 | .370 | 9.40 | 1.265 | 32.13 | 1.03 | 26.2 | .26 | 6.6 | |
| 51 | 1.500 | 38.10 | .410 | 10.41 | 1.215 | 30.86 | .98 | 24.9 | .30 | 7.6 | |
| 51-2 | 1.910 | 48.51 | .370 | 9.40 | 1.615 | 41.02 | 1.38 | 35.0 | .26 | 6.6 | |
| 67 | 2.310 | 58.67 | .370 | 9.40 | 2.015 | 51.18 | 1.78 | 45.2 | .26 | 6.6 | |
| 69 | 1.810 | 45.97 | .410 | 10.41 | 1.515 | 38.48 | 1.28 | 32.5 | .30 | 7.6 | |
| 100 | 2.235 | 56.77 | .460 | 11.68 | 1.800 | 45.72 | 1.35 | 34.3 | .36 | 9.1 | |