

257-163 Flange Mount and 257-164 Weld Mount Connector Receptacle Assemblies Stainless Steel



5015 Type
Connectors

257-163 H 14S-5 P X

Basic Part Number
257-163 Flange Mount
257-164 Weld Mount

H = Hermetic, Substitute Dash For Non-Hermetic

Shell Size

Alternate Insert Position (See Below),
N for Normal

Contact Style: P = Pin,
S = Socket (Non-Hermetic Only)

Insert Arrangement Dash No.

257-163 Flange Mount

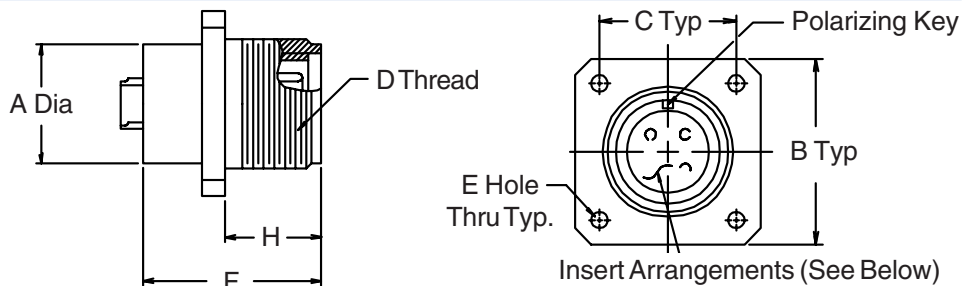

257-164 Weld Mount

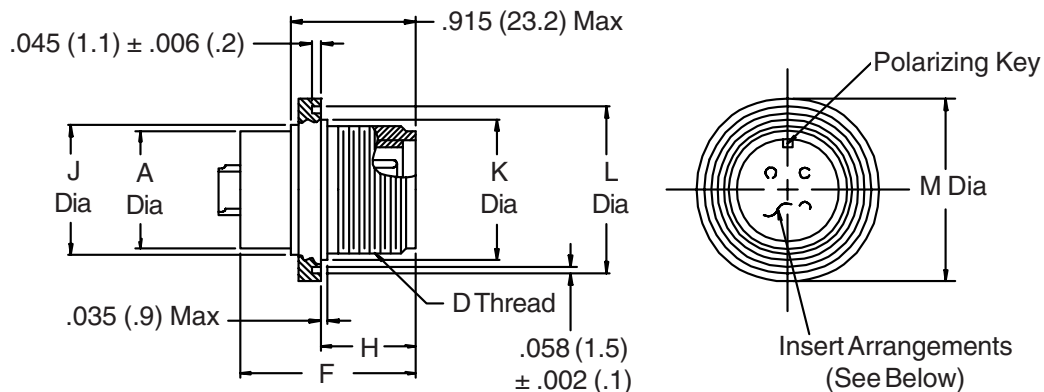

Insert Arrangements

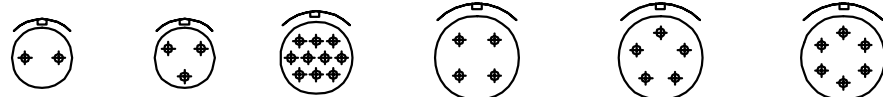

Shell Size - Insert Arr. Dash No.	10SL-4	10SL-3	12-10	14S-2	14S-5	14S-6
Contact Size & Quantity	2 - #16	3 - #16	10 - #20	4 - #16	5 - #16	6 - #16
MS Service Rating	A	A	Inst.	Inst.	Inst.	Inst.
Available Alternate Insert Positions (Degrees rotation clockwise looking into the front of the pin insert)	n/a	n/a	n/a	X=120°, Y=240°	X=110°	n/a

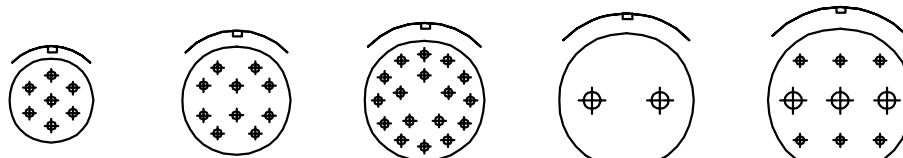

Shell Size - Insert Arr. Dash No.	14S-7	18-1	20-29	22-1	24-11
Contact Size & Quantity	7 - #16	10 - #16	17 - #16	2 - #16	6 - #16, 3 - #18
MS Service Rating	Inst.	4 A, 6 Inst.	A	D	A
Available Alternate Insert Positions (Degrees rotation clockwise looking into the front of the pin insert)	W=90°, X=180°, Y=270°	W=70°, X=145°, Y=215°, Z=290°	W=80°, Z=280°	n/a	W=35°, X=110°, Y=250°, Z=325°

257-163 Flange Mount and 257-164 Weld Mount Connector Receptacle Assemblies Stainless Steel

TABLE I

Dash No.	A		B Sq.		C		D Thread	E		F
	Max	(.8)	±.031	(.8)	±.005	(.1)	Class 2A UNEF	+010 -.005	(.1) (1.3)	Max
10SL	.609	(15.5)	1.000	(25.4)	.719	(18.3)	.625 - 24	.120	(3.0)	1.000 (25.4)
12	.650	(16.5)	1.094	(27.8)	.812	(20.6)	.750 - 20	.120	(3.0)	1.000 (25.4)
14S	.733	(18.6)	1.188	(30.2)	.906	(23.0)	.875 - 20	.120	(3.0)	1.000 (25.4)
18	.975	(24.8)	1.375	(34.9)	1.062	(27.0)	1.125 - 18	.120	(3.0)	1.200 (30.5)
20	1.105	(28.1)	1.500	(38.1)	1.156	(29.4)	1.250 - 18	.120	(3.0)	1.200 (30.5)
22	1.328	(33.7)	1.625	(41.3)	1.250	(31.8)	1.375 - 18	.147	(3.7)	1.200 (30.5)
24	1.350	(34.3)	1.750	(44.5)	1.375	(34.9)	1.500 - 18	.147	(3.7)	1.200 (30.5)

TABLE II

Dash No.	H		J Dia	K Dia	L Dia	M Dia				
	+0.031 -.000	(.8) (.0)								
10SL	.562	(14.3)	.750	(19.1)	.825	(21.0)	1.061	(26.9)	1.132	(28.8)
12	.562	(14.3)	.906	(23.0)	.950	(24.1)	1.187	(30.1)	1.258	(32.0)
14S	.562	(14.3)	1.016	(25.8)	1.075	(27.3)	1.279	(32.5)	1.345	(34.2)
18	.724	(18.4)	1.250	(31.8)	1.275	(32.4)	1.479	(37.6)	1.550	(39.4)
20	.724	(18.4)	1.375	(34.9)	1.450	(36.8)	1.654	(42.0)	1.725	(43.8)
22	.724	(18.4)	1.500	(38.1)	1.575	(40.0)	1.744	(44.3)	1.815	(46.1)
24	.724	(18.4)	1.625	(41.3)	1.700	(43.2)	1.879	(47.7)	1.950	(49.5)

TABLE III

	Non-Hermetic Receptacles	Hermetic Receptacles
Shell	Passivated Stainless Steel	Passivated Stainless Steel
Insulator	Nitrile/Neoprene	Full Glass
O-Ring, Grommet	Nitrile/Neoprene	Nitrile/Neoprene
Contacts	Gold Plated Copper Alloy With Solder Pots	Alloy 52/Gold Plate
Contact Current Rating	#20-5 Amps #16-10 Amps #12-17 Amps #8-35 Amps	#20-5 Amps #16-10 Amps #12-17 Amps #8-35 Amps
Rated Operating Voltage	Service Rating INST - 250 VDC Service Rating A - 700 VDC Service Rating D - 1250 VDC	250 VDC
Dielectric Withstanding Voltage (Hi-Pot)	Service Rating INST - 1000 VRMS Service Rating A - 2000 VRMS Service Rating D - 2800 VRMS	1000 VRMS
Insulation Resistance	5000 Megohms minimum at 500 VDC and +25°C	5000 Megohms minimum at 500 VDC and +25°C
Temperature Range	-55°C to +125°C	-55°C to +125°C

1. Metric dimensions (mm) are indicated in parentheses.
2. **Electrical safety limits must be established by the user. Peak voltages, switching surges, etc., should be used to determine the safety of application.**