

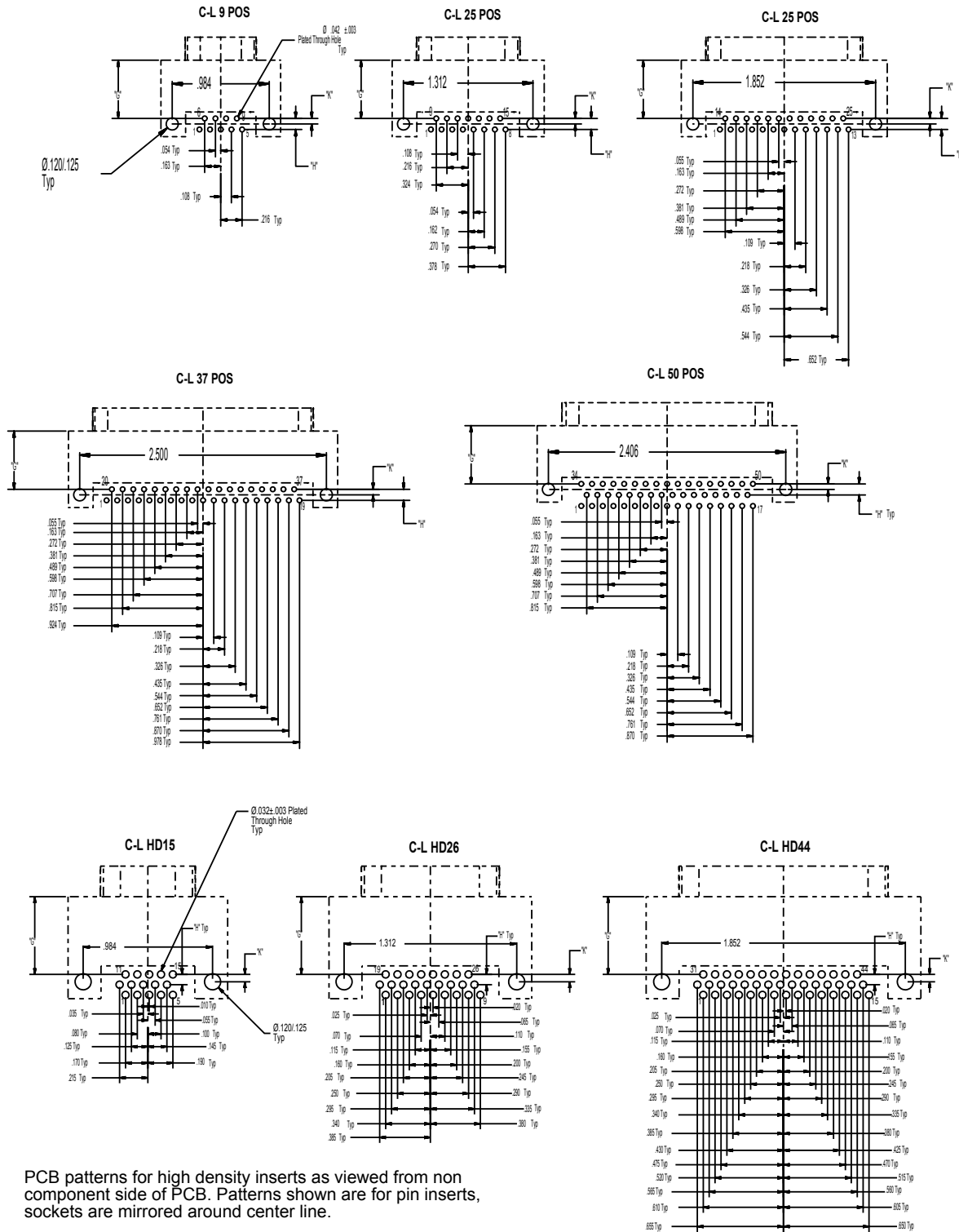

# Panel Cut-Out and Footprints for 240-021 and 240-066 D-Subminiature Connectors EMI Filtered (MIL-DTL-24308 Type)



PCB patterns for high density inserts as viewed from non component side of PCB. Patterns shown are for pin inserts, sockets are mirrored around center line.

# Panel Cut-Out and Footprints for 240-021 and 240-066 D-Subminiature Connectors EMI Filtered (MIL-DTL-24308 Type)

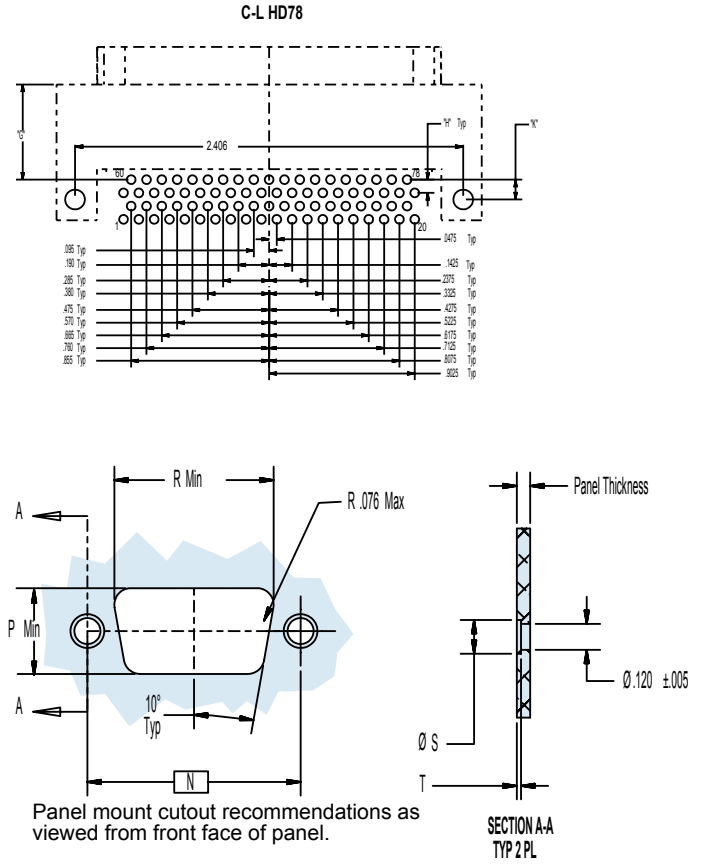
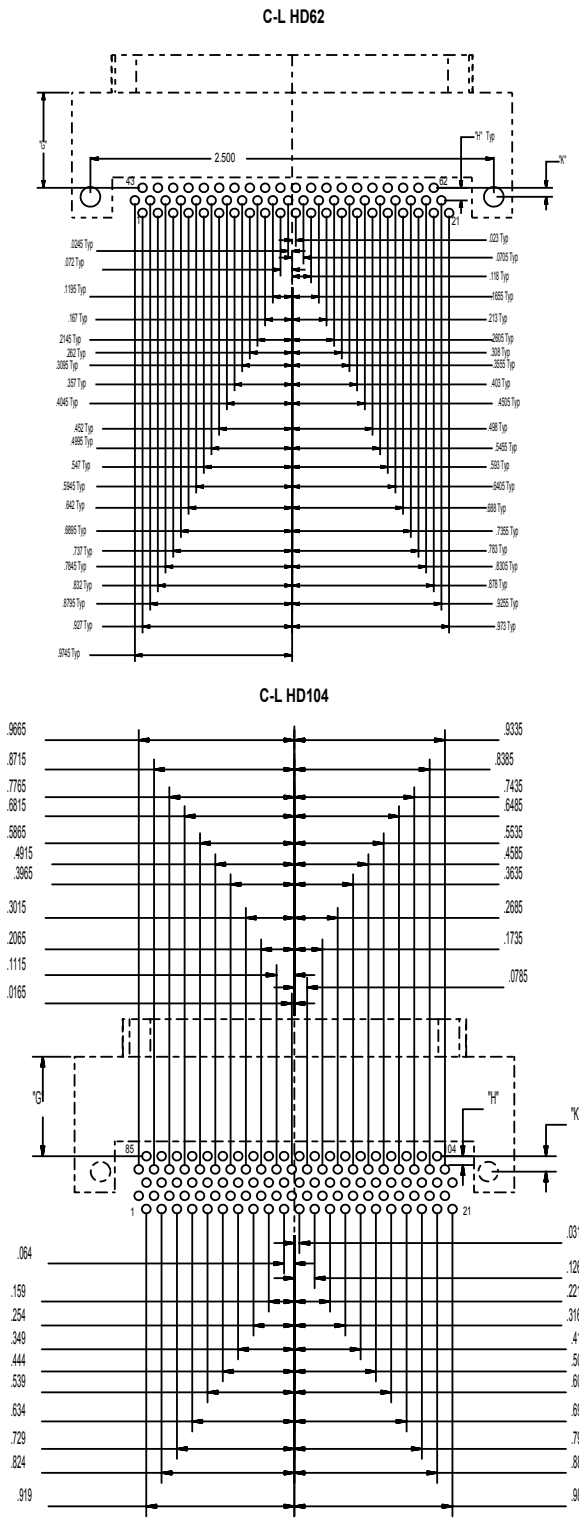

Panel mount cutout recommendations as viewed from front face of panel.

**TABLE VI: CUT-OUT DIMENSIONS**

Shell Size	N BSC	P Min	R Min
1	.984 (25.0)	.396 (10.1)	.735 (18.7)
2	1.312 (33.3)	.396 (10.1)	1.060 (26.9)
3	1.852 (47.0)	.396 (10.1)	1.603 (40.7)
4	2.500 (63.5)	.396 (10.1)	2.251 (57.2)
5	2.406 (61.1)	.510 (13.0)	2.148 (55.0)
6	2.500 (63.5)	.630 (16.0)	2.276 (57.8)

**TABLE VII: PANEL THICKNESS**

Panel Code	Panel Thickness	S	T
R1	.031 (0.79)	N/A	N/A
R2	.047 (1.19)	.157/.199 (4.0/5.1)	.005 (0.13)
R3	.062 (1.57)	.157/.199 (4.0/5.1)	.020 (0.50)
R4	.093 (2.36)	.157/.199 (4.0/5.1)	.051 (1.30)
R5	.104 (2.64)	.157/.199 (4.0/5.1)	.061 (1.55)
R6	.125 (3.18)	.157/.199 (4.0/5.1)	.082 (2.08)
R7	.156 (3.96)	.157/.199 (4.0/5.1)	.114 (2.90)