

## ITS 4108 RG (D1) and ITS 4108 RRG (D1) 90° Cylindrical Plug Assembly with Rubber-Coated Backshell for Termination of UNI4883 Rubber Conduit

**FR ITS G 41 08 RG 20-27 P Y D12722 XXX**

Fire Resistant Rubber Compound

Reverse Bayonet Coupling

Grounding Fingers  
(Omit for Standard)

Contact Type  
41 - Crimp

08 - 90° Plug Assembly

Connector/Backshell Class  
RG (D1) - Non-Environmental; Supplied with Backshell Only  
RRG (D1) - Environmental; Supplied with Wire Sealing Grommet

Mod Code Option (See Table II)

UNI4883 Backshell Adapter Shell Size Designator (See Table III)

Alternate Insert Rotation (W, X, Y, Z)  
Omit for Normal (See Section A)

Contact Gender  
P - Pin  
S - Socket

Shell Size and Insert Arrangement (See Section A)

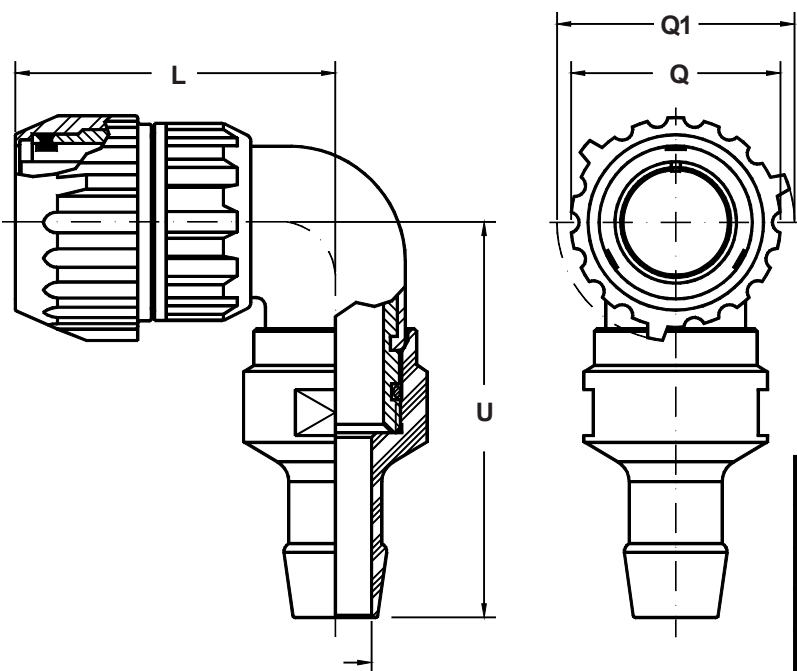

**TABLE II: MODIFICATION CODES**

CONTACT OPTIONS	
Sym	Description
B0	Connector less contacts
B1	Connector with gold plated contacts
Omit for version Silver plated	

### Application Notes:

- 90° plug assembly with rubber-coated backshell for termination of UNI41883 type rubber conduit.
- RG (D1) - Non-Environmental. Supplied with backshell only;  
RRG (D1) - Environmental. Supplied with wire sealing grommet.
- Standard materials configuration consists of aluminum alloy with plating ROHS compliant.
- Standard contact material consists of copper alloy with silver plating or gold plating.
- A broad range of additional connector accessories are available.  
See our website and/or contact the factory for complete information.

**ITS 4108 RG (D1) and ITS 4108 RRG (D1)  
90° Cylindrical Plug Assembly  
with Rubber-Coated Backshell  
for Termination of UNI4883 Rubber Conduit**

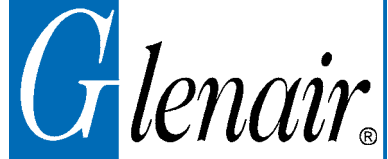

Series ITS-RG

**TABLE I: DIMENSIONS**

Shell size	Rubber conduits UNI 4883	L	ØQ	ØQ1	U
		Max.	±0.5	±0.5	Max.
14 S		57	35.0	42.0	-
16 S	20x15	58	38.0	45.0	-
16	23x18	67	38.0	45.0	-
18	27x22	68	43.5	49.0	85
20	29x24	71	46.0	51.5	85
22	33x28	71	50.5	56.0	85
24	38x33	76	54.0	60.0	85
28	40x35	76	61.0	67.0	85
32	48x43	80	68.0	76.0	85
36	50x45	84	74.0	82.0	90
40		88	80.0	88.0	95

**TABLE III: BACKSHELL DIMENSIONS RUBBER CONDUIT**

Shell Size	In accordance with UNI 4883		ØB ±0.1	±0.2
	ø Min.	ø Max.		
10SL	12.0	17.0	10.5	
18	22.0	27.0	20.5	
20 - 22	12.0	17.0	10.5	
20 - 22	22.0	27.0	20.5	
20 - 22	28.0	33.0	31.5	
24 - 28	20.0	25.0	16.5	
24 - 28	22.0	27.0	20.5	
24 - 28	26.0	31.0	22.5	
24 - 28	28.0	33.0	26.5	
24 - 28	30.0	35.0	26.5	
24 - 28	33.0	38.0	31.5	
24 - 28	45.0	50.0	36.2	
32	26.0	31.0	24.5	
32	28.0	33.0	26.5	
32	33.0	38.0	31.5	
32	35.0	40.0	31.5	
32	45.0	50.0	40.0	
36	30.0	35.0	26.5	
36	33.0	38.0	31.5	
36	35.0	40.0	31.5	
36	45.0	50.0	43.5	
40	36.0	41.0	31.5	
40	40.0	45.0	38.5	
40	45.0	50.0	43.5	
40	50.0	55.0	48.5	

