

ITS 31030 A (BR) and ITS 41030 A (BR)

Rear Panel Mount Square Flange Receptacle Assembly with Backshell for Termination of UNI4883 Rubber Conduit

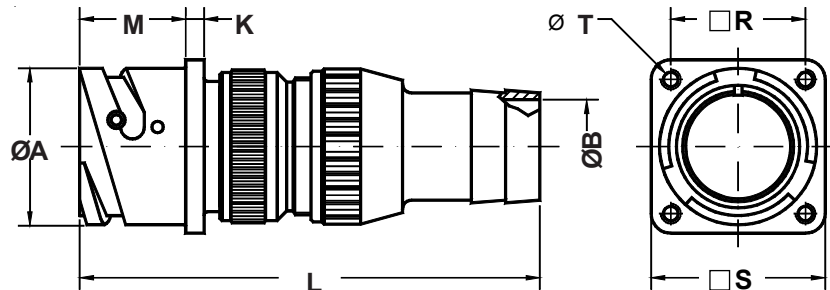
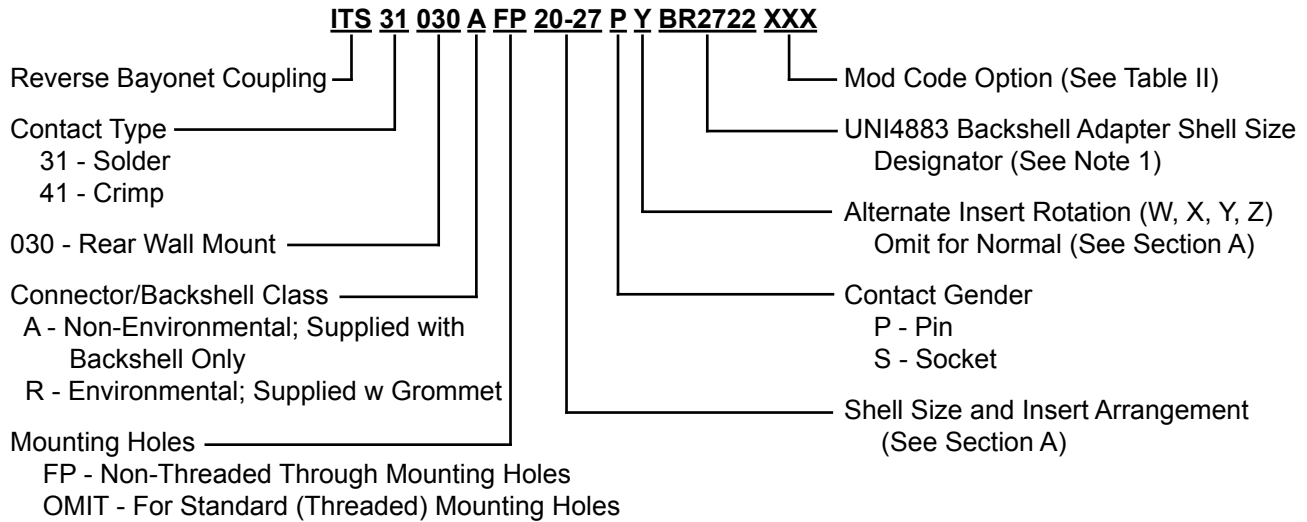

TABLE II: MODIFICATION CODES

CONTACT OPTIONS	
Sym	Description
B0	Connector Less Contacts
B1	Connector with Gold Plated Contacts
Omit for standard version (Silver plated)	

FINISH OPTIONS	
Sym	Description and RoHS compliant (*)
F2	Bright Nickel Plating (*)
F6	Black Electrodeposited Paint (*)
F7	Black Zn-Co Plating (*)
F8	Olive Drab Zn-Co Plating
F11	Electroless Nickel (*)
Omit for standard version (Cadmium Olive Drab Finish)	

Application Notes:

- Rear panel mount square flange receptacle with backshell for termination of UNI4883 type rubber conduit. Threaded mounting holes standard. Optional non-threaded mounting holes available.
- Connector/Backshell Class "A" (non-environmental)—Not supplied with wire sealing grommet; Class "R" (environmental)—Supplied with backshell and grommet.
- Standard materials configuration consists of aluminum alloy. For platings, see TABLE II finish options.
- Standard contact material consists of copper alloy with silver plating or gold plating.
- A broad range of other front and rear connector accessories are available. See our website and/or contact the factory for complete information.
- Standard insert material is synthetic rubber. Add "FR" prefix to front of part number to specify fire resistant inserts.

ITS 31030 A (BR) and ITS 41030 A (BR)
Rear Panel Mount Square Flange Receptacle Assembly
with Backshell for Termination of UNI4883 Rubber Conduit



TABLE I: DIMENSIONS

Shell Size	ØA +0 -0.1	ØB ±0.1	K ±0.2	L Max.	M +0.2 -0	R ±0.1	S +0.2	T Thread
10 SL	18.2	See Table III Below	2.8	95.0	18.5	18.25	25.4	M4
14 S	24.5		3.3	96.5	18.5	23.00	30.4	M4
16 S	27.2		3.3	96.5	18.5	24.60	32.5	M4
16	27.2		3.3	108.0	23.2	24.60	32.5	M4
18	30.7		4.0	108.0	23.2	27.00	35.0	M4
20	34.0		4.0	108.0	23.2	29.40	38.0	M4
22	37.3		4.0	108.0	23.2	31.75	41.0	M4
24	40.9		4.0	109.5	23.2	34.90	44.5	M4
28	46.7		4.0	116.0	24.4	39.70	50.9	M5
32	53.4		4.0	121.5	24.2	44.45	57.0	M5
36	59.6		4.0	127.0	24.2	49.20	63.5	M5
40	65.5		4.0	127.0	24.4	55.55	69.9	M5

TABLE III: BACKSHELL DIMENSIONS

Shell Size	Rubber tube in accordance with UNI 4883 to be used by size:		ØB ±0.1	ØQ ±0.2	
	Ø Min	Ø Max			
10SL	12.0	17.0	10.5		
18	22.0	27.0	20.5		
20 - 22	12.0	17.0	10.5		
20 - 22	22.0	27.0	20.5		
20 - 22	28.0	33.0	31.5		
24 - 28	20.0	25.0	16.5		
24 - 28	22.0	27.0	20.5		
24 - 28	26.0	31.0	22.5		
24 - 28	28.0	33.0	26.5		
24 - 28	30.0	35.0	26.5		
24 - 28	33.0	38.0	31.5		
24 - 28	45.0	50.0	36.2	24.5	53.0
32	26.0	31.0	24.5	26.5	53.0
32	28.0	33.0	26.5	31.5	53.0
32	33.0	38.0	31.5	31.5	53.0
32	35.0	40.0	31.5	40.0	53.0
32	45.0	50.0	40.0	26.5	57.4
36	30.0	35.0	26.5	31.5	57.4
36	33.0	38.0	31.5	31.5	57.4
36	35.0	40.0	31.5	43.5	57.4
36	45.0	50.0	43.5		
40	36.0	41.0	31.5		
40	40.0	45.0	38.5		
40	45.0	50.0	43.5		
40	50.0	55.0	48.5		