

**710-702**  
**FIRST Bulkhead Feed-Thru Adapter Reducer**  
 Mates with Series 75 Metal-Core Conduit (750-145 & 750-147)

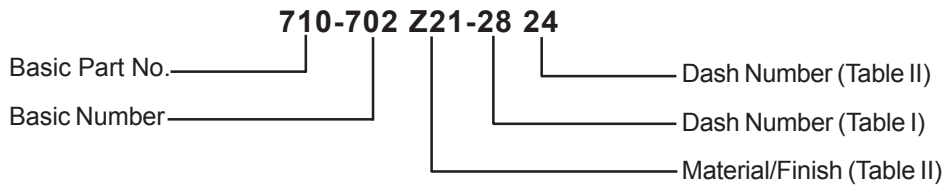
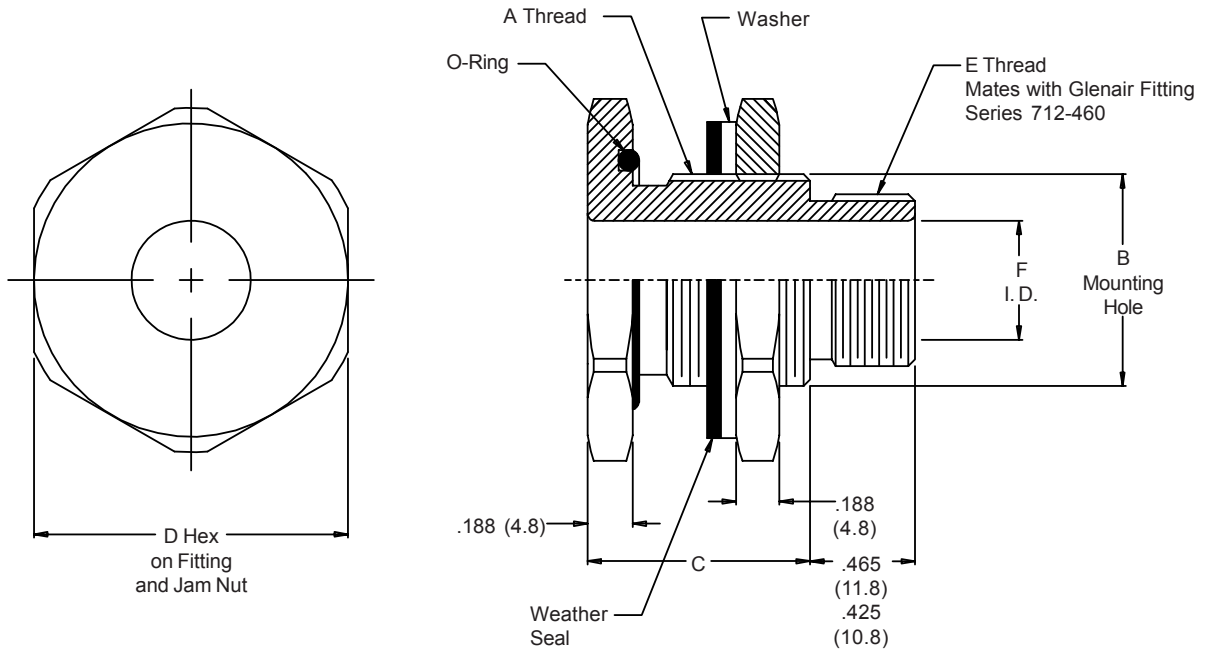

Metric Dimensions (mm) are indicated in parentheses.

710-702

**FIRST Bulkhead Feed-Thru Adapter Reducer**  
**Mates with Series 75 Metal-Core Conduit (750-145 & 750-147)**



Conduit  
Systems

TABLE I

Dash Number	A Thread Class 2A	B Dia +.030 (0.8) -0	C +.020	D Hex	Max E Thread
28	7/8-20 UNEF	.880 (22.4)	.750 (19.1)	1.125 (28.6)	3/4-20
32	1-20 UNEF	1.000 (25.4)	.750 (19.1)	1.250 (31.8)	7/8-20
36	1 1/8-18 UNEF	1.130 (28.7)	.750 (19.1)	1.375 (34.9)	1-20
40	1 1/4-18 UNEF	1.250 (31.8)	.750 (19.1)	1.500 (38.1)	1 1/8-18
42	1 5/16-18 UNEF	1.310 (33.3)	.750 (19.1)	1.625 (41.3)	1 1/4-18
48	1 1/2-18 UNEF	1.500 (38.1)	.750 (19.1)	1.750 (44.5)	1 5/16-18
56	1 3/4-18 UNS	1.750 (44.5)	.880 (22.4)	2.000 (50.8)	1 1/2-18

TABLE II

Dash Number	E Thread Class 2A	F I.D.
24	3/4-20 UNEF	.505 (12.8)
28	7/8-20 UNEF	.630 (16.0)
32	1-20 UNEF	.755 (19.2)
36	1 1/8-18 UNEF	.880 (22.4)
40	1 1/4-18 UNEF	1.005 (25.5)
42	1 5/16-18 UNEF	1.005 (25.5)
48	1 1/2-18 UNEF	1.193 (30.3)

TABLE III: MATERIAL AND FINISH

Symbol	Material	Finish
Z21	316 Cres	Passivate

Metric Dimensions (mm) are indicated in parentheses.