

710-498
FIRST Bulkhead Feed-Thru Adapter
 Mates with Series 75 Metal-Core Conduit (750-145 & 750-147)

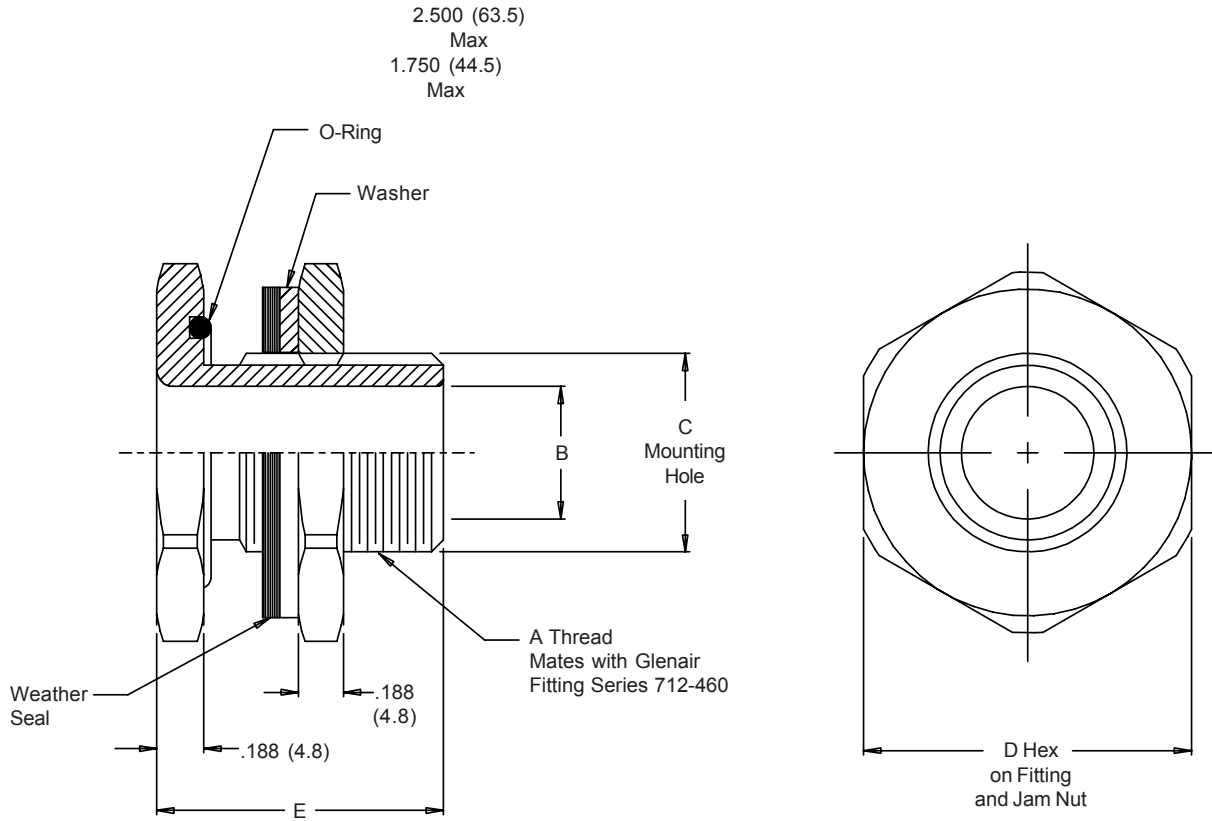

710-498 Z21-24

Basic Part No. _____
 Basic Number _____
 _____ Dash Number (Table I)
 _____ Material/Finish (Table II)

Metric Dimensions (mm) are indicated in parentheses.

710-498
FIRST Bulkhead Feed-Thru Adapter
Mates with Series 75 Metal-Core Conduit (750-145 & 750-147)



TABLE I

Dash Number	A Thread Class 2A	B Dia	C Dia +.030 (0.8) -0	D Hex	E Length
24	3/4-20 UNEF	.505 (12.8)	.750 (19.1)	1.000 (25.4)	1.000 (25.4)
28	7/8-20 UNEF	.630 (16.0)	.880 (22.4)	1.125 (28.6)	1.000 (25.4)
32	1-20 UNEF	.755 (19.2)	1.000 (25.4)	1.250 (31.8)	1.000 (25.4)
36	1 1/8-18 UNEF	.880 (22.4)	1.130 (28.7)	1.375 (34.9)	1.000 (25.4)
40	1 1/4-18 UNEF	1.005 (25.5)	1.250 (31.8)	1.500 (38.1)	1.000 (25.4)
42	1 5/16-18 UNEF	1.005 (25.5)	1.310 (33.3)	1.625 (41.3)	1.000 (25.4)
48	1 1/2-18 UNEF	1.193 (30.3)	1.500 (38.1)	1.750 (44.5)	1.000 (25.4)
56	1 3/4-18 UNS	1.505 (38.2)	1.750 (44.5)	2.000 (50.8)	1.130 (28.7)

TABLE II: MATERIAL AND FINISH

Symbol	Material	Finish
Z21	316 Cres	Passivate

Metric Dimensions (mm) are indicated in parentheses.