

Series 390 (Single Shield) EMI/RFI Environmental Assembly Instructions

A

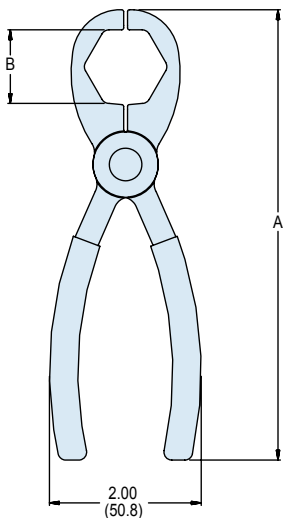

(6) 600-157
Stainless Steel Composite
Hex Coupling Wrench

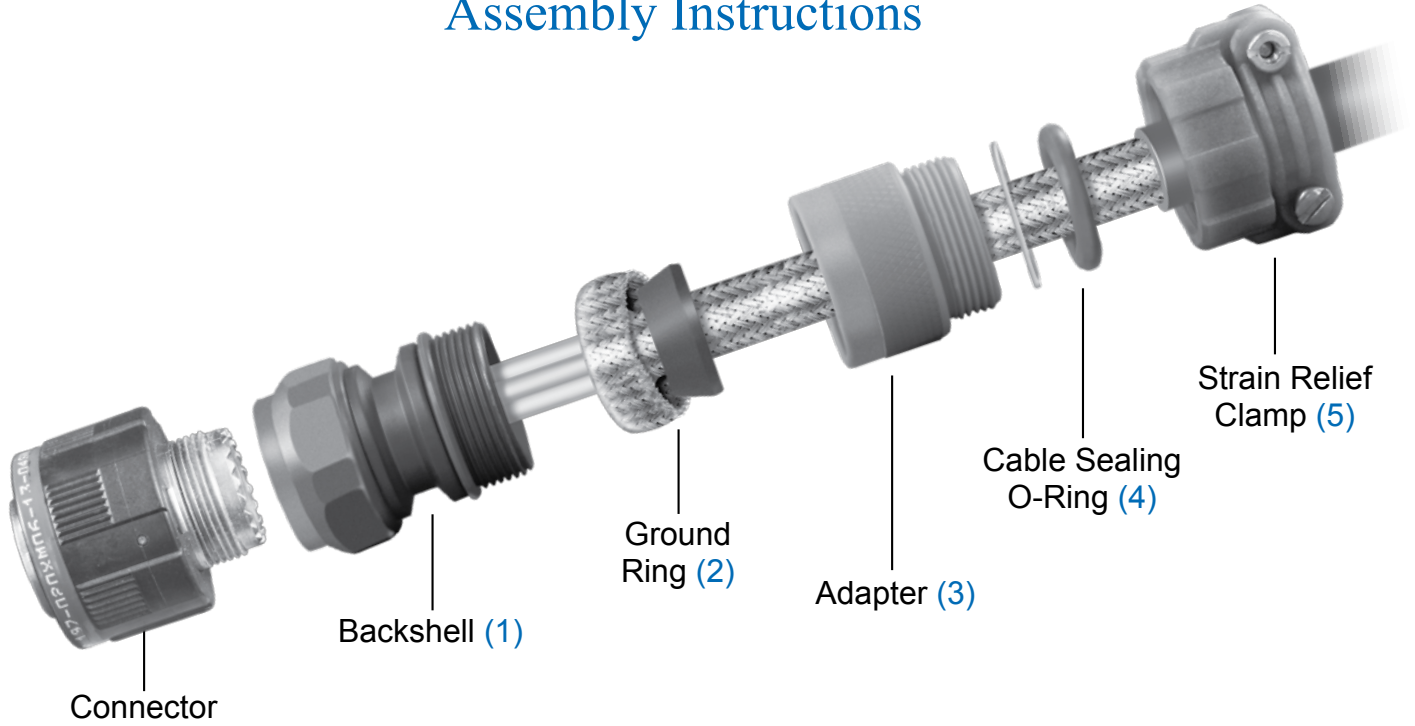
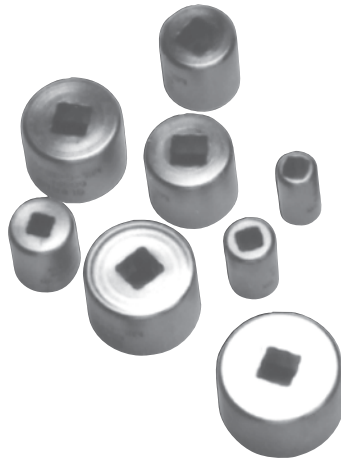

(7) Plug and Receptacle
Holding Tools
for 1/4" and 3/8" Socket



(8) 600-161
Hand Held Digital
Torque Wrench

COMPOSITE COUPLING TORQUE VALUES	
Shell Size Reference	Composite Torque (Inch-Pounds)
08/09	35
10/11	35
12/13	40
14/15	40
16/17	40
18/19	40
20/21	80
22/23	80
24/25	80
28	120
32	120
36	120

Series 390 (Single Shield) EMI/RFI
Environmental Backshell
Assembly Instructions



The following suggested procedure serves as a guide for proper assembly and installation of straight Glenair Series 390 EMI/RFI Cable Sealing Backshells for use with jacketed cables and a single overall EMI shield. It is recommended that trial samples of appropriate cables be used to determine proper trim dimensions of the cable jacket, individual conductors and shielding.

NOTE: As with any electrical connector assembly procedure, be sure to use the proper tools. For convenient reliable assembly of the connector and backshell, it is suggested that Glenair's connector holding tools, strap wrenches and connector pliers be used.

1. Temporarily assemble backshell (1) to connector.
2. Place the ground ring (2), adapter, o-ring seal (plus washer if provided) and strain relief clamp on the cable in the sequence shown. You are staging these components on the cable for installation after wires are terminated to the connector contacts.
3. Insert cable into backshell (1) and bottom against connector. Hold cable in position and mark cable jacket at rear end of backshell.
4. Remove backshell from connector and place on cable with components from step two above
5. Trim cable jacket at a point 3/4 inch toward connector from mark made in step two above, exposing cable shielding.
6. Prepare and terminate wires in accordance with established practices.
7. Assemble backshell (1) to connector and tighten securely using appropriate tools.
8. Flare EMI shield completely over grounding ring. Manipulate shield into the conical counter-bore in the adapter and capture in place with the ground ring.
9. Tighten adapter in place using TG70 strap wrench.
10. Slide O-ring and washer (if provided) against adapter (3).
11. Thread strain relief clamp (5) firmly in place.
12. Tighten saddle bar clamps until they bottom against saddle clamp ears (see saddle clamp assembly procedure).