

A

Series 360 Non-Environmental Backshell Assembly Instructions

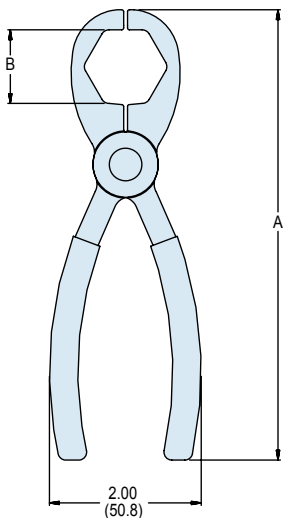

(3) 600-157  
Stainless Steel Composite  
Hex Coupling Wrench

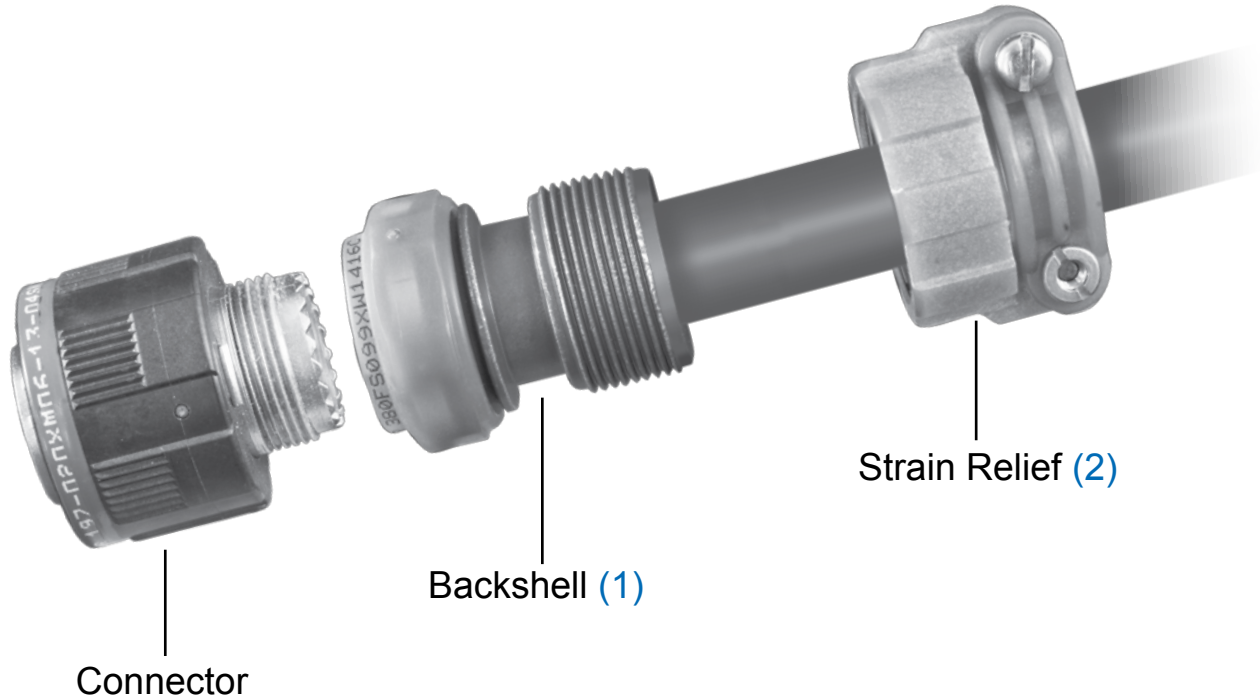
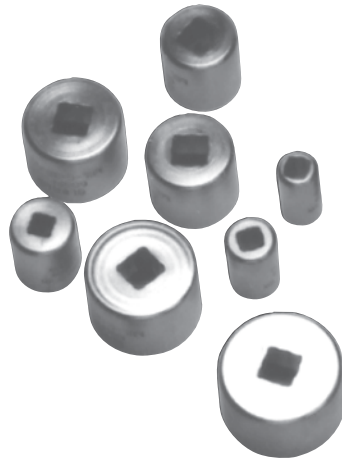

(4) Plug and Receptacle  
Holding Tools  
for 1/4" and 3/8" Socket



(5) 600-161  
Hand Held Digital  
Torque Wrench

COMPOSITE COUPLING TORQUE VALUES	
Shell Size Reference	Composite Torque (Inch-Pounds)
08/09	35
10/11	35
12/13	40
14/15	40
16/17	40
18/19	40
20/21	80
22/23	80
24/25	80
28	120
32	120
36	120

## Series 360 Non-Environmental Backshell Assembly Instructions



The following suggested procedure serves as a guide for proper assembly and installation of Glenair Series 360 Non-Environmental Composite Backshells. It is recommended that trial samples of appropriate cables or wire bundles be used to determine proper trim dimensions of the individual conductors and cable jackets, if applicable.

**NOTE: As with any electrical connector assembly procedure, be sure to use the proper tools. For convenient, reliable assembly of the connectors and backshells, it is suggested that Glenair's connector holding tools, strap wrenches and connector pliers be used.**

1. Temporarily assemble backshell (1) to connector.
2. If cable is jacketed, insert cable into backshell (1) and bottom against connector. Hold cable in position and mark cable jacket at rear end of backshell.
3. Remove backshell from connector and stage the backshell, together with the strain relief clamp (2), up the cable for installation after wires are terminated to the connector contacts.
4. Trim cable jacket at a point 1/2 inch toward connector from mark made in step two above.
5. Prepare and terminate cable conductors in accordance with established practices.
6. Thread backshell (1) onto the connector and tighten securely. Glenair recommends the use of the appropriate sized series 600-157 composite hex coupling wrench (3) to prevent damage to the composite backshell coupling nut. For added convenience in assembly, an appropriately sized series 600-005 connector holding tool (4) is recommended, as well as Glenair digital torque wrench (5).
7. Assemble strain relief (2) to backshell and tighten securely. Tighten strain relief saddles securely on cable or harness (see saddle clamp assembly procedure).