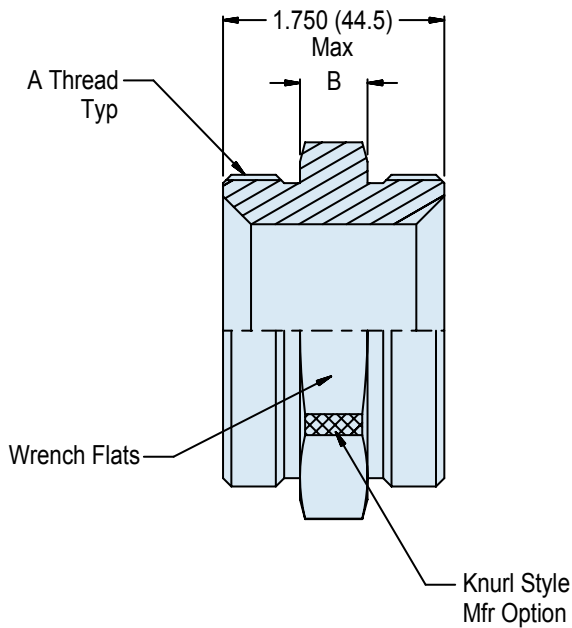

A

**Basic
Number**
M24758-23
**Conduit
Size Code
(Table I)**
C

TABLE I

CONDUIT SIZE CODE	C CLASS - 2A THREAD	B ± .06 (1.52) DIM
A	.438-28 UNEF	.500 (12.70)
B	.688-24 UNEF	.560 (14.22)
C	.938-20 UNEF	.620 (15.75)
D	1.250-18 UNEF	.620 (15.75)
E	1.563-18 UNEF	.680 (17.27)
F	1.875-16 UN	.680 (17.27)
G	2.375-16 UN	.750 (19.05)
H	2.875-16 UN	.750 (19.05)
J	.563-24 UNEF	.500 (12.70)
K	.813-20 UNEF	.560 (14.22)
L	3.375-16 UN	.750 (19.05)

APPLICATION NOTES

- Assembly identified with manufacturer's code identification number (Glenair, part number and classification code 490).
- The M24758-23 union fitting couples to Glenair M24758-2, M24758-3 or M24758-4 series fittings.
- See Glenair Circular Connector Accessories catalog for recommended torque values.
- Material / Finish:
Adapter, coupling nut - 316 / electroless nickel, matte finish.
- Metric dimensions (mm) are indicated in parentheses.