



SERIES GHTM WELL-MASTER 260° Downhole Micro-D Connector



Reference information / contact arrangements

In addition to extreme high temperature tolerance, and demating resistance to vibration and shock, the Glenair Well-Master™ 260° Micro-D connector features unique shell packaging designed to conform with the cylindrical shape of instrument housings. Special angled mounting ears facilitate incorporation of the connector into available space, and the Micro-D's overall reduced size compared to other rectangular connector solutions allows for more efficient utilization.

High Temperature Micro-D with insulated Wire Pigtails

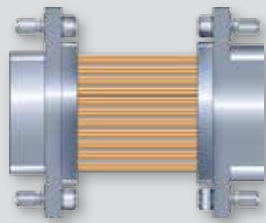
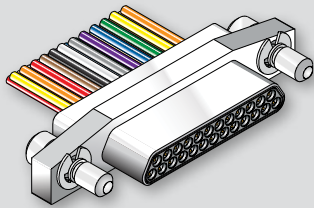

High Temperature Back-to-Back Micro-D

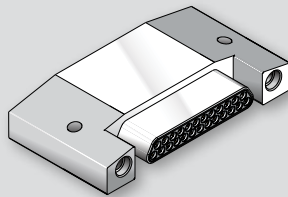

High Temperature PCB Header



DOWNHOLE: WELL-MASTER® 260°

GHTM High Temperature Contact Arrangements (Pin Face View)

9	15	21	25
31	37	51	

Mating face of pin connector. Socket connector contact numbers are reversed.

