

#### ENVIRONMENTAL-1500 PSI MATED OR HERMETIC UP TO -5000 PSI OPEN FACE RECEPTACLE

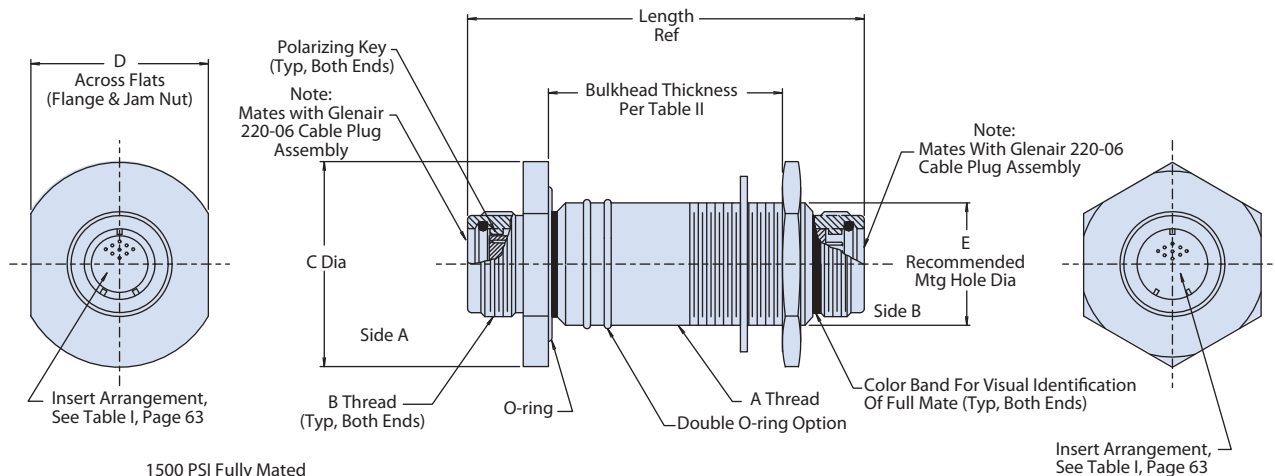

How To Order	
Sample Part Number	227-040 -24-61 S N P N 03 D
Series and Shell Style	227-039 - Standard shell (mates with 220-06 plug) 227-040 - Scoop-Proof shell (mates with 220-016)
Shell Size - Contact Arrangement	See pages 65-66
Side A Contact Style	P = Pins S = Sockets H = Hermetic Pin
Side A Polarization	N, 1, 2, 3, 4 See page B-63
Side B Contact Style	P = Pin S = Socket H = Hermetic Pin
Side B Polarization	N, 1, 2, 3, 4 See page 65
Bulkhead Thickness Dash No.	See Table III
Double O-Ring Option	D (Omit for None)



1500 PSI Fully Mated To Counterpart Connector  
Hydrostatic Pressure Capability

1000 To 5000 PSI Open Face Hermetic (Sym H) Only  
Hydrostatic Pressure Capability

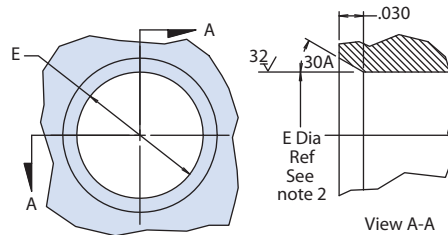

Recommended Panel Cut-out

SUBSEA/SHALLOW WATER: GEO-MARINE®





# SERIES 22 5000M / 5000 PSI Shallow Water Application



## 227-039 and 227-040 Receptacle Jam Nut, Bulkhead Feed-through

Dimensions					
Shell Size	A Thread Class 2A	B Thread Class 2A	C Dia	D Flat	E Dia *
10	7/8-20 UNEF	.750-.1P-.1L	1.41 (35.8)	1.250 (31.8)	.875 (22.2)
12	1-20 UNEF	.875-.1P-.1L	1.53 (38.9)	1.375 (34.9)	1.000 (25.4)
14	1 1/8-18 UNEF	1.000-.1P-.1L	1.66 (42.2)	1.500 (38.1)	1.125 (28.6)
16	1 1/4-16 UN	1.125-.1P-.1L	1.78 (45.2)	1.625 (41.3)	1.250 (31.8)
18	1 3/8-16 UN	1.250-.1P-.1L	1.91 (48.5)	1.750 (44.5)	1.375 (34.9)
20	1 1/2-16 UN	1.375-.1P-.1L	2.03 (51.6)	1.875 (47.6)	1.500 (38.1)
22	1 5/8-16 UN	1.500-.1P-.1L	2.16 (54.9)	2.000 (50.8)	1.625 (41.3)
24	1 3/4-16 UN	1.625-.1P-.1L	2.28 (57.9)	2.125 (54.0)	1.750 (44.5)

\* Standard Shell +.010 (.254) -.000 (.0)      \* Double "O" Ring Option +.002 (.05) -.000 (.0)

Bulkhead Thickness				
Dash No.	Panel Min	Panel Max	Length (Ref.)	
			Standard Shell Length	Scoop-Proof Shell Length
01	.03 (.8)	1.00 (25.4)	2.30 (58.4)	3.00 (76.2)
02	1.00 (25.4)	2.00 (50.8)	3.30 (83.8)	4.00 (101.6)
03	2.00 (50.8)	3.00 (76.2)	4.30 (109.2)	5.00 (127.0)
04	3.00 (76.2)	4.00 (101.6)	5.30 (134.6)	6.00 (152.4)
05	4.00 (101.6)	5.00 (127.0)	6.30 (160.0)	7.00 (177.8)
06	5.00 (127.0)	6.00 (152.4)	7.30 (185.4)	8.00 (203.2)
07	6.00 (152.4)	7.00 (177.8)	8.30 (210.8)	9.00 (228.6)
08	7.00 (177.8)	8.00 (203.2)	9.30 (236.2)	10.00 (254.0)

### NOTES

1. Power to a given contact on one end will result in power to contact directly opposite, regardless of identification letter.
2. For standard o-ring option,  $\sqrt[3]{}$  does not apply and E dia s/b  $\begin{matrix} +.010 \\ -.000 \end{matrix}$
3. For pin/pin and skt/skt, symmetrical layouts only, consult factory for available Contact Arrangements.
4. Performance capabilities

Current Rating:

Size 12 contact	17 amps at 750 VDC
Size 16 contact	10 amps at 750 VDC
Size 20 contact	5 amps at 500 VDC
Size 22 contact	3 amps at 500 VDC

Insulation Resistance:

1000 MegOhms min, at 500 VDC, Between contacts and contacts to shell

Hermeticity:

Less than  $10^{-6}$  cc/sec leakage at 1 atmosphere

SUBSEA/SHALLOW WATER: GEO-MARINE®

