



# HDMI 2.0 CONNECTORS

## MIL-DTL-38999 Series III Type Connectors



### 233-367 HDMI to PC Tail connector receptacle with standoffs



Part Number Development						
Sample Part Number	233-367	NF	00	-17	N	H
Basic Number	233-367					
Finish	See Material and Finish table					
Connector Style	See Connector Style table					
Shell Size	17					
Alternate Key Position <sup>1</sup>	A, B, C, D, E, N = Normal per MIL-DTL-38999					
HDMI Orientation	H = Horizontal V = Vertical					

Material and Finish		
NF		Cadmium, Olive Drab Over Electroless Nickel (500 Hour Salt Spray)
ME	Aluminum	Electroless Nickel (96 Hour Salt Spray)
ZR		Black Zinc-Nickel (Tri-Valent CR)
XM	Composite	Electroless Nickel
Z1	Stainless Steel	Passivate
AB	Marine Bronze	None (Clean Only)

Additional material / finish options available consult factory

Connector Style	
00	Wall mount receptacle with slotted holes
D0	Wall mount receptacle with round holes
CM	Wall mount receptacle with metric clinch nuts
07	Rear panel mount, jam nut receptacle



### DO - WALL MOUNT RECEPTACLE WITH SLOTTED HOLES

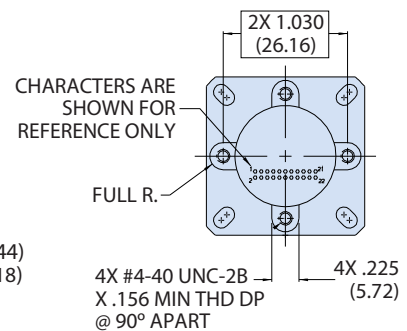
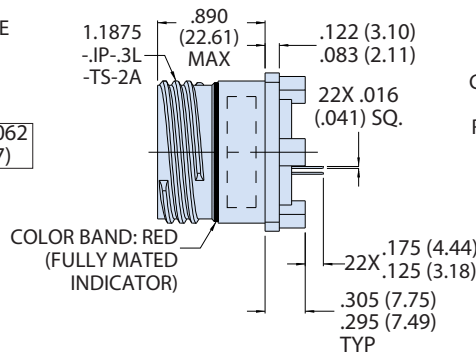
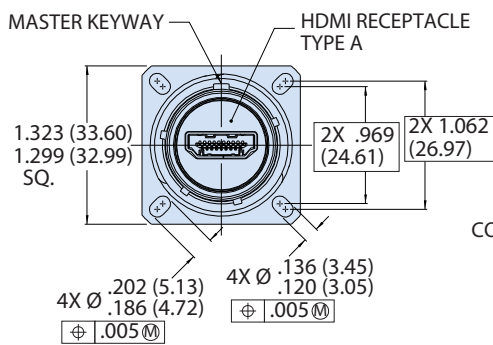

### NOTES

- HDMI Performance: Design meets HDMI 2.0 protocol requirement including 18Gbps of bandwidth and supports 4K resolution and 60Hz.
- Receptacle connector designed to meet IP67 unmated condition.
- HDMI Specifications
  - Performance: See Note 1
  - DWV: 300VAC
  - IR: 100 Mega Ohms MIN
  - Operating Temperature: -20°C to +85°C
- Material and Finish
  - Shell, jam nut: see material finish table
  - Seals: silicone based elastomer
- Hardware: stainless steel/passivated
- HDMI:
  - Housing: thermoplastic/NA
  - Shell: copper alloy nickel plated
  - Terminal: copper alloy/gold plated



N

**DO - WALL MOUNT RECEPTACLE WITH ROUND HOLES**

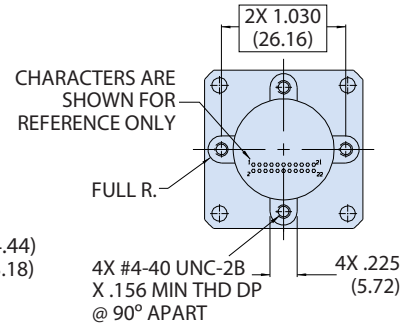
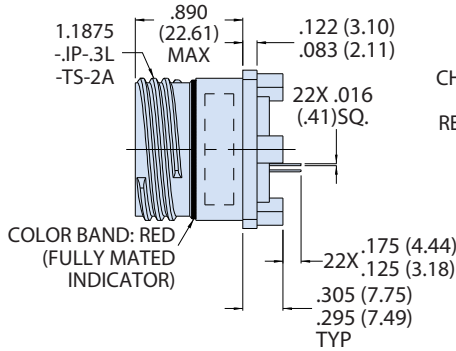
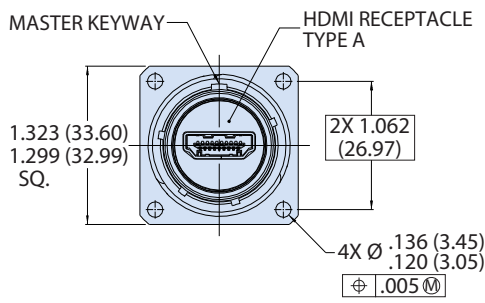

**CM - WALL MOUNT RECEPTACLE WITH METRIC CLINCH NUTS**

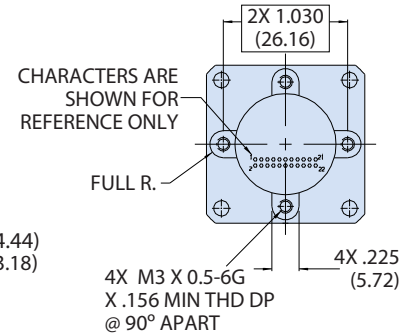
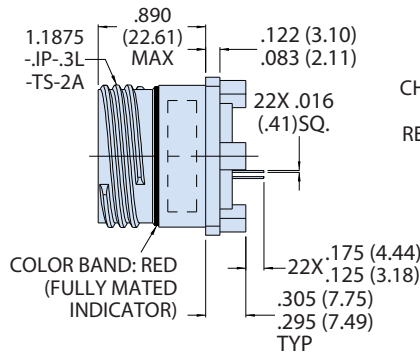
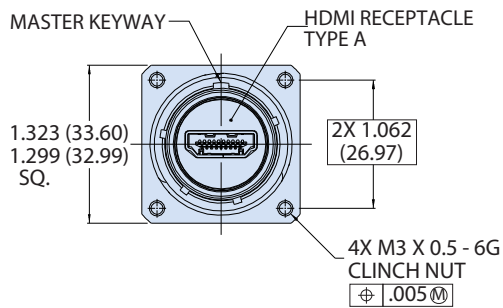

**07 - JAM NUT MOUNT RECEPTACLE**

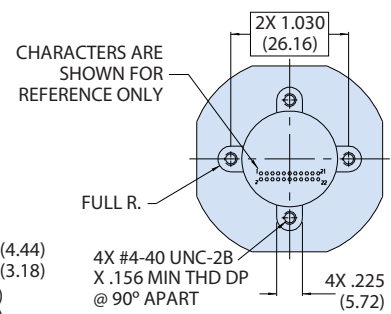
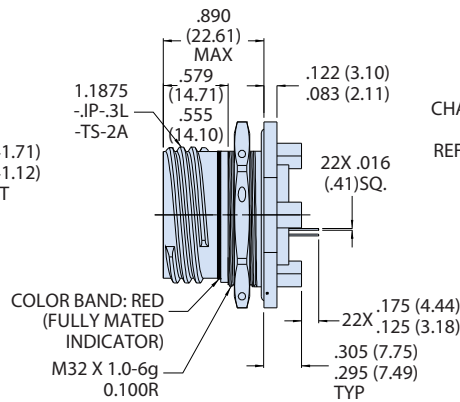
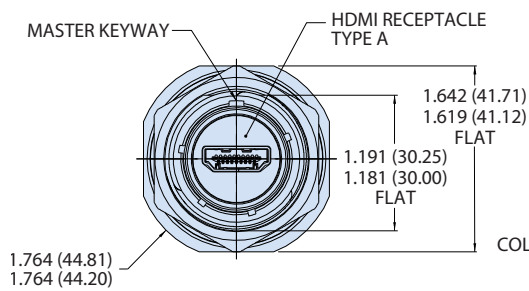



# HDMI 2.0 CONNECTORS

## MIL-DTL-38999 Series III Type Connectors



### 233-367 HDMI to PC Tail connector receptacle with standoffs

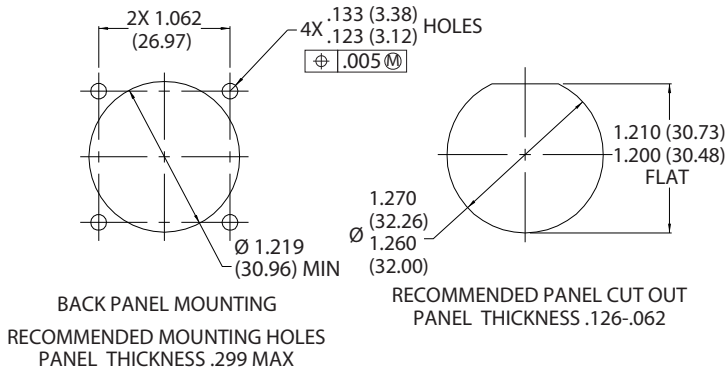

#### HDMI ORIENTATION OPTIONS (PARTIAL VIEWS SHOWN)

