



# RJ45 AND USB 2.0 Contacts, Tools, and Accessories



## 370-007 Cable Sealing Backshell with Rotatable Coupling for 28840 Type Connectors

How To Order									
<b>Sample Part Number</b>	<b>370</b>	<b>G</b>	<b>S</b>	<b>007</b>	<b>M</b>	<b>17</b>	<b>03</b>	<b>D</b>	<b>1.5</b>
<b>Series/Basic Part No.</b>	370 - low Profile								
<b>Connector Designator</b>	G = 28840								
<b>Angular Function</b>	J = 90° H = 45° S = Straight								
<b>Basic Part No.</b>	007								
<b>Finish</b>	See Material and Finish Table								
<b>Shell Size</b>	15, 17, 19								
<b>Dash No.</b>	See Dash Number Table								
<b>Strain Relief Style</b>	D = Nut								
<b>Length</b>	1/2 inch increments (e.g. 6 = 3 inches); Straight only								

MIL-DTL-28840 Type

**Straight (S)**

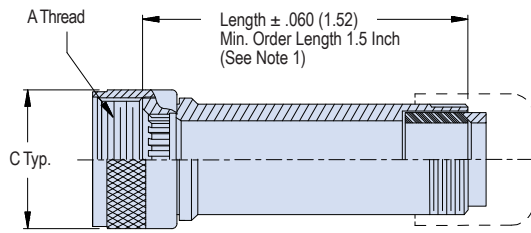

**45° (H)**

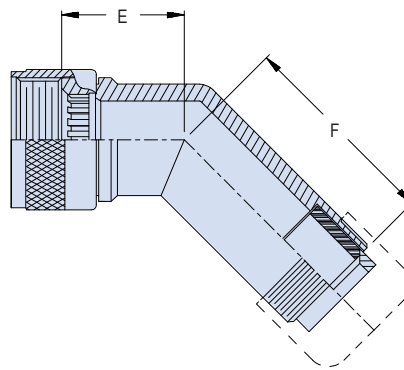

**90° (J)**

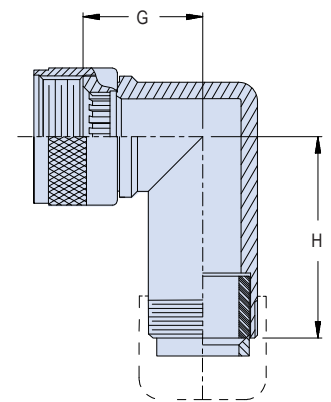

### STRAIN RELIEF STYLE D

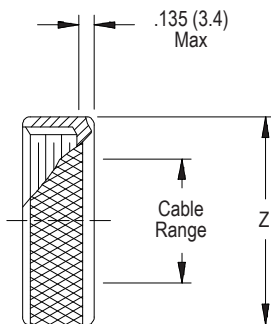

Dimensions						
Shell Size	A Thread	C Typ.	E Max	F Max	G Max	H Max
15	M22 X 1 -- 6H	1.07 (27.2)	.645 (16.4)	2.359 (59.9)	.700 (17.8)	2.369 (60.2)
17	M25 X 1 -- 6H	1.21 (30.7)	.738 (18.7)	2.469 (62.7)	.885 (22.5)	2.459 (62.5)
19	M28 X 1 -- 6H	1.36 (34.5)	.926 (23.5)	2.659 (67.5)	.975 (24.8)	2.629 (66.8)

Materials and Finishes	
NF	Aluminum/ Cadmium, olive drab
M	Aluminum/ Electroless nickel
MT	Aluminum/ Nickel PTFE
ZR	Aluminum/ Zinc-nickel black
ZI	Stainless Steel/ Passivate

Dash Number			
Dash No.	Z Max	Cable Range	
		Min.	Max.
03	.630 (16.0)	.250 (6.4)	.250 (6.4)
04	.755 (19.2)	.312 (7.9)	.312 (7.9)
06	.942 (23.9)	.438 (11.1)	.438 (11.1)

M