



USB 2.0 TYPE A

Series IPT (26482 Type) Bayonet Coupler



IPT342 Receptacle with USB Female Interface to PC Tail Termination

G



How to Order							
Sample Part Number	IPT342	02	16	2	A	H	F6
Basic Number	IPT342						
Connector Style¹	02 = Wall Mount Receptacle 07 = Rear Panel Mount Jam Nut Receptacle						
Shell Size	16						
USB Performance	2 = 2.0						
USB Type	A = Type A						
Orientation Option	H = Horizontal V = Vertical						
Material/Finish	Omit for Cadmium/Olive Drab F6 = Black Polymer Electrocoat F7 = Conductive Black Zinc Nickel F11 = Electroless Nickel						

USB Orientation Options

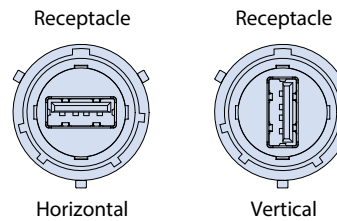

RECOMMENDED PCB LAYOUT

Receptacle USB 2.0 / Type A
(Horizontal Orientation)

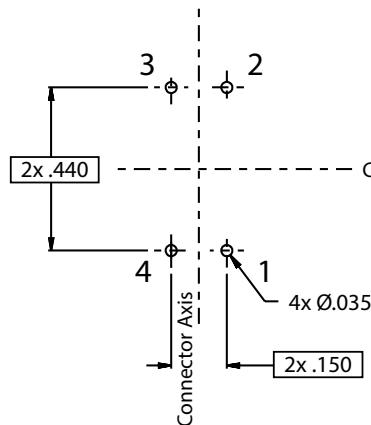

Recommended
(Solder Side)

Receptacle USB 2.0 / Type A
(Vertical Orientation)

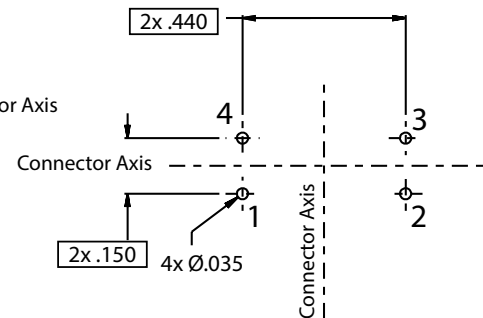

Recommended
(Solder Side)

NOTES

1. See Section A for panel cutout dimensions



USB 2.0 TYPE A
Series IPT (26482 Type) Bayonet Coupler
 IPT342 Receptacle with
 USB Female Interface to PC Tail Termination



02 - WALL MOUNT RECEPTACLE

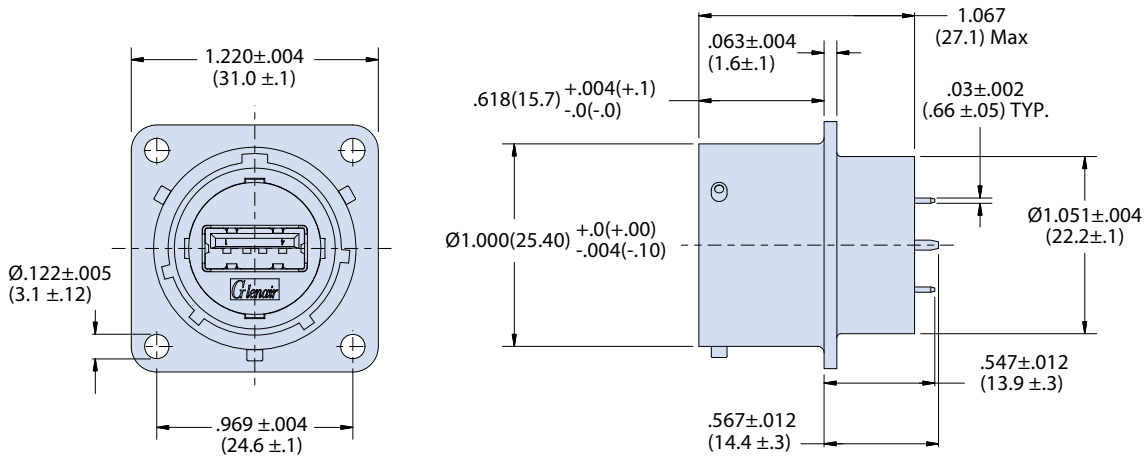

07 - REAR PANEL MOUNT JAM NUT RECEPTACLE

