

882-021 PC Tail, Panel Mount Plug, Push-Pull QDC Coupling

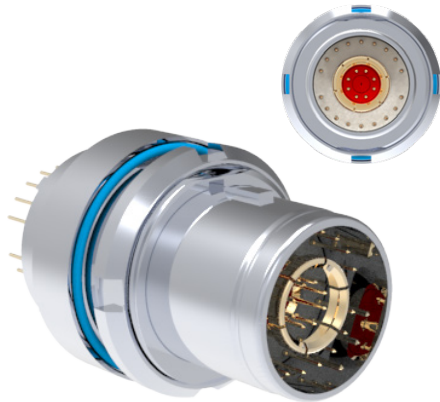

HDMI 2.0 and DisplayPort 1.2. Ultraminiature. Rear panel mount. PCB connector.

882-021 SuperFly Datalink plugs have one El Ochito® octaxial contact ringed by eighteen discrete pin contacts. Attach to .125" (3.17 mm) maximum thickness panel with spanner nut. PC tail contacts are gold plated or solder dipped in 63/37 tin-lead. Contacts are epoxy-sealed and are non-removable. Fluorosilicone O-rings for water-tight seal. *Mates to 882-020 and 882-022.*

SIZE AND WEIGHT SAVING

- .805 inch (20.45 mm.) diameter

HIGH SPEED

- HDMI and DisplayPort
- El Ochito® Technology

HARSH ENVIRONMENT

- EMI protection
- Water ingress
- Shock and vibration

Recommended PC Board Layout

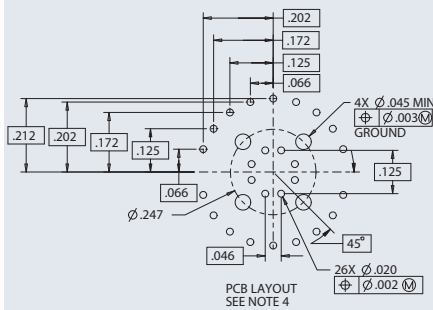

for optimal performance, see Glenair application note AN0002

How To Order PCB Plugs for HDMI and DisplayPort

Sample Part Number	882-021	- Z2	S	-.080
Product	882-021 = Panel Mount PC Tail Plug			
Shell Finish	M = Electroless Nickel (aluminum shell) MT = Nickel-PTFE (aluminum shell) ZR = Black Zinc-Nickel (aluminum shell) Z2 = Gold (aluminum shell) ZMT = Nickel-PTFE (stainless steel shell)			
PC Tail Finish	S = Solder dip, 63/37 tin-lead G = Gold			
PC Tail Length	.080 = .080" (2.03 mm.) .175 = .175" (4.45 mm.)	.125 = .125" (3.18 mm.) .200 = .200" (5.08 mm.)		

Recommended Panel Cutout

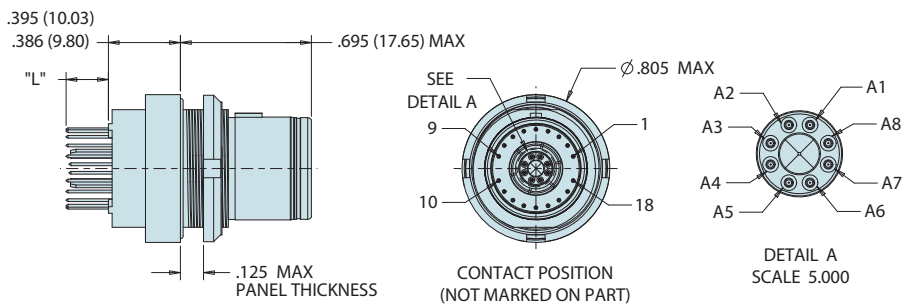
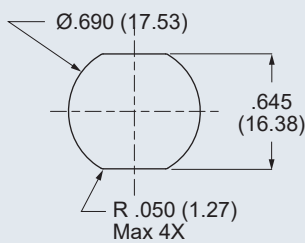

Specifications

- Operating temp.: -65° to +175°C
- Impedance: 100 ohms
- DWV: 500 Vrms unmated
- Current Rating: 1.5 A
- IR: 1000 MΩ min.
- Durability: 2000 mating cycles
- Ingress protection: IP67

Construction

- Shell, jam-nut: aluminum alloy or SST
- Insulators: low-dielectric material
- Contacts: copper alloy, 50 microinches gold over nickel plating
- O-rings: fluorosilicone blend
- Potting: epoxy

Spanner Nut Tightening Tool

Nickel-plated tool steel alloy, ¼" sq. drive
 23 - 28 in.-lbs. recommended torque



600-272-A

