



# RUGGED REVERSE-BAYONET Super ITS-IFO B High-Speed High-Data Rate Fiber Optic Connectors



## 4-Pole Fiber Optic Connector and Backshell



### Super ITS - IFO B 4-pole, size 16S connectors with environmental backshell

Super ITS - IFO B fiber optic connectors deliver ruggedized high-speed, high data rate I/O interconnect performance in extreme environmental conditions. Designed to optimize high fiber tensile strength, axial alignment, and resistance to micro-bending for improved optical performance. An environmental backshell is available. Receptacle shell styles include wall-mount, box-mount, and in-line.

SUPER ITS: HIGH-SPEED, HIGH DATA-RATE

| Connector Technical Characteristics       |  |
|---|--|
| Property                                  | Description  |
| Connection                                | Fiber Optic  |
| Fiber Type                                | 9/125 - 50/125 - 62/125  |
| Insertion Loss [DB]                       | ≤ 1.4 dB   |
| Working Temperature                       | -25° to +85° C   |
| Flammability                              | UL94-V0  |
| Insert                                    | Thermoplastic Resin  |
| Shell                                     | Aluminum Alloy; see Material/Finish table for available platings |
| Mating Cycles                             | 500 Cycles   |
| Environmental Rating                      | IP67 (mated)   |
| Gaskets and Bushings                      | Polychloroprene and Silicone Rubber                              |
| Optical Contact Technical Characteristics |  |
| Optical Contacts                          | Zirconia ferrules  |
|   | Stainless steel springs  |
|   | Zirconia split sleeves   |
| Ferrule Diameter                          | 2.5 mm   |

| How To Order        |   |    |     |    |   |   |       |    |
|---------------------|---|----|-----|----|---|---|-------|----|
| Sample Part Number: | IFO B   | 00 | 16S | -4 | M | 9 | SRSW1 | F7 |
| Series              | IFO B = ITS MIL-DTL-5015 Type fiber optic reverse bayonet coupling  |    |     |    |   |   |       |    |
| Shell Style         | See shell style table   |    |     |    |   |   |       |    |
| Shell Size          | 16S   |    |     |    |   |   |       |    |
| Number of Fibers    | 4   |    |     |    |   |   |       |    |
| Contact Gender      | M = Male F = Female   |    |     |    |   |   |       |    |
| Fiber Type          | 9 = Single mode 9/125<br>50 = Multimode 50/125<br>62.5 = Multimode 62.5/125   |    |     |    |   |   |       |    |
| Backshell           | SRSW1 = Environmentally sealed backshell  |    |     |    |   |   |       |    |
| Material / Finish   | Omit for aluminum / cadmium olive drab<br>F6 = Aluminum / black electrodeposited paint<br>F7 = Aluminum / black zinc nickel |    |     |    |   |   |       |    |

| Connector Shell Styles |  |
|------------------------|--|
| Code                   | Description  |
| 00                     | Front panel-mount, wall-mount receptacle with through-holes and accessory threads. |
| 01                     | In-line receptacle   |
| 02                     | Front panel-mount, box-mount receptacle with through-holes, no accessory threads.  |
| 06                     | Plug   |

| Backshell Option   |       |
|--|-------|
| Description  | Style |
| SRSW1<br>Environmental Sealing Backshell for use with jacketed cable |       |



# RUGGED REVERSE-BAYONET Super ITS-IFO B High-Speed High-Data Rate Fiber Optic Connectors



## 4-Pole Fiber Optic Connector and Backshell

Glenair Super ITS - IFO B Fiber Optic reverse bayonet, shell size 16S connectors offer a four-pole fiber optic interconnect solution packaged in a rugged, reverse-bayonet design with integrated environmental sealing. Connectors with accessory threads may be outfitted with an SRSW1 environmentally-sealed backshell for jacketed cable designed to prevent bending of fiber optic media. Protective covers are available for use at all times when connectors are in unmated condition.

| Fiber Optic Contacts |            |
|----------------------|------------|
| Contact              | Dimensions |
| Male                 |            |
| Female               |            |

### SHELL STYLE 02: FRONT PANEL-MOUNT, BOX MOUNT RECEPTACLE WITH THROUGH HOLES, NO ACCESSORY THREADS

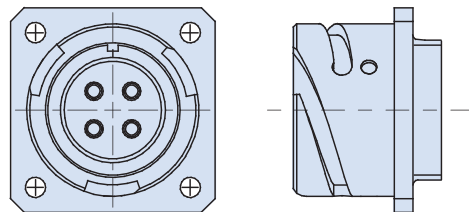

|   |
|---|
| <b>Part Number Options</b>  |
| <b>Contact Gender</b>   |
| M = Male<br>F = Female  |
| <b>Fiber Type</b>   |
| 9 - Single mode 9/125<br>50 - Multimode 50/125<br>62.5 - Multimode 62.5/125   |
| <b>Backshell</b>  |
| None available  |
| <b>Material / Finish</b>  |
| Omit for aluminum/cadmium olive drab<br>F6 = Aluminum/black electrodeposited paint; RoHS<br>F7 = Aluminum/black zinc nickel; RoHS |

### Sample Part Number

|              |             |            |               |                |            |           |                   |
|--------------|-------------|------------|---------------|----------------|------------|-----------|-------------------|
| <b>IFO B</b> | <b>02</b>   | <b>16S</b> | <b>-4</b>     | <b>M</b>       | <b>9</b>   |           | <b>F7</b>         |
| ITS Series   | Shell Style | Shell Size | No. Of Fibers | Contact Gender | Fiber Type | Backshell | Material / Finish |

SUPER ITS: HIGH-SPEED, HIGH DATA-RATE

**B**



# RUGGED REVERSE-BAYONET Super ITS-IFO B High-Speed High-Data Rate Fiber Optic Connectors



## 4-Pole Fiber Optic Connector and Backshell

### SHELL STYLE 00: FRONT PANEL-MOUNT, WALL-MOUNT RECEPTACLE WITH THROUGH-HOLES AND ENVIRONMENTAL CABLE SEALING BACKSHELL WITH STRAIN RELIEF; FOR USE WITH JACKETED CABLE

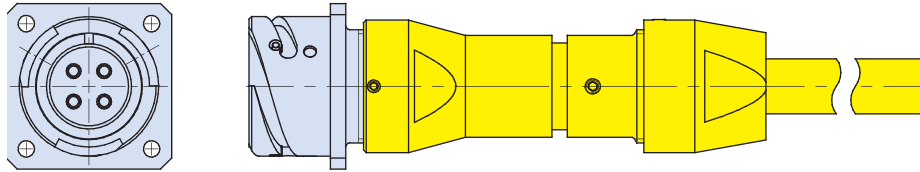

| Sample Part Number |             |            |               |                |            |                   |                   |
|--------------------|-------------|------------|---------------|----------------|------------|-------------------|-------------------|
| <b>IFO B</b>       | <b>00</b>   | <b>16S</b> | <b>-4</b>     | <b>M</b>       | <b>9</b>   | <b>SRSW1</b>      | <b>F7</b>         |
| ITS Series         | Shell Style | Shell Size | No. Of Fibers | Contact Gender | Fiber Type | Material / Finish | Material / Finish |

### SHELL STYLE 01: IN-LINE RECEPTACLE AND ENVIRONMENTAL CABLE SEALING BACKSHELL WITH STRAIN RELIEF; FOR USE WITH JACKETED CABLE

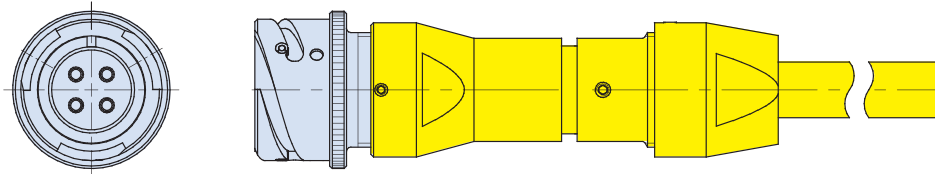

| Sample Part Number |             |            |               |                |             |                   |                   |
|--------------------|-------------|------------|---------------|----------------|-------------|-------------------|-------------------|
| <b>IFO B</b>       | <b>01</b>   | <b>16S</b> | <b>-4</b>     | <b>M</b>       | <b>62.5</b> | <b>SRSW1</b>      | <b>F7</b>         |
| ITS Series         | Shell Style | Shell Size | No. Of Fibers | Contact Gender | Fiber Type  | Material / Finish | Material / Finish |

### SHELL STYLE 06: PLUG AND ENVIRONMENTAL CABLE SEALING BACKSHELL WITH STRAIN RELIEF; FOR USE WITH JACKETED CABLE

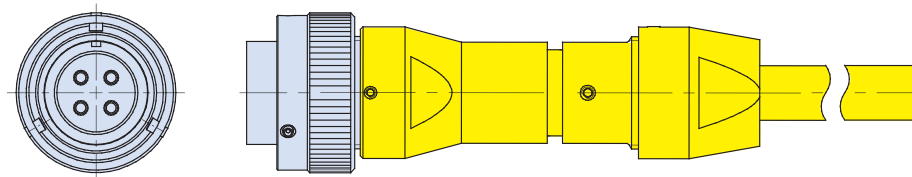

| Sample Part Number |             |            |               |                |            |                   |                   |
|--------------------|-------------|------------|---------------|----------------|------------|-------------------|-------------------|
| <b>IFO B</b>       | <b>06</b>   | <b>16S</b> | <b>-4</b>     | <b>M</b>       | <b>50</b>  | <b>SRSW1</b>      | <b>F7</b>         |
| ITS Series         | Shell Style | Shell Size | No. Of Fibers | Contact Gender | Fiber Type | Material / Finish | Material / Finish |

| Part Number Options  |
|--|
| <b>Contact Gender</b>  |
| <b>M</b> = Male<br><b>F</b> = Female   |
| <b>Fiber Type</b>  |
| <b>9</b> - Single mode 9/125<br><b>50</b> - Multimode 50/125<br><b>62.5</b> - Multimode 62.5/125   |
| <b>Backshell</b>   |
| <b>SRSW1</b> = environmentally sealed backshell with fiber retention strain relief. For use with jacketed cable. Omit for none                         |
| <b>Material / Finish</b>   |
| <b>Omit</b> for aluminum/cadmium olive drab<br><b>F6</b> = Aluminum/black electrodeposited paint; RoHS<br><b>F7</b> = Aluminum/black zinc nickel; RoHS |

SUPER ITS: HIGH-SPEED, HIGH DATA-RATE

B