

StarShield™ “Star”

Order No.	Shell/Entry Size (See note 3)	A Dia Max	No. of Cavities	Style	
11	10/11	-	2	1	
13	12/13	-	3		
15	14/15	.118 (3)	5		
17	16/17	.236 (6)	6		
19	18/19	.354 (9)	7		
21	20/21	.472 (12)	9		
218	20/21	.472 (12)	8		
23	22/23	.591 (15)	10		
25	24/25	.708 (18)	12		
2914	28/29	.979 (25)	14		
3318	32/33	1.097 (28)	18		
177	16/17		7		2
2111	20/21		11		
2313	22/23		13		
2514	24/25		14		
2515	24/25		15		
2517	24/25		17		
2922	28/29		22		
2925	28/29		25		
3328	32/33		28		
3331	32/33		31		

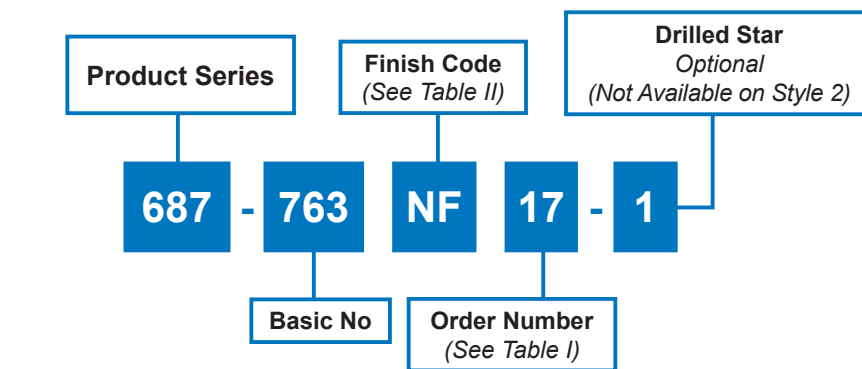

Code	Finish Description
M	Electroless nickel
NF	Cad/O. D. Over electroless nickel (1000 hour salt spray)
Z1	Stainless steel/passivate
ZR	Aluminum/zinc-nickel, black
ZM	Stainless steel/ electroless nickel

Notes:

1. Assembly to be bagged and tagged with manufacturer's name and part number.
2. Material/finish: Al alloy or CRES/see Table I
3. Shell size shall be used for 470-013. Entry size shall be used for 470-019/020
4. 687-763 series star to be used with : 687-841-01M, 687-764-02M, 687-764-04M, and 687-809-03M. These stars will fit a .200 outer diameter.

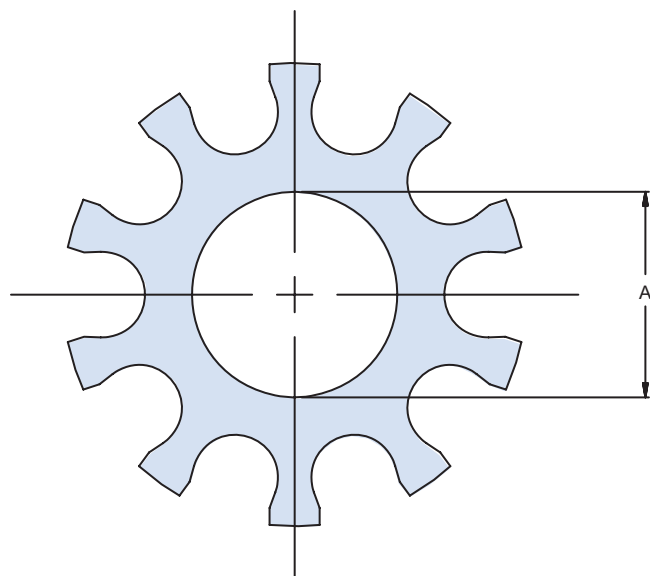

STYLE 1
Single Solid Star

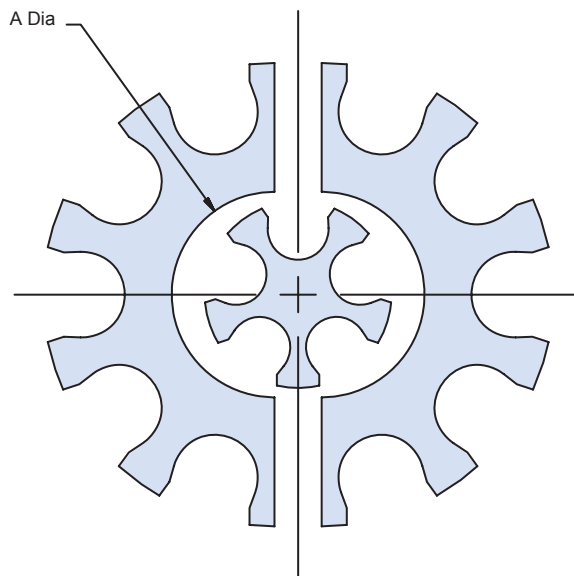

STYLE 2
Split Outer Star and
Solid Inner Star

Dimensions in inches (millimeters) and are subject to change without notice.