

MIL-PRF-24758-58

Adapter for Series 80 Mighty Mouse Connectors To M24758-2, -3, or -4 Conduit Fittings

A

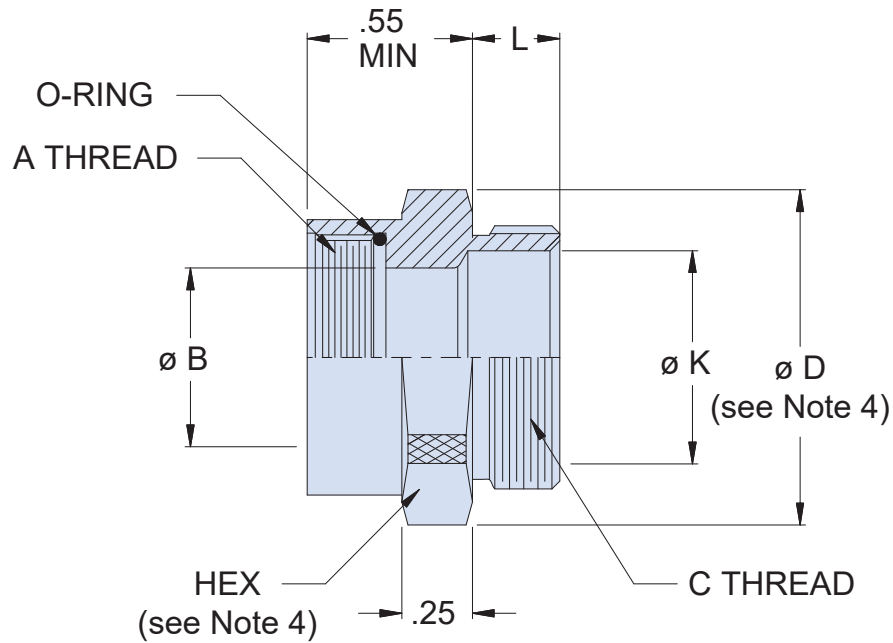
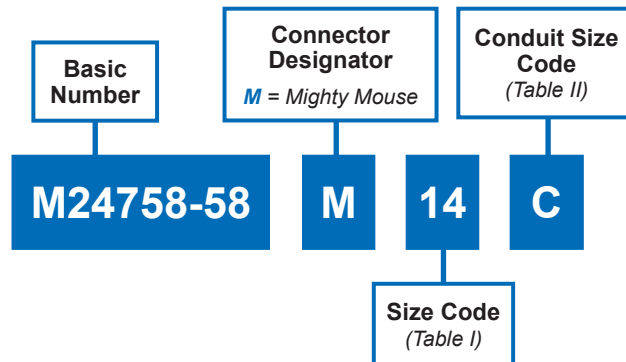

MIL-PRF-24758-58
Adapter for Series 80 Mighty Mouse Connectors
To M24758-2, -3, or -4 Conduit Fittings



MIL-PRF
24758A

A

TABLE I: Order No., Shell Size, Thread, Dimensions and Max Conduit Size Code

SIZE CODE	SHELL SIZE REF		A THREAD CLASS - 2B	B DIA	HEX SEE NOTE 4	D DIA MAX	MAX CONDUIT SIZE CODE SEE NOTE 3
	800 / 801 803 / 804	805					
05	05	N/A	1/4-32 UNEF	.172 (4.37)	.562 (14.27)	.63 (16.00)	J
06	06	N/A	5/16-32 UNEF	.234 (5.94)	.562 (14.27)	.63 (16.00)	
11	N/A	08	3/8-32 UNEF	.266 (6.76)	.562 (14.27)	.63 (16.00)	B
07	07	09	7/16-28 UNEF	.325 (8.25)	.562 (14.27)	.63 (16.00)	
08	08	10	1/2-28 UNEF	.385 (9.78)	.625 (15.88)	.70 (17.78)	K
09	09	11	9/16-24 UNEF	.445 (11.30)			
10	10	12	5/8-24 UNEF	.512 (13.00)	.750 (19.05)	.83 (21.08)	C
12	11/12 /13	N/A	11/16-24 UNEF	.594 (15.09)	.812 (20.62)	.90 (22.86)	
13	N/A	15	3/4-20 UNEF	.625 (15.88)			
14	14/15 16/17	18/19	15/16-20 UNEF	.812 (20.62)	1.000 (25.40)	1.10 (27.94)	D
16	19	21	1 1/16-18 UNEF	.938 (23.83)	1.188 (30.18)	1.30 (33.02)	E
17	21	23	1 3/16-18 UNEF	1.057 (26.85)	1.375 (34.93)	1.50 (38.10)	

TABLE II: Conduit Size Code

CONDUIT SIZE CODE	C CLASS - 2A THREAD	L +.03 -.00	K DIA MIN.	HEX SEE NOTE 4	D DIA MAX. SEE NOTE 4
A	.438-28 UNEF	.21 (5.33)	.245 (6.22)	.562 (14.27)	.63 (16.00)
J	.563-24 UNEF	.25 (6.35)	.370 (9.40)	.688 (17.48)	.77 (19.56)
B	.688-24 UNEF	.25 (6.35)	.495 (12.57)	.875 (22.23)	.97 (24.64)
K	.813-20 UNEF	.31 (7.87)	.620 (15.75)	.937 (23.80)	1.04 (26.42)
C	.938-20 UNEF	.31 (7.87)	.745 (18.92)	1.125 (28.58)	1.24 (31.50)
D	1.250-18 UNEF	.37 (9.40)	.995 (25.27)	1.375 (34.92)	1.51 (38.35)
E	1.563-18 UNEF	.37 (9.40)	1.245 (31.62)	1.687 (42.85)	1.84 (46.74)

APPLICATION NOTES

1. Assembly identified with manufacturer's name and part number, space permitting.
2. M24758-58 adapts Series 80 Mighty Mouse connectors to M24758-2, M24758-3, or M24758-4 conduit fittings.
3. Consult factory for availability when Max Conduit Size Code is exceeded.
4. The larger Hex and "D" Dia dimensions from Table I or II will be used (e.g. M24758-58M09K has .937" Hex and 1.04" Max Dia) (e.g. M24758-58M09A has .625" Hex and .70" Max Dia)
5. Material / Finish:
Adapter - 316L SST/Electroless Nickel, matte finish
O-Ring - Silicone/N.A.
6. Metric dimensions (mm) are indicated in parentheses.