

# 557-175 D-Subminiature G-Spring Solid Backshell

**557 T 175 M 2 F0 B 1 F 02**  
 Basic Part No. ————  
 Cable Entry Style ————  
     T = Top  
 Basic Part Number ————  
 Finish Symbol (Page 3) ————  
 Shell Size (Table I) ————  
 Receptacle Mounting (Table II) ————  
     F0 = Front Mounting  
     R1-R9 = Rear Mounting  
 Inner Support Ring Dash No. (Table III), N = No Support Ring  
 F = Strain Relief, G = Gland Nut,  
 D = Dual "G" Spring With Strain Relief  
 0 = Without EMI Gasket,  
 1 = With EMI Gasket  
 Jackscrew Type (Page A-4)

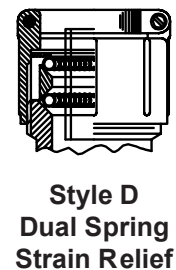

# 557-175 D-Subminiature G-Spring Solid Backshell

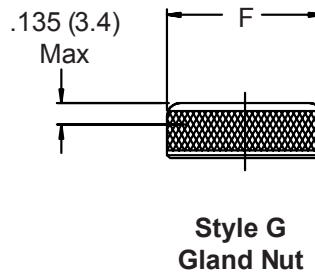
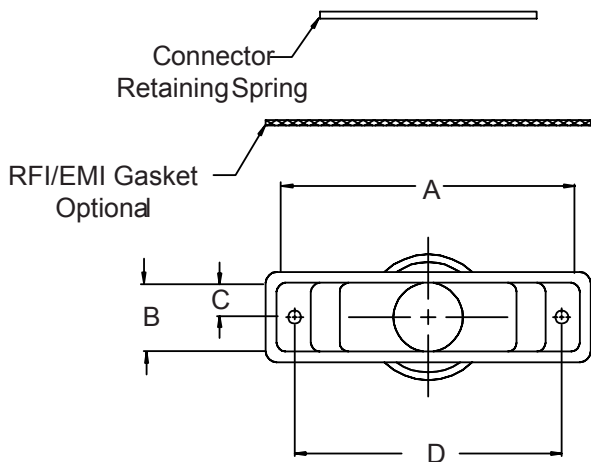
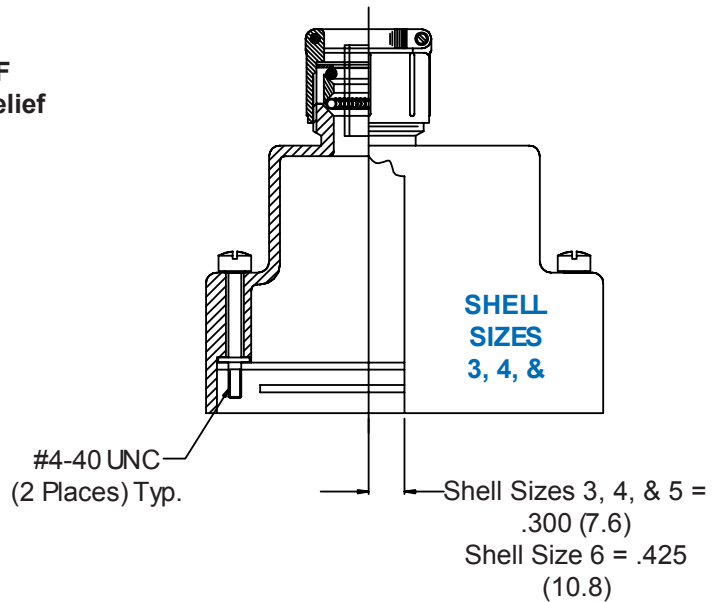
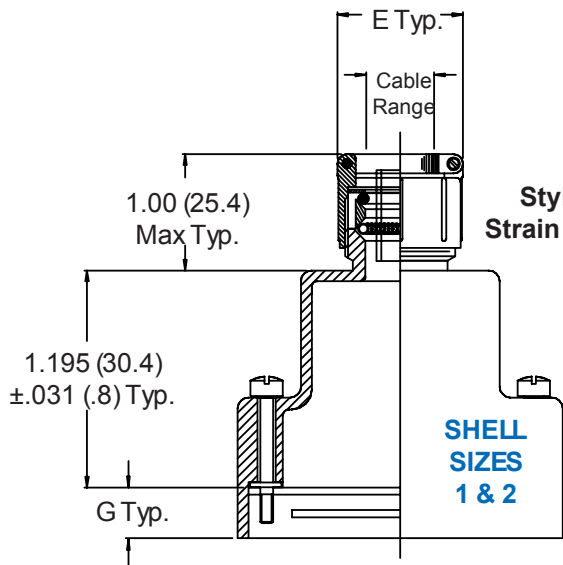

MIL-DTL-24308  
D-Subminiature

**TABLE I: SHELL SIZE & CONNECTOR INTERFACE DIMENSIONS**

| Shell Size | Com'l          |              | A           | B          | C            | D |
|------------|----------------|--------------|-------------|------------|--------------|---|
|            | Shell Size Ref |              |             |            |              |   |
| 1          | E/09           | 1.241 (31.5) | .515 (13.0) | .258 (6.6) | .984 (25.0)  |   |
| 2          | A/15           | 1.569 (39.9) | .515 (13.0) | .258 (6.6) | 1.312 (33.3) |   |
| 3          | B/25           | 2.116 (53.7) | .515 (13.0) | .258 (6.6) | 1.852 (47.0) |   |
| 4          | C/37           | 2.757 (70.0) | .515 (13.0) | .258 (6.6) | 2.500 (63.5) |   |
| 5          | D/50           | 2.663 (67.6) | .625 (15.9) | .313 (8.0) | 2.406 (61.1) |   |
| 6          | F/104          | 2.757 (70.0) | .688 (17.5) | .344 (8.7) | 2.500 (63.5) |   |

**TABLE I (Continued): CABLE ENTRY & GLAND NUT**

| Shell Size | Com'l          |              | E Max        | F Max       | Cable Range |     |
|------------|----------------|--------------|--------------|-------------|-------------|-----|
|            | Shell Size Ref |              |              |             | Min         | Max |
|            |                |              |              |             |             |     |
| 2          | A/15           | .968 (24.6)  | .750 (19.1)  | .156 (4.0)  | .375 (9.5)  |     |
| 3          | B/25           | 1.156 (29.4) | 1.000 (25.4) | .280 (7.1)  | .500 (12.7) |     |
| 4          | C/37           | 1.156 (29.4) | 1.000 (25.4) | .280 (7.1)  | .500 (12.7) |     |
| 5          | D/50           | 1.218 (30.9) | 1.250 (31.8) | .375 (9.5)  | .625 (15.9) |     |
| 6          | F/104          | 1.468 (37.3) | 1.375 (34.9) | .625 (15.9) | .875 (22.2) |     |

**TABLE II: RECEPTACLE MOUNTING**

| Dash No. | Panel Thickness |       | G    |       |
|----------|-----------------|-------|------|-------|
| R1       | .031            | (.8)  | .247 | (6.3) |
| R2       | .047            | (1.2) | .231 | (5.9) |
| R3       | .062            | (1.6) | .216 | (5.5) |
| R4       | .093            | (2.4) | .185 | (4.7) |
| R5       | .104            | (2.6) | .174 | (4.4) |
| R6       | .125            | (3.2) | .153 | (3.9) |
| R7       | .156            | (4.0) | .125 | (3.2) |
| R8       | .135            | (3.4) | .140 | (3.6) |
| F0       | N/A             |       | .305 | (7.7) |

**TABLE III: SUPPORT RING**

| Dash No. | Inner Support |             |
|----------|---------------|-------------|
|          | I.D.          | O.D.        |
| 01       | .187 (4.7)    | .227 (5.8)  |
| 02       | .218 (5.5)    | .258 (6.6)  |
| 03       | .250 (6.4)    | .290 (7.4)  |
| 04       | .281 (7.1)    | .321 (8.2)  |
| 05       | .312 (7.9)    | .352 (8.9)  |
| 06       | .343 (8.7)    | .383 (9.7)  |
| 07       | .375 (9.5)    | .415 (10.5) |
| 08       | .406 (10.3)   | .446 (11.3) |
| 09       | .438 (11.1)   | .478 (12.1) |
| 10       | .468 (11.9)   | .508 (12.9) |

1. Metric dimensions (mm) are indicated in parentheses.
2. **DO NOT USE CONNECTORS WITH FLOAT MOUNTINGS.**
3. For front mount, mating connector must be mounted to panel using M24308/26 female screwlocks. For rear mount, use Glenair GK134.
4. For proper termination it is recommended that Glenair 469-001 shield support ring be used on all assemblies. Place ring over wire bundle and under shield, position under G-Spring.