

**Wiring Instructions - Receptacle Connector - Example: Size 03**

Valid for all kinds of backends

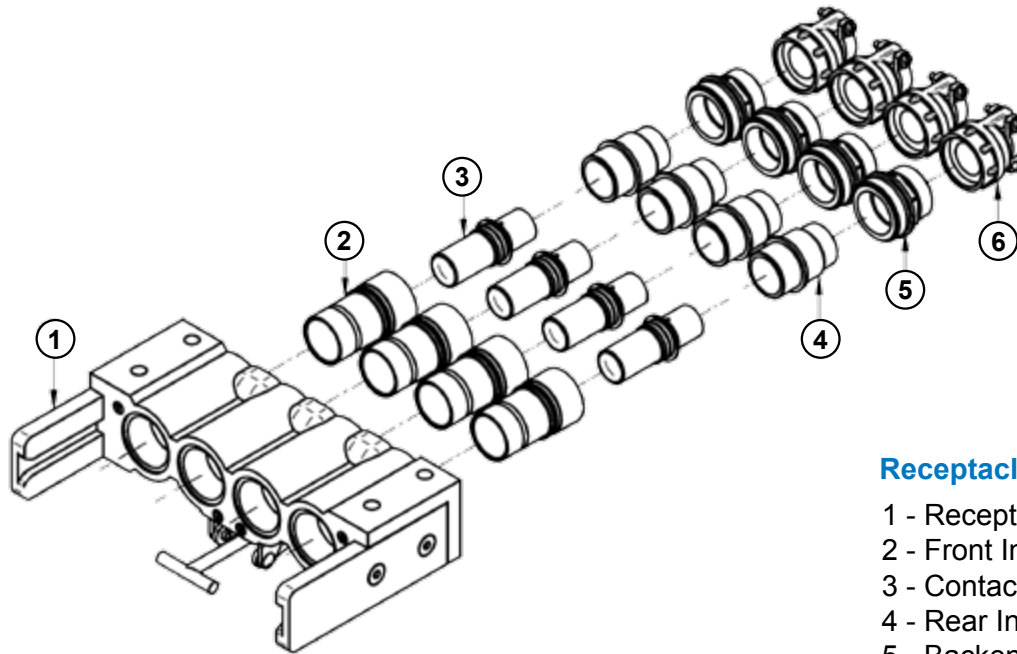

Valid for all sizes

**Receptacle Connector**

- 1 - Receptacle Shell
- 2 - Front Insert
- 3 - Contact
- 4 - Rear Insert
- 5 - Backend Adapter
- 6 - Clamp

**Step 1**

**TABLE 2**

Contact Type	B (mm)
1	20.0
2	20.0
3	20.0
4	21.0
5	29.0

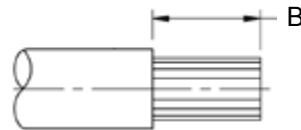

Cut and strip the cable (See TABLE 2).

**Step 2**

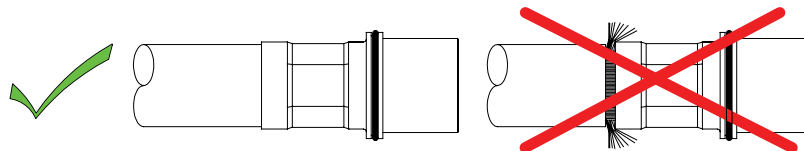

Crimp contacts (3) on conductors.

**IRT Series**  
**Rectangular Multi Pole Power Connector**  
 Wiring Instructions - Receptacle Connector - Example: Size 03



**Step 3**

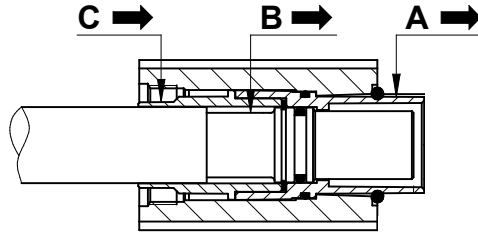

Put the front insert (2) into the body. Insert the contact (3) crimped into the front insert (2). Install the rear insert (4).

**Step 4**

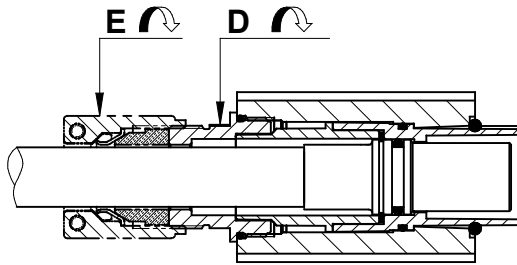

Tightening Torque	
Size	Value (Nm Max)
1	30.0
2 - 3	30.0
4	35.0
5	35.0

Screw the backend onto the rear of the receptacle and tighten.

**Step 5**

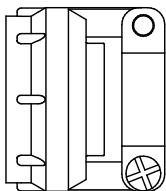

Tightening Torque	
Size	Value (Nm Max)
1	9.0
2 - 3	9.0
4 - 5	13.0

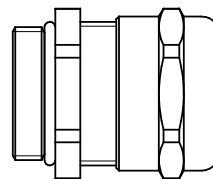

Tightening Torque	
Size	Value (Nm Max)
1	8.0
2 - 3	8.0
4 - 5	18.0

Screw the clamp onto the backend and tighten.  
 Electrical Test: Insulation resistance 5000 Mohm (Min).  
 Test Voltage: 3000 Vac according with the arrangement.