

## 600HH005 Plug and Receptacle Holder MIL-DTL-38999 Series IV

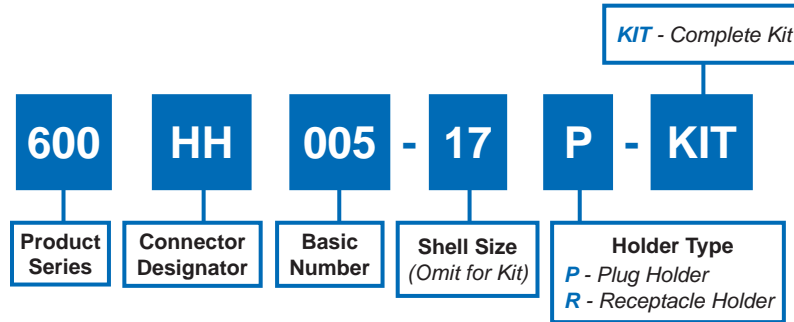

**NO POLARIZATION REQUIRED**

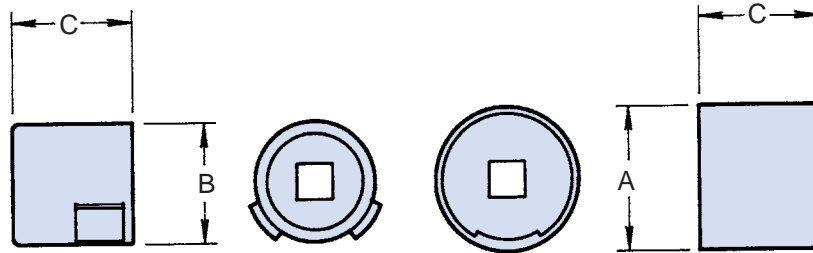

PLUG HOLDER

RECEPTACLE HOLDER

**TABLE I: Dash Number, Torque and Dimensions**

Shell Size		Max Torque (Inch Pounds)	A Dia Max	B Dia Max	C Dim Max
Commercial	Military Ref				
11	B	80	.830 (21.1)	.515 (13.1)	1.280 (32.5)
13	C	110	.950 (24.1)	.650 (16.5)	1.280 (32.5)
15	D	120	1.070 (27.2)	.775 (19.7)	1.280 (32.5)
17	E	120	1.200 (30.5)	.901 (22.9)	1.280 (32.5)
19	F	120	1.280 (32.5)	1.015 (25.8)	1.280 (32.5)
21	G	140	1.400 (35.6)	1.140 (29.0)	1.280 (32.5)
23	H	140	1.530 (38.9)	1.265 (32.1)	1.280 (32.5)
25	J	140	1.660 (42.2)	1.392 (35.4)	1.280 (32.5)

**APPLICATION NOTES**

1. Metric dimensions (mm) are indicated in parentheses.
2. Material: Case hardened carbon steel with electroless nickel finish.
3. Receptacle and plug holder drives: 1/4" - Shell sizes 11 and 13; 3/8" - Shell sizes 15 and up.

Dimensions in inches (millimeters) and are subject to change without notice.