

MIL-DTL-38999 Series III Type

233-265 Receptacles with removable crimp contacts

Part Number Development									
Sample Part Number	233-265				-H2	Z1	17-26	P	N
Series / Basic Part No.	Series 23 SuperNine Hermetic								
Connector Style	H2 = Wall Mount with Accessory Threads BH2 = Wall Mount with integral Banding Porch H8 = Weld Mount with Accessory Threads BH8 = Weld Mount with Banding Porch								
Finish*	Z1 = CRES, Passivated ZL = CRES, Nickel Finish								
Shell Size/Insert Arrangement*	Per MIL-DTL-38999/MIL-STD-1560								
Contact Style	P = Pin S = Socket								
Polarization*	A, B, C, D, E, N = Normal								

*Refer to Section A for standard insert arrangements and pages D-8 thru D-10 for special shielded contact arrangements, consult factory for additional options
 Modification codes may be added directly to the end of any valid part number

Minor Keyway Position					
Shell Sizes	POS	A°	B°	C°	D°
9	N	105	140	215	265
	A	102	132	248	320
	B	80	118	230	312
	C	35	140	205	275
	D	64	155	234	304
11 13 15	N	95	141	208	236
	A	113	156	182	292
	B	90	145	195	252
	C	53	156	220	255
	D	119	146	176	298
17 19 21 23 25	N	80	142	196	293
	A	135	170	200	310
	B	49	169	200	244
	C	66	140	200	257
	D	62	145	180	280
E	79	153	197	272	

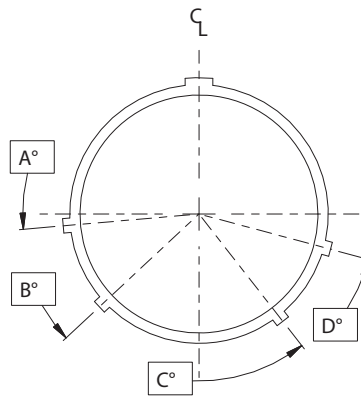

FACE VIEW - RECEPTACLE

Material/finish:

- Shell receptacle - 300 series CRES/see part number development
- Pin contact - alloy 52/gold plated
- Socket contact - copper alloy/gold plated
- Insulator hermetic - fused vitreous glass
- Insulators - high grade rigid dielectric
- Seals - fluorosilicone

NOTES

1. Hermeticity: 1×10^{-7} ccHe/sec @ 1 ATM, delta pressure
2. Crimp removable socket contacts to conform to SAE AS39029/57-359 (# 12), AS39029/57-358 (# 16), AS39029/57-357 (# 20) and AS39029/57-354 (# 22D) or Glenair 809-002 socket (#23) (supplied loose).

DWV Voltage Levels At Sea Level	
SERVICE RATING	VOLTAGE AC RMS 60HZ
M	1300 VAC
I	1800 VAC
II	2300 VAC
N	1000 VAC

MIL-DTL-38999 Series III Type

233-265 Receptacles with removable crimp contacts

HERMETIC CONNECTORS

233-265-H2 AND BH2 BOX MOUNT RECEPTACLE

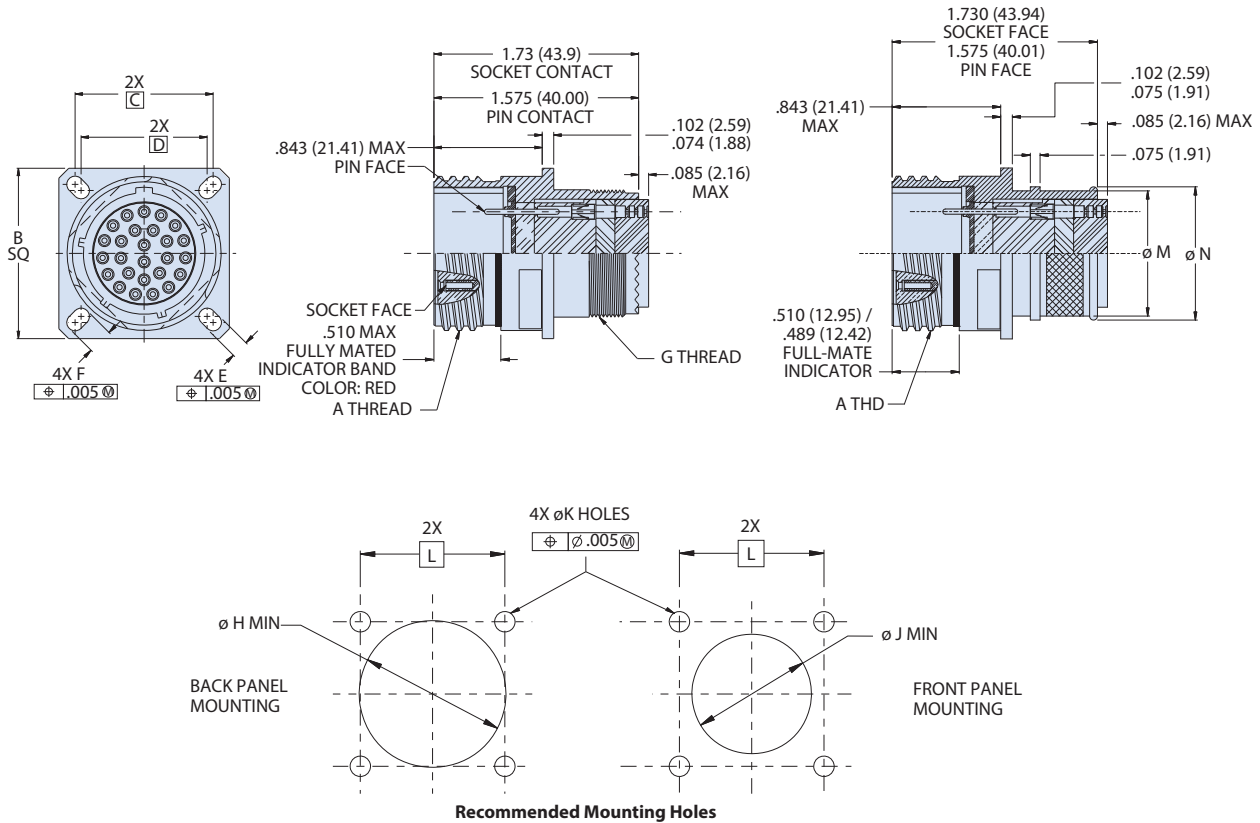

Dimensions														
SHELL SIZE CODE	SHELL SIZE	A THREAD	B SQ	C BSC	D BSC	E	F	G THREAD	øH MIN	øJ MIN	øK HOLES	L BSC	ØM	ØN
A	9	.6250-1P-.3L-TS-2A	.949 (24.10) .925 (23.50)	.719 (18.26)	.594 (15.09)		.224 (5.69) .208 (5.28)	M12 X 1.0-6g .100R	.656 (16.66)	.516 (13.11)		.719 (18.26)	.475 (12.07)	.538 (13.67)
B	11	.7500-1P-.3L-TS-2A	1.043 (26.49) 1.019 (25.88)	.812 (20.62)	.719 (18.26)		.202 (5.13)	M15 X 1.0-6g .100R	.796 (20.22)	.625 (15.88)			.812 (20.62)	.600 (15.24)
C	13	.8750-1P-.3L-TS-2A	1.138 (28.91) 1.114 (28.30)	.906 (23.01)	.812 (20.62)	.136 (3.45)	.186 (4.72)	M18 X 1.0-6g .100R	.922 (23.42)	.750 (19.05)	.133 (3.38)	.906 (23.01)	.700 (17.78)	.762 (19.35)
D	15	1.0000-1P-.3L-TS-2A	1.232 (31.29) 1.208 (30.68)	.969 (24.61)	.906 (23.01)	.120 (3.05)	.181 (4.60) .165 (4.19)	M22 X 1.0-6g .100R	1.047 (26.59)	.906 (23.01)	.123 (3.12)	.969 (24.61)	.835 (21.21)	.898 (22.81)
E	17	1.1875-1P-.3L-TS-2A	1.323 (33.60) 1.299 (32.99)	1.062 (26.97)	.969 (24.61)			M25 X 1.0-6g .100R	1.219 (30.96)	1.016 (25.81)		1.062 (26.97)	.960 (24.38)	1.022 (25.96)
F	19	1.2500-1P-.3L-TS-2A	1.449 (36.80) 1.425 (36.20)	1.156 (29.36)	1.062 (26.97)			.202 (5.13) .186 (4.72)	M28 X 1.0-6g .100R	1.297 (32.94)		1.141 (28.98)		1.156 (29.36)
G	21	1.3750-1P-.3L-TS-2A	1.575 (40.00) 1.551 (39.40)	1.250 (31.75)	1.156 (29.36)			M31 X 1.0-6g .100R	1.422 (36.12)	1.266 (32.16)		1.250 (31.75)	1.188 (30.18)	1.250 (31.75)
H	23	1.5000-1P-.3L-TS-2A	1.701 (43.21) 1.677 (42.60)	1.375 (34.92)	1.250 (31.75)			.162 (4.11) .146 (3.71)	250 (6.35) 234 (5.94)	M34 X 1.0-6g .100R		1.547 (39.29)	1.375 (34.92)	.159 (4.04) .149 (3.78)
J	25	1.6250-1P-.3L-TS-2A	1.823 (46.30) 1.799 (45.69)	1.500 (38.10)	1.375 (34.92)			M37 X 1.0-6g .100R	1.672 (42.47)	1.484 (37.69)	.155 (3.94) .145 (3.68)	1.500 (38.10)	1.475 (37.47)	1.538 (39.07)

MIL-DTL-38999 Series III Type

233-265 Receptacles with removable crimp contacts

233-265-H8 AND BH8 WELD MOUNT RECEPTACLE

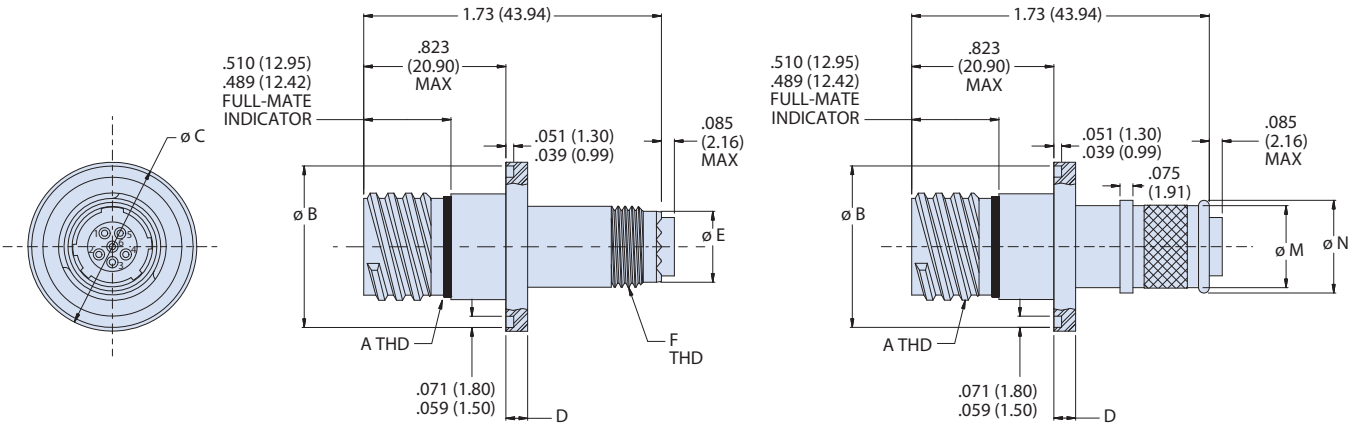

Panel Cutout Dimensions				
SHELL SIZE CODE	SHELL SIZE	Ø G	ØH MIN	DEPTH J ±.005
A	9	.990 (25.15)/.985 (25.02)	.525 (13.34)	.126 (3.20)
B	11	1.112 (28.24)/1.107 (28.12)	.635 (16.14)	.126 (3.20)
C	13	1.238 (31.45)/1.233 (31.32)	.760 (19.30)	.126 (3.20)
D	15	1.364 (34.65)/1.359 (34.52)	.925 (23.50)	.126 (3.20)
E	17	1.451 (36.86)/1.446 (36.73)	1.035 (26.29)	.126 (3.20)
F	19	1.597 (40.56)/1.592 (40.44)	1.155 (29.34)	.126 (3.20)
G	21	1.738 (44.15)/1.733 (44.02)	1.275 (32.39)	.126 (3.20)
H	23	1.894 (48.11)/1.899 (48.23)	1.395 (35.43)	.157 (3.99)
J	25	1.990 (50.55)/1.985 (50.42)	1.525 (38.74)	.157 (3.99)

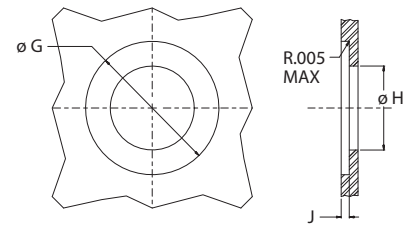

Dimensions									
SHELL SIZE CODE	SHELL SIZE	A THREAD	ØB ±.006	ØC ±.006	D	ØE ±.003	F THD ISO METRIC	ØM	ØN
A	9	.6250-1P-3L-TS-2A	.935 (23.75)	.978 (24.84)	.131 (3.33)/.121 (3.07)	.413 (10.49)	M12 X 1.0-6G	.475 (12.07)	.538 (13.67)
B	11	.7500-1P-3L-TS-2A	1.057 (26.85)	1.100 (27.94)	.131 (3.33)/.121 (3.07)	.531 (13.49)	M15 X 1.0-6G	.600 (15.24)	.662 (16.81)
C	13	.8750-1P-3L-TS-2A	1.183 (30.05)	1.226 (31.14)	.131 (3.33)/.121 (3.07)	.650 (16.51)	M18 X 1.0-6G	.700 (17.78)	.762 (19.35)
D	15	1.0000-1P-3L-TS-2A	1.309 (33.25)	1.352 (34.34)	.131 (3.33)/.121 (3.07)	.807 (20.50)	M22 X 1.0-6G	.835 (21.21)	.898 (22.81)
E	17	1.1875-1P-3L-TS-2A	1.396 (35.46)	1.438 (36.53)	.131 (3.33)/.121 (3.07)	.925 (23.50)	M25 X 1.0-6G	.390 (9.91)	1.022 (25.96)
F	19	1.2500-1P-3L-TS-2A	1.541 (39.14)	1.585 (40.26)	.131 (3.33)/.121 (3.07)	1.043 (26.49)	M28 X 1.0-6G	1.062 (26.97)	1.125 (28.58)
G	21	1.3750-1P-3L-TS-2A	1.683 (42.75)	1.726 (43.84)	.131 (3.33)/.121 (3.07)	1.161 (29.49)	M31 X 1.0-6G	1.188 (30.18)	1.250 (31.75)
H	23	1.5000-1P-3L-TS-2A	1.848 (46.94)	1.892 (48.06)	.162 (4.11)/.152 (3.86)	1.279 (32.49)	M34 X 1.0-6G	1.275 (32.39)	1.338 (33.99)
J	25	1.6250-1P-3L-TS-2A	1.935 (49.15)	1.978 (50.24)	.162 (4.11)/.152 (3.86)	1.397 (35.48)	M37 X 1.0-6G	1.475 (37.47)	1.538 (39.07)