

Straight Strain Relief

AS85049/118

Product Series and Basic Part Number	Dash No. Table I	Finish Table II
M85049/118	S 08	W

S = Detented Self-Locking
N = Non-Detented Self-Locking
Use Dash (-) for Non-Self-Locking

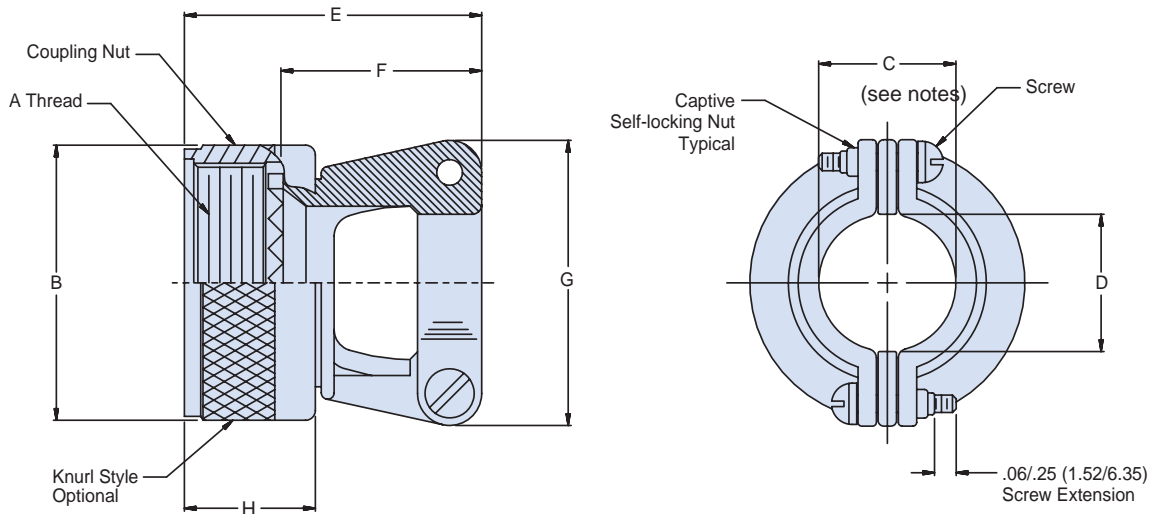

Dash No.	Screw Size	Shell Size	A Thread Class 2B	B Dia Max	C Dim ± .031 (0.8)	D Min	E Max Length	F Dim	G Dim Max	H Dim Max
03	4-40	3	9/16-24 UNEF	.95 (24.1)	.219 (5.6)	.22 (5.6)	1.14 (29.0)	.77 (19.6) .51 (13.0)	.88 (22.4)	.710 (18.00)
12	4-40	7	3/4-20 UNEF	1.14 (29.0)	.344 (8.7)	.35 (8.9)	1.38 (35.1)	1.01 (25.7) .76 (19.3)	1.12 (28.4)	.710 (18.00)
14	4-40	12	7/8-20 UNEF	1.26 (32.0)	.460 (11.7)	.47 (11.9)	1.38 (35.1)	1.01 (25.7) .76 (19.3)	1.19 (30.3)	.710 (18.00)
16	4-40	19	1-20 UNEF	1.39 (35.3)	.545 (13.8)	.55 (14.0)	1.50 (38.1)	1.13 (28.7) .88 (22.4)	1.44 (36.6)	.710 (18.00)
18	6-32	27	1 1/16-18 UNEF	1.51 (38.4)	.615 (15.6)	.62 (15.7)	1.75 (44.5)	1.38 (35.1) 1.13 (28.7)	1.56 (39.6)	.710 (18.00)
20	6-32	37	1 3/16-18 UNEF	1.64 (41.7)	.698 (17.7)	.70 (17.8)	1.88 (47.8)	1.51 (38.4) 1.25 (31.8)	1.69 (42.9)	.710 (18.00)
61	8-32	61	1 1/2-18 UNEF	1.95 (49.5)	.850 (21.6)	.85 (21.6)	2.13 (54.1)	1.76 (44.7) 1.51 (38.5)	1.88 (47.8)	.710 (18.00)

Sym.	Material	Finish
A	Aluminum Alloy	Black Anodize
N		Electroless Nickel
W		Cadmium, Olive Drab
X		Nickel Fluorocarbon Polymer
Z		Zinc Nickel

NOTES

- Glenair Series 600 Backshell Assembly Tools are recommended for assembly/installation.
- Cable entry is measured with saddle bars closed and bottomed on clamp ears.
- Material/Finish:
Clamp body, coupling nut, saddles - Al alloy or 300 Series SST/See Table II.
Clamp screws and lock nuts - CRES/Passivated, Silver plate optional.
Anti-rotation device - Corrosion resistant material