

The widest range of
mission-critical interconnect
technologies in the world

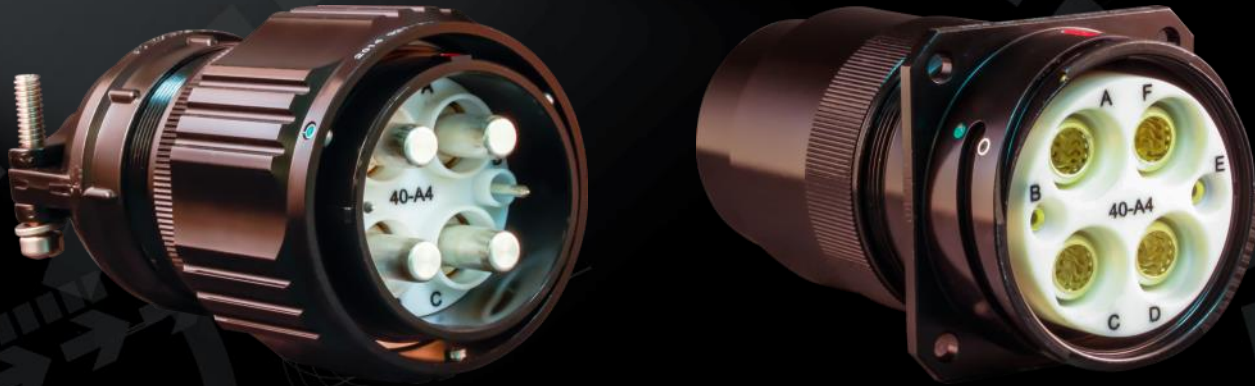

Industrial and Rail Power Connectors

Rugged Environmental • MIL-DTL-5015 Type



Industrial Power Connector Capabilities



Multi-Pin Circular Power Connectors



Single-Pole Power Connectors



High Current / High Voltage



Special Purpose

Glencair®



SERIES ITS REVERSE-BAYONET 5015

Industrial power and signal connectors

**ITS
POWER**

Series ITS (And FRITS) 5015 Type Reverse Bayonet Connectors

- Derived from MIL-DTL-5015, intermate with Veam CIR and Amphenol GT series
- Several options available: platings, insert materials, contacts, backshell terminations, etc.
- Version for Mass Transit Market uses fire resistant inserts (testing available)
- Flame: ASTM E162; Smoke: ASTM E662; Toxicity: SMP800C



Series ITS Specifications

- Size 20, 18, 16, 12, 8, 4, 0, 4/0 silver, gold and heavy gold crimp contacts (plus metric wire barrel entries)
- Over 200 insert arrangements and 12 shell sizes
- Available 8 AWG coaxial contacts
- Aluminum alloy with cadmium-free surface coatings
- -55° C to +125° C continuous temperature rating
- Chemical and moisture resistant synthetic rubber inserts
- 7.5 to 350 AMPS depending on contact selection
- Operating voltage by service ratings:
 - A: 250 VDC
 - D: 700 VDC
 - E: 1250 VDC
 - B: 2450 VDC
 - C: 4200 VDC



Series ITH

Rigid insert mechanical contact retention derivative

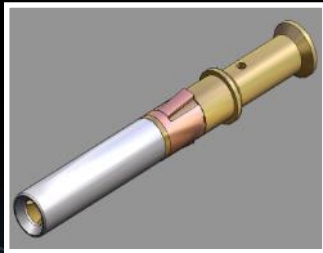

- Machined contact with retention clip (front release)
- Silicon front seal gasket and grommet

Series FRITS - STR

STR backshells lock the cables or wires inside the connector, assuring IP67 environmental rating.

- Possible to use different cable gages with each connector size
- Termination of multi-screened cables is accomplished by locking the braids between sectors
- Availability of different terminations for PG or Metric cable glands, rubber conduits, etc.



Series ITK

High Temperature Ceramic Insert

- Engine application connector
- Up to 700°F continuous operating temperature
- Stainless steel shells and accessories



The background of the advertisement is a photograph of a high-speed train, specifically a TGV, at a station platform. The train is painted in blue and yellow. The platform has a blue tactile paving strip. In the foreground, four different models of rugged rail connectors are displayed, floating in the air. These connectors are cylindrical and have various mounting options and connector types. The Glenair logo is in the top left corner.

Glenair®

ITS 500 • ITS 901

Rugged Rail Connectors

High Current / High Voltage Solutions



IRT Series

- High Current, High Voltage
- 450A Current, 1500 VAC
- Screw or Lever Coupling
- 3, 4 or 6 Contacts



901 Series

- High Current, Lower Voltage
- 450A Current, 800-1000 VAC
- Bayonet or Thread Coupling
- 2 to 4 Contact Combinations
- UL Recognized



500 Series

- High Current, High Voltage
- 750A Current, 3000 Vcc
- Bayonet Coupling
- Single Pole

Series IRT Traction Motor Connectors

IRT Multi-Pole Power Connector Series with 3 or 4 contacts

- Screw fastener coupling or lever system with lock
- Working voltage: 1500 – 3000 VAC
- Test voltage: 4500 VAC
- Temperature range: -55°C to +125°C
- Waterproof IP67, mated condition
- Suitable for single cables, 4AWG - 373 MCM (35-185mm²)
- Gland or clamp strain relief



Series ITS 901 Jumper Connectors

ITS 901 Reverse-Bayonet Multi Pole Power Connectors

- For power cables over AWG 1/0.
- Accepts cable from AWG 4 to 262 MCM (4AWG - 262 MCM (35-120mm²), for current up to 450 Amp.
- Available for single wires and multipole jacketed cables, with cable clamp or conduit.
- Male contacts with Finger Test Protection, Load Side (Receptacle or Plug).
- Long bayonet ramps, three polarization keys and rubber recovered coupling facilitate mating and unmating operations.
- 500 Mating Cycles
- IP67 Sealing (Coupled Connectors); Fire Resistant materials



Series IGE: Single Pole Power Connectors

- Single pole connectors used for transmission of high currents with low voltage, as, for example, on military vehicles or industrial equipment.
- Reverse bayonet coupling
- 5 connector sizes
- Current Rating: 225A to 950A



Glencair®



SUPER ITS

High-Performance Reverse-Bayonet Connectors

Series 921 Super ITS

Next-generation 5015 power connector with improved electrical performance and speed-of-assembly

- Rigid insert with mechanical contact retention
- Higher temperature range: -55° to +180°C
- Higher ampacity with new-generation cable
- Front release and single wire seal instead of rear grommet
- 2,000 mating cycles low force contacts and turning coupling nut pin
- Environmental seal: IP69K

SUPER
I T S





Glencair®



ITS-Ex

IECEX/ATEX Qualified

ITS-Ex Hazardous Zone Connectors



ITS-Ex Connectors



ITS-Ex IEC/ATEX Qualified Hazardous/Explosive Zone Connectors

- Over 40 power and signal contact arrangements
- Full support for armored and unarmored cable
- MIL-DTL-5015 crimp-contact derivative solution
- Locking set screw-equipped coupling nut and protective safety covers
- Extended shell labyrinth cooling zone and potting chamber on all designs
- Mechanical cable clamp, basket weave, and Ex d cable gland accessories
- IP68 water, vapor, moisture and dust protection in mated condition



The RADGRIP logo, consisting of the word "RADGRIP" in a bold, stylized font with horizontal stripes, set against a background of horizontal lines. A small "TM" trademark symbol is located to the right of the logo.

RADGRIP™

RADGRIP™ COUPLING NUTS

**For fast, easy mating of ITS connectors
plus improved mechanical protection**



RadGrip



Rubber-covered coupling nut connectors

- For fast, easy mating of ITS series bayonet connectors
- Improved coupling nut protection
- Ergonomic design
- High shock and vibration protection
- Chemical resistant
- Colored for connector identification



Glencair®



SERIES UJ

Power Joint Connection System

Glencair®



POWER
TRIP®

SERIES 970

PowerTrip™

Reduced size and weight power connectors



Series 970 PowerTrip™

The power connector for extreme environments

- The ultimate in “Trip 9” packaging with high performance power
- High ampacity, low insertion force LouverBand contacts
- Available in aluminum, stainless steel and marine bronze
- Meets all the high shock and vibration which is endured in 38999 connectors
- EMI, banding and environmental backshell solutions



**POWER
TRIP®**





MARINE BRONZE

**Seacrow connectors
for harsh-environment applications**





← West Gates

Time	Number Train	To	Status	Track	Time	Number Train
8:30A	170	REGIONAL BOSTON	ON TIME		9:24A	6227 MID DIR
8:30A	470	SHUTTLE SPRINGFIELD	ON TIME		9:30A	6000 KEYSTO
8:32A	6219	MID DIRECT SEC MONTCLAIR	ON TIME		9:35A	1141 REGION
8:41A	3227	NJCOAST SEC EMR LONG BRANCH	ON TIME		9:37A	3831 NE CO
8:52A	3927	NE CORR SEC EMR BANTON	ON TIME		9:43A	3231 NJCO
9:01A	3929	NE CORR SEC EMR BANTON	ON TIME		9:45A	281 ENPI
9:11A	3829	NE CORR SEC EHR TRENTON	ON TIME		9:46A	6619 MID
9:17A	6317	MID DIRECT SEC SUMMIT	ON TIME		10:00A	2153 ACEL

9:05 SEC-STOPS AT SECAUCUS EMR-STOPS AT NEWARK AIRPORT

Octobyte™

The faster 4/8 pole interconnect system for Ethernet data applications



Octobyte 4/8 Pole Interconnect System

The Ethernet MVB-WTB datalink solution for rail networks, passenger information, and other harsh industrial applications

- High-speed Ethernet for ultra-harsh industrial environments
- Hybrid Ethernet, signal and power
- Anti-vibration coupling
- MVB-WTB and Coax with limited loss over long distances and multiple interconnection breaks

The Octobyte logo features the word "Octobyte" in a white, stylized, sans-serif font. To the left of the text is a graphic element consisting of several white, curved lines that resemble a stylized octopus or a signal wave.

Glencair®



SUPERSEAL™

**Ruggedized RJ45 and USB
reverse bayonet 5015 type connectors**



SuperSeal™

High Performance Mighty Mouse, D38999 type,
5015 type, 28840 type RJ-45 and USB



- IP67 sealing in unmated condition
- Crimp and poke termination
- Superior grounding





SERIES 928

HMI Lighting Connectors



Series 928 HMI Connectors

Quarter-turn bayonet plugs and receptacles for ballast and head connectors

- High quality, extremely durable and safe, reliable connections between ballast and lamps
- Robust coupling mechanism for the area most affected by wear and tear
 - Arctic Coupling nut and RadGrip
- A snag-less clamp and seal mechanism for every cable type and/or size (EZ-Clamp)
- Connectors compatible with all major HMI Lamp manufacturers from 400w to 24kW

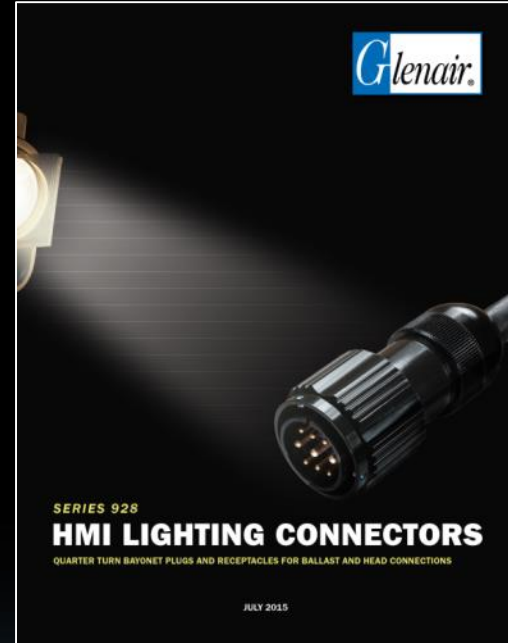

Also Available: IPT Series Connectors

Derived from MIL-C-26482-Series I and VG95328

- Insert arrangements with 2 to 61 crimp contacts and 7 contact sizes
- Current rating: 7.5A to 13A
- Intermateable with MIL-C-26482 Series I and VG95328
- Compatibility as well to BS9522 F0017
- Specials or custom designs available
- Various classes available



IPT SE Series
High Performance
Crimp Contact
MIL-C-26482 Type
Bayonet Connector



Also Available: VG Series Connectors

VG-qualified for use in European defense and industrial applications

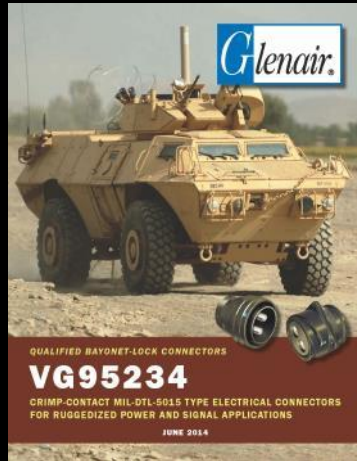

MIL-DTL-5015 type
reverse-bayonet



MIL-DTL-26482 type
bayonet-lock

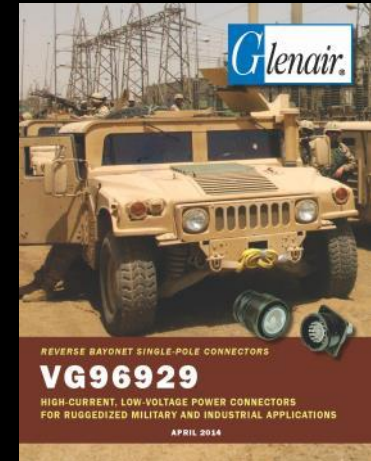

MIL-DTL-5015 type
reverse-bayonet
single-pole



The widest range of
mission-critical interconnect
technologies in the world

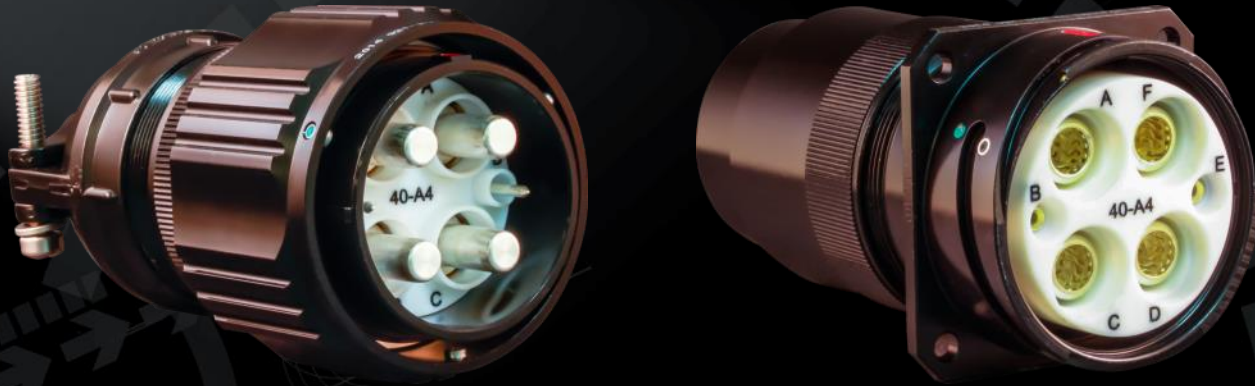

Industrial and Rail Power Connectors

Rugged Environmental • MIL-DTL-5015 Type