

Contact layout	Contacts				Alternative polarizations			
	8	12	16	20	Degrees $\alpha$			
					W	X	Y	Z
18-19			10			120	240	
20-15		7			80			280
22-14			19		80			280
24-10	7				80			280
24-A55				55	80	110	250	280
28-21			37		80	110	250	280
32-A13		13			65	130	230	295
36-10			48		80	125	235	280
36-A22		22			80	110	250	280
40-A35		35			70	130	230	290
40-A60			60		80	110	250	280
40-70			70		80	110	250	280
20-4			7		45	110	250	
20-7		8			80	110	250	280
22-23		4			35		250	

Insert Rotation (Front View of Pin Insert)

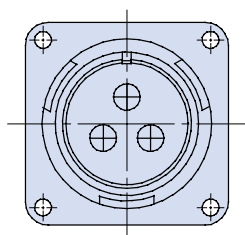

Normal Position

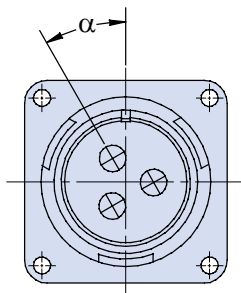

Alternate Position with Socket Contacts

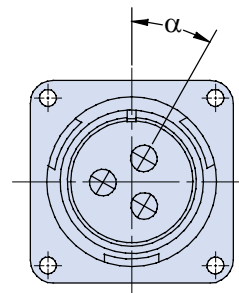

Alternate Position with Pin Contacts

# Series ITH Rigid Insert Reverse Bayonet Connectors

## Contact Arrangements, Polarizations, and Insert Rotations



ITH  
Rigid Insert  
Connectors

Front View of  
Pin Insert  
Arrangement:  
Contact Size:

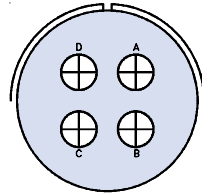

20-4  
12

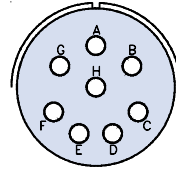

20-7  
16

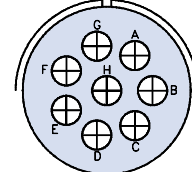

22-23  
12

Front View of  
Pin Insert  
Arrangement:  
Contact Size:

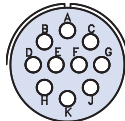

18-19  
16

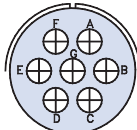

20-15  
12

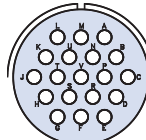

22-14  
16

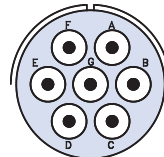

24-10  
8

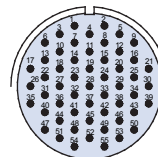

24-A55  
20

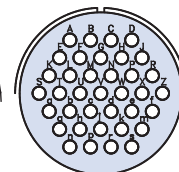

28-21  
16

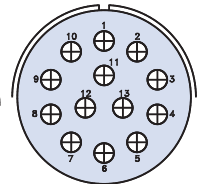

32-A13  
12

Front View of  
Pin Insert  
Arrangement:  
Contact Size:

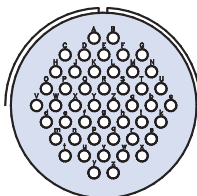

36-10  
16

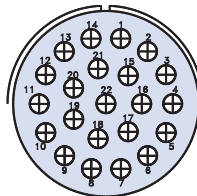

36-A22  
12

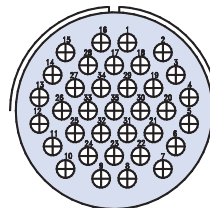

40-A35  
12

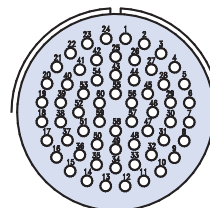

40-A60  
16

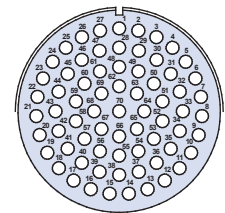

40-70  
16

**CONTACT  
LEGEND**



20



16



12



8