

D38999 SERIES III TYPE TVS ADAPTER

How To Order								
Sample Part Number	242-383	A	-XXXX	NF	19-11	PS	N	N
TVS Connector	MIL-DTL-38999 Series III							
Shell Style	A = Adapter							
Diode Net List	Assigned by Glenair. See Table V							
Connector Class	See Table II							
Insert Arrangement	IAW MIL-STD-1560							
Contact Gender	PS = Pins, Plug Side SP = Sockets, Plug Side							
Flange Mounting Style	N = Not Applicable							
Alternate Key Position	A, B, C, D, E, N = Normal, U = Universal (Do not mate Universal with Universal)							

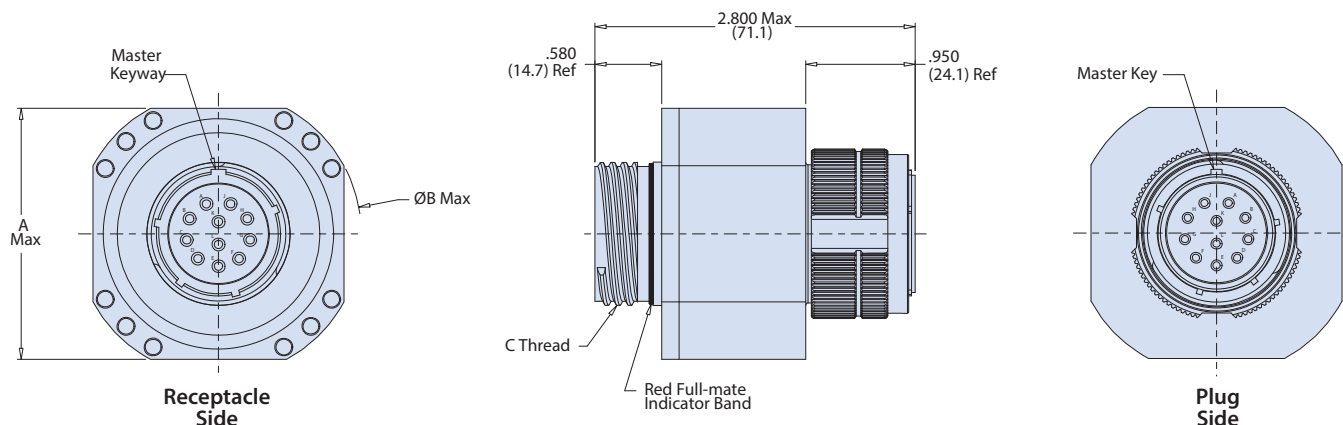

Notes

- Materials/Finishes: Shell Housing & Coupling Nut: See Table II
Ground Spring: Beryllium Copper Alloy/Electroless Nickel
Insulators: High grade rigid dielectric
Seals: Fluorosilicone
Contacts: Copper Alloy/Gold over Nickel per ASTM B 488
- Assembly to be identified with Glenair's name, part number, and date code - space permitting.
- Insert Arrangement in accordance with MIL-STD-1560. (Arrangement shown for reference only)
- Electrical Performance: Specific diode voltage code options per Table III. Diode wattage based on 10 x 1000 uS peak pulse power waveform.
Clamping Time: Less than 1 picosecond, 0V to min. breakdown.
- Glenair will assign a diode net list code and provide a separate net list drawing containing specific electrical requirements. Fill out applicable columns of Table V and return.
- Consult factory for low capacitance, ground requirements, power ratings above 5000W, special test requirements, or other modifications.
- Operating temperature: -55°C to +150°C

Dimensions in inches (millimeters) and are subject to change without notice.

242-383A
MIL-DTL-38999 Series III Type TVS Connector
Adapter

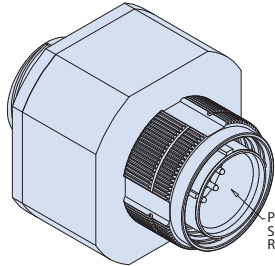
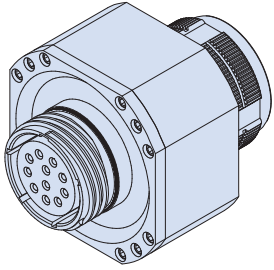

Pins On Plug
 Side Shown For
 Reference Only

Table I: Dimensions			
Shell Size	A Max	ØB Max	C Thread
9	1.000 (25.4)	1.300 (33.0)	.6250-.1P-.3L-TS-2A
11	1.400 (35.6)	1.700 (43.2)	.7500-.1P-.3L-TS-2A
13	1.700 (43.2)	2.000 (50.8)	.8750-.1P-.3L-TS-2A
15	1.700 (43.2)	2.000 (50.8)	1.0000-.1P-.3L-TS-2A
17	2.000 (50.8)	2.300 (58.4)	1.1875-.1P-.3L-TS-2A
19	2.200 (55.9)	2.500 (63.5)	1.2500-.1P-.3L-TS-2A
21	2.300 (58.4)	2.600 (66.0)	1.3750-.1P-.3L-TS-2A
23	2.600 (66.0)	2.900 (73.7)	1.5000-.1P-.3L-TS-2A
25	2.900 (73.7)	3.200 (81.3)	1.6250-.1P-.3L-TS-2A

Table II: Material and Finish		
Sym	Material	Finish Description
ME	Aluminum	Electroless Nickel
MT		Ni-PTFE 1000 Hour Grey™ Nickel Fluorocarbon Polymer
NF		Cadmium O.D. Over Electroless Nickel
ZN		Zinc-Nickel, Olive Drab
ZNU		Zinc Nickel, Black
ZR		Zinc Nickel, Black - RoHS
ZL		Stainless Steel

Dimensions in inches (millimeters) and are subject to change without notice.

