

ITS 4101 RG and ITS 4101 RRG Cylindrical In-Line Receptacle Assembly with Rubber-Coated Cable Sealing Backshell

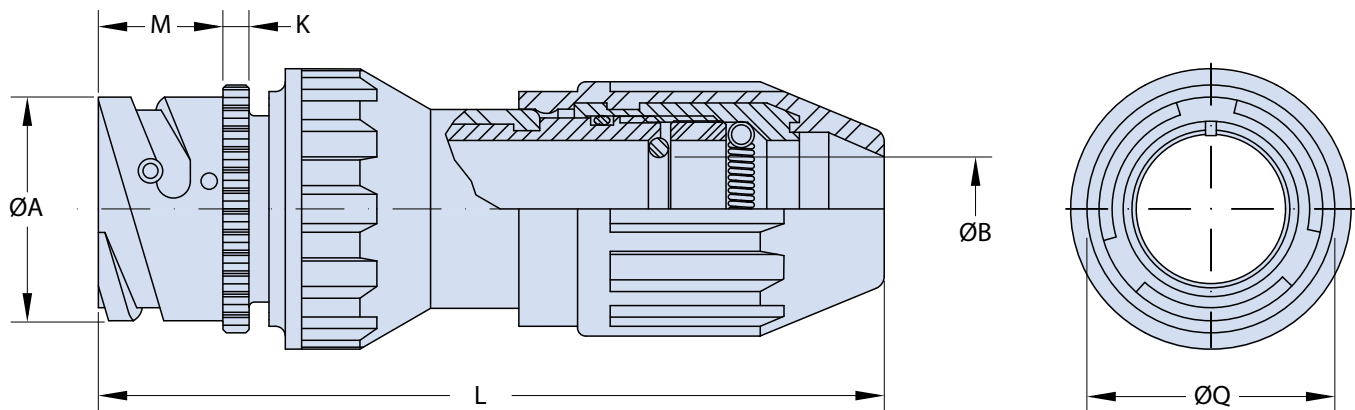
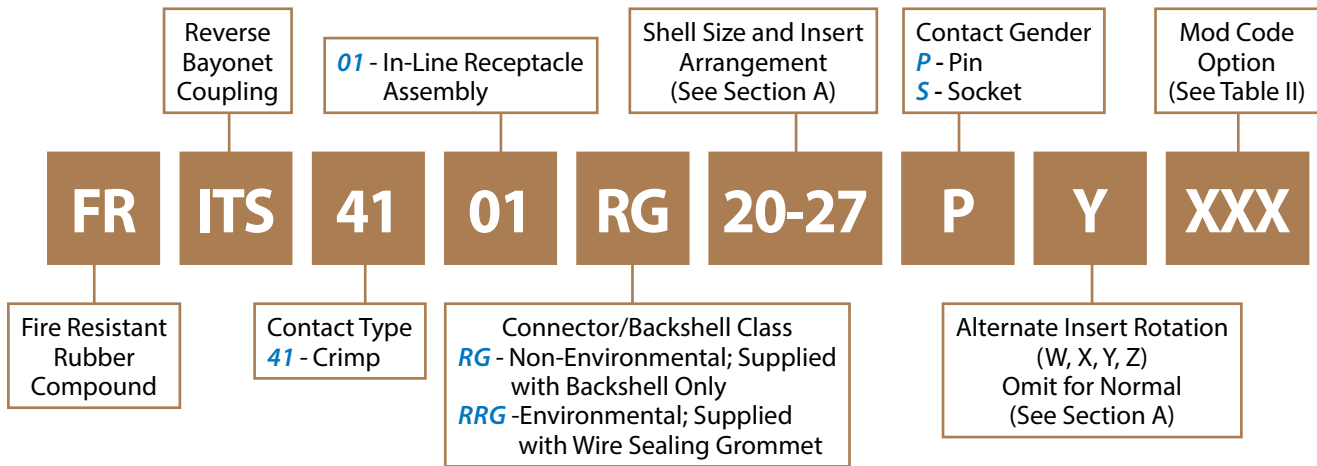

Application Notes

1. Cylindrical in-line receptacle assembly with rubber-coated cable sealing backshell with spring style strain relief for use with jacketed cables.
2. RG - Non-Environmental; grommet not supplied.
RRG - Environmental; supplied with wire sealing grommet.
3. Standard materials configuration consists of aluminum alloy.
4. Standard contact material consists of copper alloy with silver plating or gold plating.

**ITS 4101 RG and ITS 4101 RRG
Cylindrical In-Line Receptacle Assembly
with Rubber-Coated Cable Sealing Backshell**



TABLE I: DIMENSIONS

Shell Size	ØA +0.2 -0.1	ØB		K ±0.2	L Max.	M +0.4 -0	ØQ ±0.1
		Min.	Max.				
14 S	24.5	9.52	12.70	3.2	90	14.2	28.8
16 S	27.2	12.70	15.90	3.2	90	14.2	30.5
16	27.2	12.70	15.90	3.2	100	19.0	30.5
18	30.7	12.70	15.90	4.0	105	19.0	33.8
20	34.0	15.90	19.00	4.0	110	19.0	36.9
22	37.3	15.90	19.00	4.0	110	19.0	39.5
24	40.9	19.00	22.20	4.0	140	20.6	43.9
28	46.7	22.20	25.40	4.0	140	20.6	48.4
32	53.4	28.50	31.75	4.0	145	22.2	56.0
36	59.6	31.75	34.90	4.0	160	22.2	62.4
40	65.5	38.00	41.27	4.0	165	22.2	68.6

TABLE II: MODIFICATION CODES

CONTACT OPTIONS		
Sym	Description	
B0	Connector without Contacts**	
B1	Connector with Gold Plated Contacts	
Omit for standard version (Silver plated)		
STANDARD MATERIAL AND FINISH (*)		
Sym	Description	RoHS
	Omit for Aluminum/ Cadmium Olive Drab	
F6	Aluminum/ Black Electrodeposited Paint	✓
F7	Aluminum/ Black Zinc Nickel	✓
F11	Aluminum/ Electroless Nickel	✓

(*) Apply to components without rubber covering only.
For further finish options, please contact the factory.

(**) Crimp Contacts Only