

SERIES 928 • QUARTER-TURN • BAYONET Connectors for HMI Lighting



928-001 Line Receptacle



Features

- ¼ turn bayonet lock for secure attachment
- Intermateable, interchangeable with "VEAM" type connectors
- Machined contacts
- Durable polymer electrocoat finish
- UL #E328968 recognized
- IP67 ingress protection

Specifications

- Operating temperature: -55°C. to +125°C.
- Suggested maximum operating voltage: 500 Vac
- Current rating: size #4 contact 80 A, size #8 46 A, size #12 23 A, size #16 13 A
- Meets mechanical, electrical and environmental requirements of MIL-DTL-5015 and VG95234

Connector Construction

- Shell: aluminum with black polymer electrocoat
- Contacts: copper alloy, silver or gold plating
- Insert: neoprene

Cable Grip Construction

- Adapter: aluminum with black polymer electrocoat
- Style 1 EZ Clamp: aluminum with black polymer electrocoat, neoprene sealing gland
- Style 2 Cordgrip: 6/6 nylon, UL 94V-0, with TPE sealing gland

928-001 female line connectors are compatible with standard "VEAM" type quarter-turn bayonet connectors used on HMI lighting ballasts and heads. These UL-recognized connectors are available with two cordgrip options or as connector only for use with customer-supplied adapters. Aluminum shell, neoprene inserts, machined copper alloy contacts with gold or silver plating. 125° C. temperature rating, 500Vac, 13 A to 80 A current rating depending on contact size. Crimp or solder termination.

How To Order							
	928-001-	24-2	P	S	1	A	1
Product	928-001 = Line Receptacle						
Arrangement Number	14S-07 24-2 24-2W 24-2Z 24-11 28-09 28-10 28-22 32-68						
Contact Type	P = Pin contacts (male) S = Socket contacts (female)						
Contact Termination Style	S = Solder (installed) C = Crimp (uninstalled)						
Contact Finish	1 = Silver (standard) 2 = Gold (optional)						
Shell Finish	A = Black polymer electrocoat						
Cable Grip	Omit for connector with no cable grip 1 = EZ Clamp "bullet" style machined aluminum cordgrip 2 = Nylon cordgrip with PG cable gland, liquid tight						

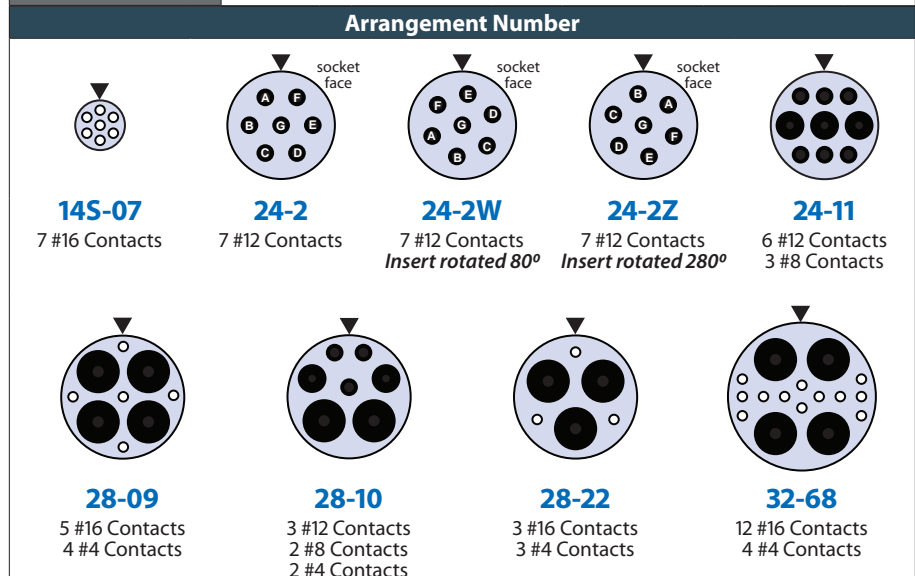

SERIES 928 • QUARTER-TURN • BAYONET Connectors for HMI Lighting



928-001 Line Receptacle

CONNECTOR DIMENSIONS

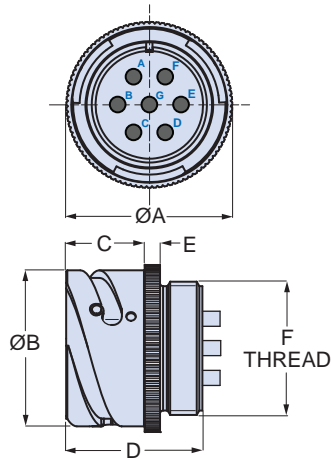

Arrangement No.	øA Max.		øB Max.		C Max.		D		E		F Thread
	In.	mm.	In.	mm.	In.	mm.	In.	mm.	In.	mm.	
14S-07	1.13	28.8	.96	24.5	.58	14.7	.98	24.9	.14	3.5	.7500-20 UNEF
24-2	1.73	44.0	1.61	40.9	.82	20.8	1.41	35.8	.17	4.2	1.375-18 UNEF
24-2W	1.73	44.0	1.61	40.9	.82	20.8	1.41	35.8	.17	4.2	1.375-18 UNEF
24-2Z	1.73	44.0	1.61	40.9	.82	20.8	1.41	35.8	.17	4.2	1.375-18 UNEF
24-11	1.73	44.0	1.61	40.9	.82	20.8	1.41	35.8	.17	4.2	1.375-18 UNEF
28-09	1.91	48.5	1.84	46.7	.82	20.9	1.41	35.8	.17	4.2	1.625-18 UNEF
28-10	1.91	48.5	1.84	46.7	.82	20.9	1.41	35.8	.17	4.2	1.625-18 UNEF
28-22	1.91	48.5	1.84	46.7	.82	20.9	1.41	35.8	.17	4.2	1.625-18 UNEF
32-68	2.20	56.0	2.10	53.4	.89	22.5	1.47	37.4	.17	4.2	1.875-16 UN

STYLE 1 EZ CLAMP DIMENSIONS

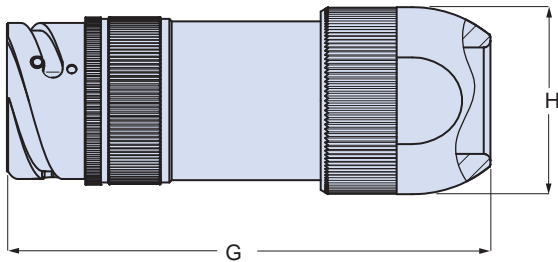

Arrangement No.	G Max.		H Max.		Cable Dia. Range			
	In.	mm.	In.	mm.	In.		mm.	
					Min.	Max.	Min.	Max.
14S-07	3.82	97.0	1.02	25.8	.23	.44	5.8	11.1
24-2	4.59	116.6	1.69	43.0	.61	.94	15.5	23.8
24-2W	4.59	116.6	1.69	43.0	.61	.94	15.5	23.8
24-2Z	4.59	116.6	1.69	43.0	.61	.94	15.5	23.8
24-11	4.59	116.6	1.69	43.0	.61	.94	15.5	23.8
28-09	4.78	121.4	1.69	43.0	.61	.94	15.5	23.8
28-10	4.78	121.4	1.69	43.0	.61	.94	15.5	23.8
28-22	4.78	121.4	1.69	43.0	.61	.94	15.5	23.8
32-68	5.09	129.2	2.01	51.0	.92	1.25	23.4	31.8

STYLE 2 NYLON CORDGRIP DIMENSIONS

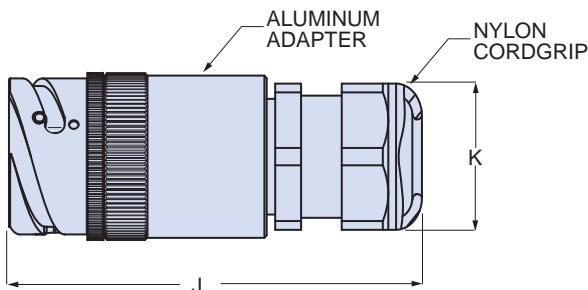

Arrangement No.	J Max.		K Max.		Cable Dia. Range			
	In.	mm.	In.	mm.	In.		mm.	
					Min.	Max.	Min.	Max.
14S-07	3.28	83.4	1.04	26.5	.51	.71	13.0	18.0
24-2	4.03	102.4	1.16	29.5	.71	.98	18.0	25.0
24-2W	4.03	102.4	1.16	29.5	.71	.98	18.0	25.0
24-2Z	4.03	102.4	1.16	29.5	.71	.98	18.0	25.0
24-11	4.03	102.4	1.16	29.5	.79	1.26	20.0	32.0
28-09	4.67	118.5	1.82	46.3	.79	1.26	20.0	32.0
28-10	4.67	118.5	1.82	46.3	.79	1.26	20.0	32.0
28-22	4.67	118.5	1.82	46.3	.79	1.26	20.0	32.0
32-68	4.96	126.0	1.82	46.3	.79	1.26	20.0	32.0