

**287-159**  
**MIL-DTL-24308/9 Type Hermetic**  
**D-Subminiature Pin-to-Pin Feedthrough**

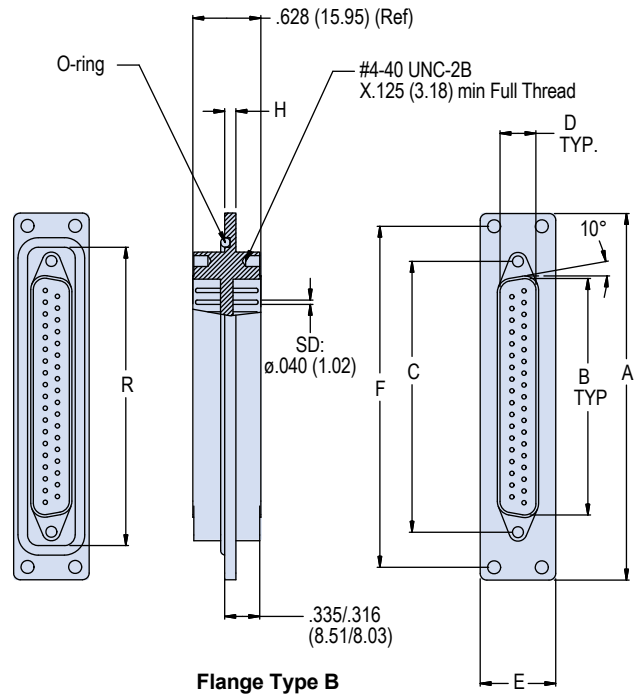

MIL-DTL-24308  
Type

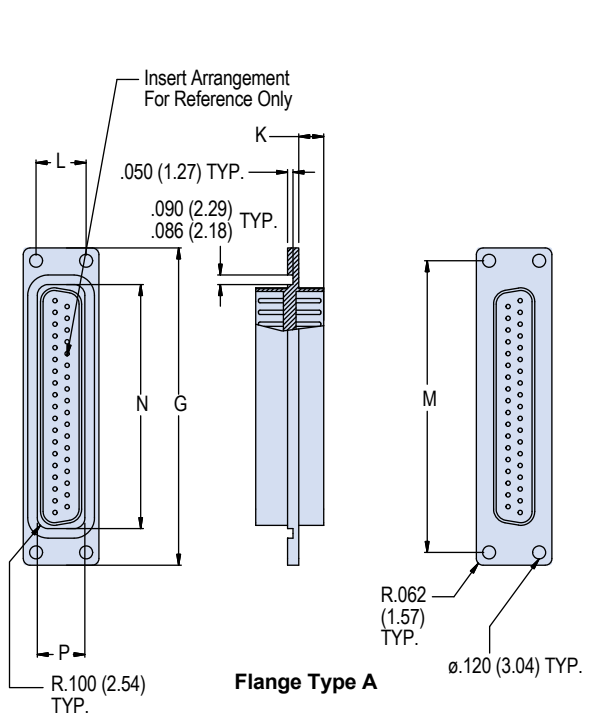
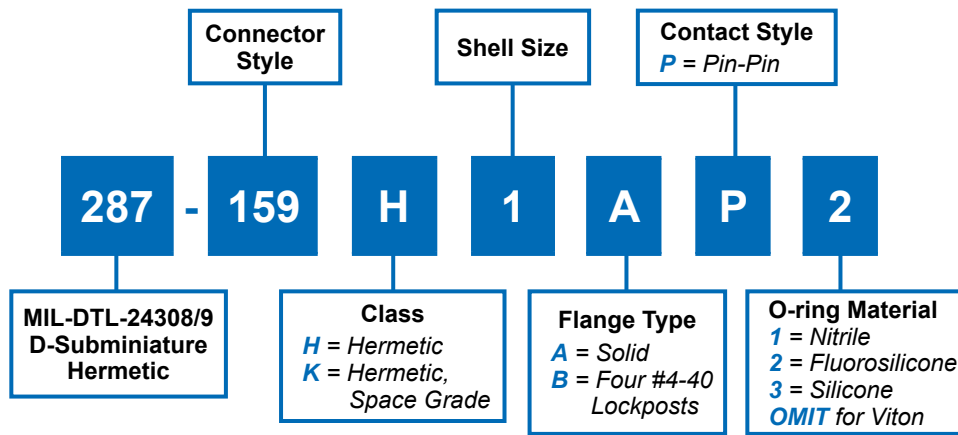

**J**

**APPLICATION NOTES**

- To be identified with manufacturer's name, part number and date code, space permitting.
- Contact Style: Pin-to-Pin only (See Part Number Development).
- All dimensions are typical for flange types "A" and "B." "C" dim is not applicable to flange type "A."
- Material/Finish:  
 Shell: H = FT - Carbon steel/tin plated.  
 K = Z16 - Stainless steel/nickel plated, Dull Finish
- Performance:  
 DWV - SD = 750 VAC Pin-to-Shell  
 I.R. - 5,000 MegOhms Min @ 500 VDC  
 Hermeticity -  $1 \times 10^{-5}$  ccHe/sec @ 1 atmosphere differential
- Glenair 287-159 will mate with any QPL MIL-DTL-24308/1, /2 and /23 receptacle of the same size and arrangement.
- Metric dimensions (mm) are indicated in parentheses.

Dimensions in Inches (millimeters) are subject to change without notice.



# 287-159 MIL-DTL-24308/9 Type Hermetic D-Subminiature Pin-to-Pin Feedthrough

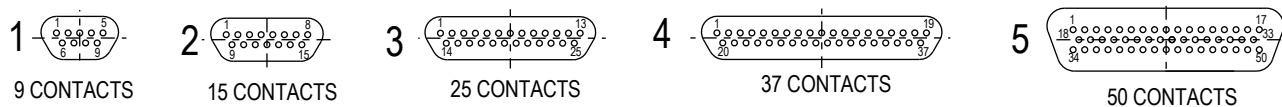

**TABLE I: CONNECTOR DIMENSIONS**

Shell Size	Dim A ± .015 (± 0.4)	Dim B ± .004 (± 0.1)	Dim C BSC	Dim D ± .004 (± 0.1)	Dim E ± .010 (± 0.3)	Dim F BSC	Dim G ± .010 (± 0.3)	Dim H ± .006 (± 0.2)	Dim K ± .010 (± 0.3)	L BSC	M BSC	N .005 (.127)	P	R	O-ring Req'd Type A	O-ring Req'd Type B
1	1.865 (47.37)	.667 (16.94)	.984 (24.99)	.330 (8.38)	.698 (17.73)	1.629 (41.38)	1.413 (35.89)	.094 (2.39)	.235 (5.97)	.462 (11.73)	1.177 (29.90)	.806 (20.47)	.440 (11.18)	1.238 (31.45)	2-108	2-022
2	2.200 (55.88)	.993 (25.22)	1.312 (33.32)	.330 (8.38)	.698 (17.73)	1.964 (49.89)	1.741 (44.22)	.094 (2.39)	.235 (5.97)	.462 (11.73)	1.499 (38.07)	1.100 (27.94)	.440 (11.18)	1.564 (39.73)	2-021	2-026
3	2.736 (69.49)	1.535 (38.99)	1.852 (47.04)	.330 (8.38)	.698 (17.73)	2.500 (63.50)	1.288 (32.72)	.103 (2.62)	.230 (5.84)	.462 (11.73)	2.052 (52.12)	1.690 (42.93)	.440 (11.18)	2.180 (55.37)	2-027	2-030
4	3.385 (85.98)	2.183 (55.45)	2.500 (63.50)	.330 (8.38)	.698 (17.73)	3.149 (79.98)	2.929 (74.40)	.103 (2.62)	.230 (5.84)	.462 (11.73)	2.693 (68.40)	2.376 (60.35)	.440 (11.18)	2.770 (68.58)	2-031	2-033
5	3.289 (83.54)	2.079 (52.81)	2.406 (61.11)	.441 (11.20)	.810 (20.57)	3.053 (77.55)	2.835 (72.01)	.103 (2.62)	.230 (5.84)	.574 (14.58)	2.599 (66.01)	2.246 (57.05)	.570 (14.48)	2.650 (67.31)	2-031	2-033

J

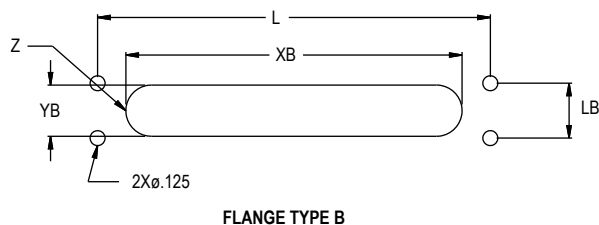
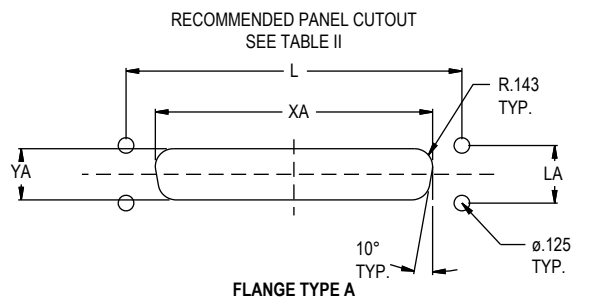

**TABLE II: PANEL CUT-OUT DIMENSIONS - STYLE A**

Shell Sizes	Dim XA	Dim YA	Dim LA	Dim L
1	.744 (18.90)	.410 (10.41)	.462 (11.73)	1.177 (29.90)
2	1.070 (27.18)	.410 (10.41)	.462 (11.73)	1.499 (38.07)
3	1.612 (40.94)	.410 (10.41)	.462 (11.73)	2.052 (52.12)
4	2.261 (57.43)	.410 (10.41)	.462 (11.73)	2.693 (68.40)
5	2.156 (54.76)	.520 (13.21)	.574 (14.58)	2.599 (66.01)

**TABLE II: PANEL CUT-OUT DIMENSIONS - STYLE B**

Shell Sizes	Dim XB	Dim YB	Rad. Z	Dim L	Dim LB
1	1.180 (29.97)	.410 (10.41)	.205 (5.21)	1.629 (41.38)	.462 (11.73)
2	1.508 (38.30)	.410 (10.41)	.205 (5.21)	1.964 (49.89)	.462 (11.73)
3	2.048 (52.02)	.410 (10.41)	.205 (5.21)	2.500 (63.50)	.462 (11.73)
4	2.696 (68.48)	.410 (10.41)	.205 (5.21)	3.149 (79.98)	.462 (11.73)
5	2.602 (66.09)	.520 (13.21)	.260 (6.60)	3.053 (77.55)	.574 (14.58)

Dimensions in Inches (millimeters) are subject to change without notice.