

## SERIES 10KPSI

# Underwater Interconnect Assemblies

**G**lenair 10 KPSI Underwater Interconnects provide a cost-effective solution for high pressure underwater applications. Ideal for any harsh environment application, these molded neoprene cables and epoxy bulkhead connectors are impervious to most chemicals.



- 7.5 Amps to 200 Amps
- Two to Eight Contacts
- 10,000 PSI (Mated) Pressure Rating
- Catalog and Custom Cable Options
- Chemically Resistant

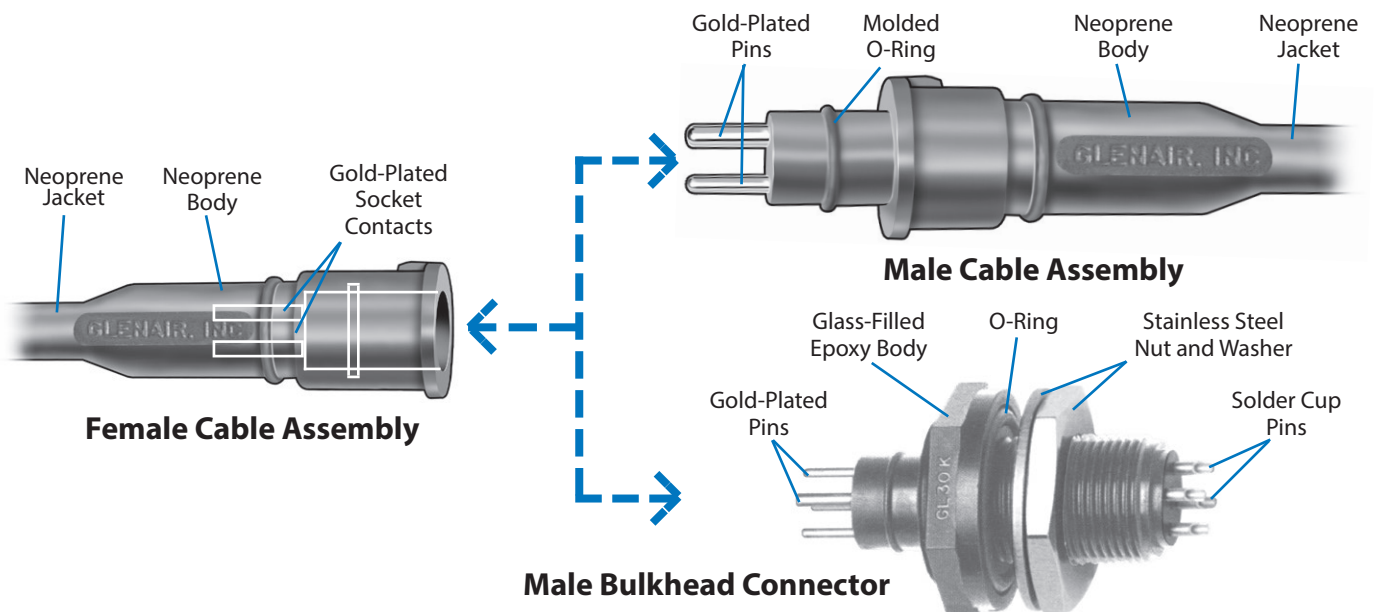

# SERIES 10KPSI Underwater Interconnect Assemblies



## How-to-order

### MALE CABLE ASSEMBLIES

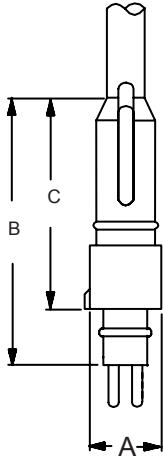

Number of Contacts	Contact Quantity/Size	Cable Length*	Part Number	A Dia	B	C
2	1 #10, 1#12	2 feet	<a href="#">GL20G2P-M</a>	.75 (19.1)	2.65 (67.3)	2.00 (50.8)
3	1 #10, 2 #12	2 feet	<a href="#">GL20G3P-M</a>	.75 (19.1)	2.65 (67.3)	2.00 (50.8)
4	1 #12, 3 #16	2 feet	<a href="#">GL20G4P-M</a>	.75 (19.1)	2.65 (67.3)	2.00 (50.8)
	1 #10, 3 #12	2 feet	<a href="#">GL20K4P-M</a>	1.06 (26.9)	3.25 (82.6)	2.62 (66.5)
5	1 #10, 4 #16	2 feet	<a href="#">GL20K5P-M</a>	1.06 (26.9)	3.25 (82.6)	2.62 (66.5)
6	1 #12, 5 #16	2 feet	<a href="#">GL20K6P-M</a>	1.06 (26.9)	3.25 (82.6)	2.62 (66.5)
8	1 #12, 7 #16	2 feet	<a href="#">GL20K8P-M</a>	1.06 (26.9)	3.25 (82.6)	2.62 (66.5)

\*For other lengths, add overall length in feet to the part number.  
Example: [GL20G1P-M-6](#) specifies a cable assembly 6 feet in length

### FEMALE CABLE ASSEMBLIES

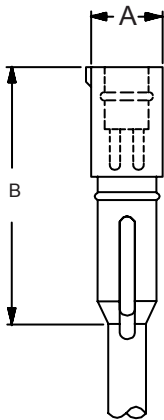

Number of Contacts	Contact Quantity/Size	Cable Length*	Part Number	A Dia	B
2	1 #10, 1#12	2 feet	<a href="#">GL20G2S-F</a>	.75 (19.1)	2.65 (67.3)
3	1 #10, 2 #12	2 feet	<a href="#">GL20G3S-F</a>	.75 (19.1)	2.65 (67.3)
4	1 #12, 3 #16	2 feet	<a href="#">GL20G4S-F</a>	.75 (19.1)	2.65 (67.3)
	1 #10, 3 #12	2 feet	<a href="#">GL20K4S-F</a>	1.06 (26.9)	3.50 (88.9)
5	1 #10, 4 #16	2 feet	<a href="#">GL20K5S-F</a>	1.06 (26.9)	3.50 (88.9)
6	1 #12, 5 #16	2 feet	<a href="#">GL20K6S-F</a>	1.06 (26.9)	3.50 (88.9)
8	1 #12, 7 #16	2 feet	<a href="#">GL20K8S-F</a>	1.06 (26.9)	3.50 (88.9)

\*For other lengths, add overall length in feet to the part number.  
Example: [GL20G1S-F-6](#) specifies a cable assembly 6 feet in length

### MALE BULKHEAD CONNECTORS

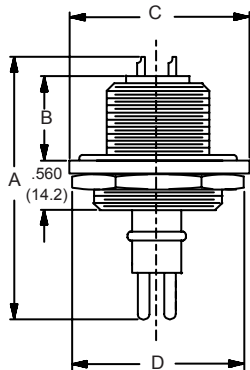



Number of Contacts	Contact Quantity/Size	Part Number	A	B	C Max	D Hex	E Thread
2	1 #10, 1#12	<a href="#">GL30G2P-BC</a>	2.625 (66.7)	.625 (15.9)	1.58 (40.1)	1.375 (34.9)	3/4 - 16
3	1 #10, 2 #12	<a href="#">GL30G3P-BC</a>	2.625 (66.7)	.625 (15.9)	1.58 (40.1)	1.375 (34.9)	3/4 - 16
4	1 #12, 3 #16	<a href="#">GL30G4P-BC</a>	2.625 (66.7)	.625 (15.9)	1.58 (40.1)	1.375 (34.9)	3/4 - 16
	1 #10, 3 #12	<a href="#">GL30K4P-BC</a>	3.625 (92.1)	1.375 (34.9)	1.89 (48.0)	1.625 (41.3)	1 - 14
5	1 #10, 4 #16	<a href="#">GL30K5P-BC</a>	3.625 (92.1)	1.375 (34.9)	1.89 (48.0)	1.625 (41.3)	1 - 14
6	1 #12, 5 #16	<a href="#">GL30K6P-BC</a>	3.625 (92.1)	1.375 (34.9)	1.89 (48.0)	1.625 (41.3)	1 - 14
8	1 #12, 7 #16	<a href="#">GL30K8P-BC</a>	3.625 (92.1)	1.375 (34.9)	1.89 (48.0)	1.625 (41.3)	1 - 14

## Specifications, contact arrangements and accessories

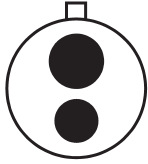
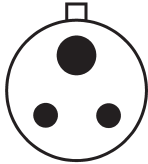

Male Bulkhead Connector

Specifications	
Contacts	Copper Alloy, Gold-Plated
O-Rings	Nitrile
Nut, Washer	Stainless Steel
Cable	Neoprene insulation, Stranded Copper Conductor
Bulkhead Connector Body	Glass-Filled Epoxy
Voltage Rating	600 VDC
Current Rating	See Contact Arrangements
Temperature Rating	-55°C to +105°C

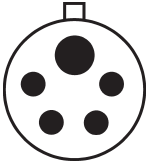
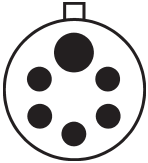
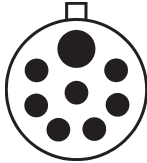
Contact Arrangements and Current Rating		
<b>2 contacts</b> 1 #10 Contact 1 #12 Contact 10 Amps <b>G2</b> 	<b>3 contacts</b> 1 #10 Contact 2 #12 Contact 10 Amps <b>G3</b> 	<b>4 contacts</b> 1 #12 Contact 3 #16 Contacts 7.5 Amps <b>G4</b> 
1 #10 Contact 3 #12 Contacts 7.5 Amps <b>K4</b> 	<b>5 contacts</b> 1 #10 Contact 4 #16 Contacts 7.5 Amps <b>K5</b> 	<b>6 contacts</b> 1 #10 Contact 5 #16 Contacts 7.5 Amps <b>K5</b> 
<b>8 contacts</b> 1 #10 Contact 7 #16 Contacts 6 Amps <b>K8</b> 		

### ACCESSORIES

#### Locking Sleeves

Locking Sleeves enable a mated pair of cable assemblies to be locked together, preventing accidental unmating. Material: Delrin.



Cable Part No.	Type	Sleeve Part No.
GL20G*P	Male	GL20G401
GL20K*P	Male	GL20K403
GL20G*S	Female	GL20G402
GL20K*S	Female	GL20K404

#### O-Rings

Replacement O-Rings for bulkhead connectors. Material: Nitrile

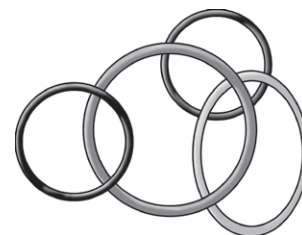

Cable Part No.	O-Ring
GL30G	2-213
GL30K	2-217